

Grooving tool holding block square 20x20, vertically adjustable

Technical data

| | |
|----------------------|--------------|
| Drive | not live |
| Mounting | Square 20x20 |
| reversible 180° | yes |
| X [mm] | 45 (1.77") |
| Y [mm] | – |
| Z [mm] | 28 (1.10) |
| INDEX TRAUB products | ABC • ABC.2 |

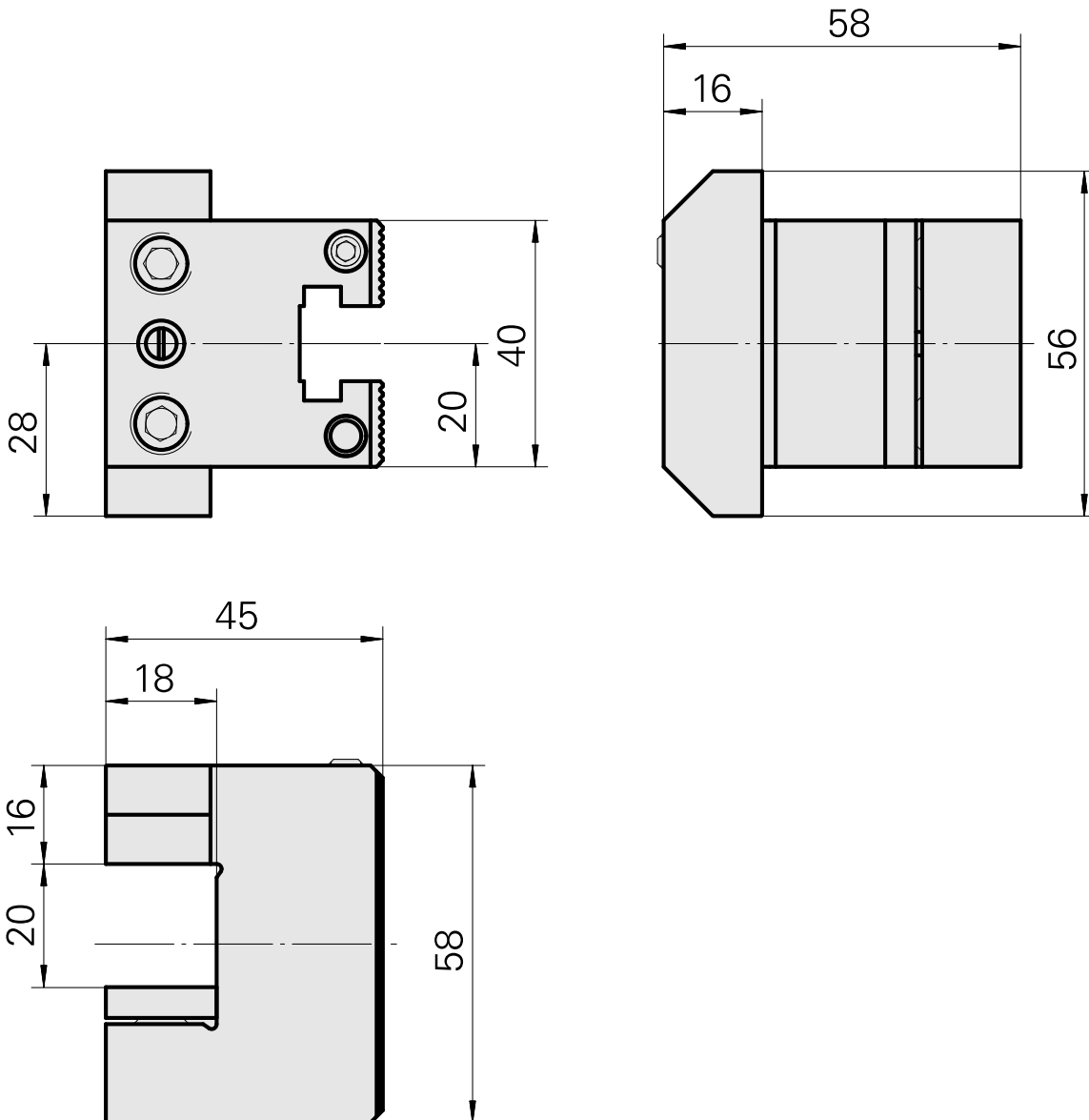
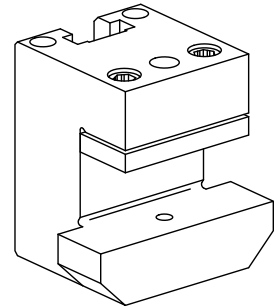

10976603
W9990246

INDEX

Documents

No downloads available for this product