

Back end unit A200 Quick-change insert D

Technical data

| | |
|-----------------------------|--------------------------------|
| Slide system MS | A200 |
| Drive | not live |
| Fixation MS | Splined key/pin |
| Cooling | external and internal |
| Pressure | extern. 40 bar, intern. 80 bar |
| Mounting | Quick-change insert D42, doub. |
| X [mm] | - |
| Y [mm] | - |
| Z [mm] | - |
| INDEX TRAUB products | A200-6 |

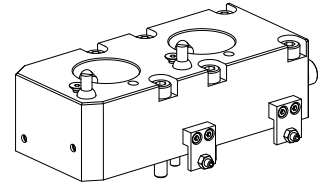

Note

When there is rear end machining with 3 fixed tool holders, mounting occurs in position 5.1!

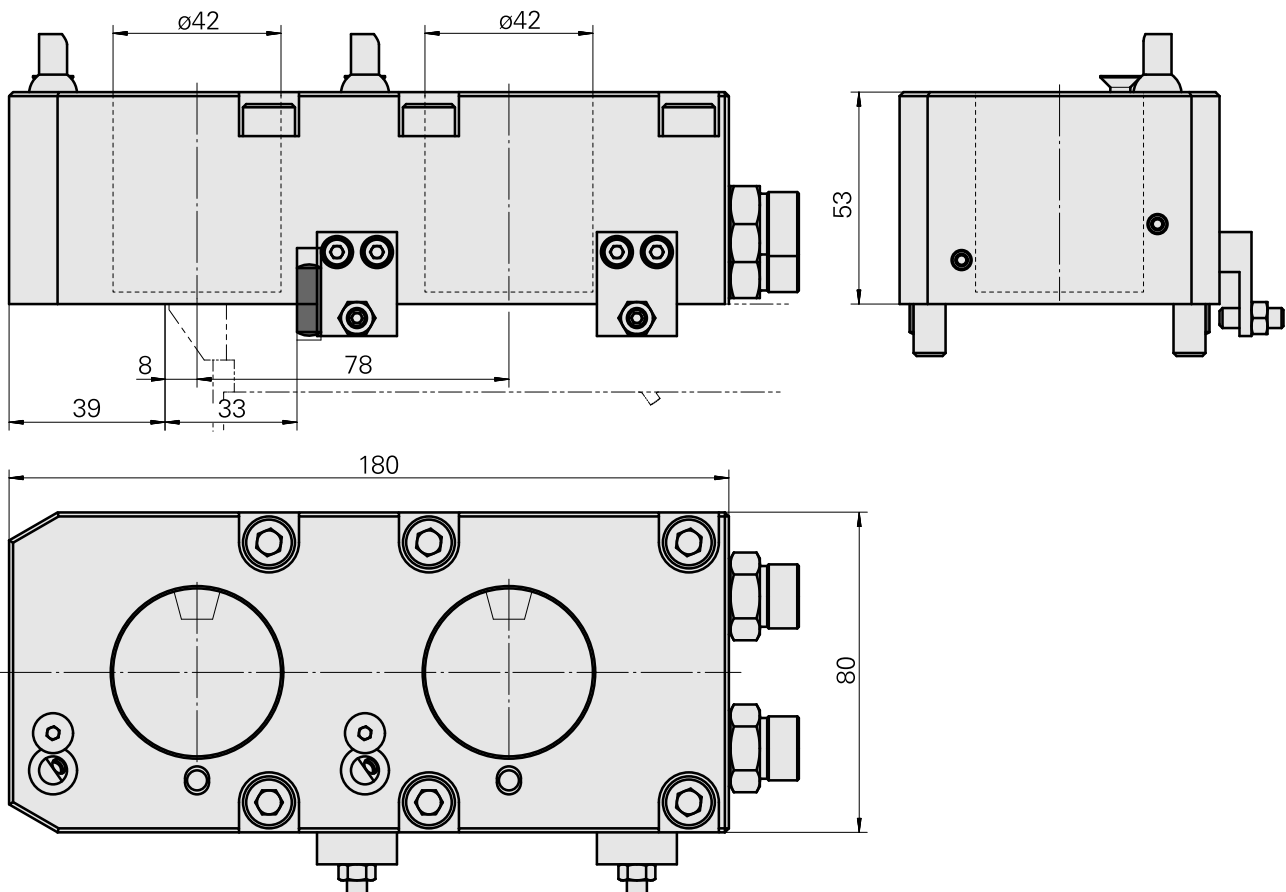

Documents

No downloads available for this product

Accessories

Optional accessories

MS tool holders

[Blanking plug](#)

Product ID : 10887763

Previous product ID : W9990311

| | | | |
|-------------------|--|----------------------|-------------|
| Drive not live | Fixation MS Shank D42 | X [mm] 16 (0.63") | Y [mm] - |
| Z [mm] - | INDEX TRAUB products MS52C • A200-6 • MS52-6.3 | | |

[Drill holding block D25](#)

Product ID : 10690799

Previous product ID : W9990313

| | | | |
|-------------------|--------------------------|--|----------------------|
| Drive not live | Fixation MS Shank D42 | Mounting D25 | X [mm] 18 (0.71") |
| Y [mm] - | Z [mm] - | INDEX TRAUB products MS52C • A200-6 • MS52-6.3 | |

[Drill holding block ER32](#)

Product ID : 10197173

Previous product ID : W9990312

| | | | |
|-------------------|--------------------------|--|----------------------|
| Drive not live | Fixation MS Shank D42 | Mounting ER32 | X [mm] 18 (0.71") |
| Y [mm] - | Z [mm] - | INDEX TRAUB products MS52C • A200-6 • MS52-6.3 | |

Other accessories

Lubrication pipe L=20

Product ID : 10510228
Previous product ID : M11451.40

Countersunk screw M 5x10/T25 verzinkt 402315 10

Product ID : 11038225
Previous product ID : 410362.0510

Grub screw

Product ID : 10749622
Previous product ID : 410191.1210
