

## Grooving tool holding block Square 16x16, vertically adjustable

### Technical data

|                             |   |
|-----------------------------|---|
| <b>Drive</b>                | not live  |
| <b>Mounting</b>             | Square 16x16  |
| <b>X [mm]</b>               | 20 (0.79")  |
| <b>Y [mm]</b>               | –   |
| <b>Z [mm]</b>               | 17 (0.67)   |
| <b>INDEX TRAUB products</b> | C42/65 • G160 • G300 • ABC<br>• B400 • C100 • C200 • G200 •<br>G200.2 • G220 • G250 • TNX65/42<br>• TNA400.2 • ABC.2 • G300.2 •<br>G320.2 • B400.3 • TNA400.3 •<br>G320.3 compact |

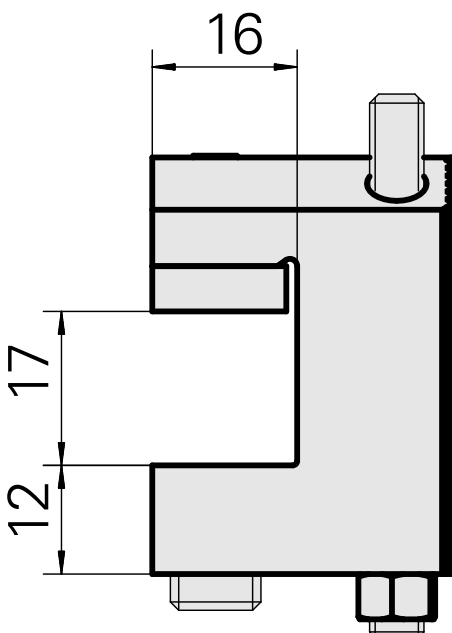
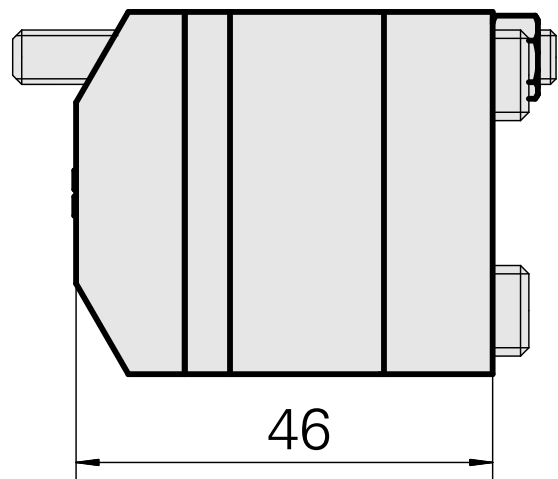
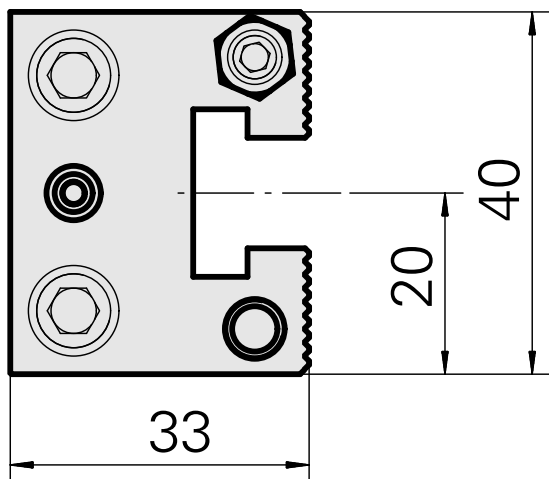
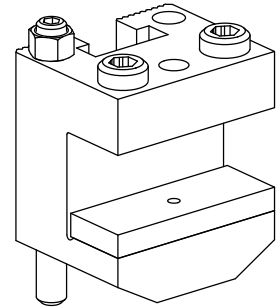

## **Documents**

No downloads available for this product