

## Drilling tool holder VDI 30 DIN 1835 B/E, Form E1

### Technical data

<b>Shank VDI</b>	VDI 30
<b>Drive</b>	not live
<b>Fixation VDI</b>	none
<b>Cooling</b>	internal
<b>Pressure</b>	80 bar
<b>Mounting</b>	DIN 1835 B/E D20
<b>reversible 180°</b>	no
<b>Data carrier</b>	check tool station bore
<b>X [mm]</b>	67 (2.64")
<b>Y [mm]</b>	-
<b>Z [mm]</b>	-
<b>INDEX TRAUB products</b>	TNA300

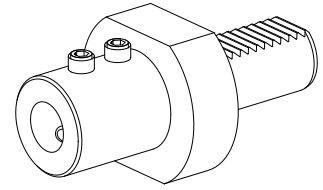

## **Documents**

No downloads available for this product