

## Drilling tool holder VDI 40 D40, Form E2

### Technical data

Shank VDI	VDI 40
Drive	not live
Fixation VDI	none
Cooling	external
Pressure	20 bar
Mounting	D40
reversible 180°	no
X [mm]	85 (3.35")
Y [mm]	—
Z [mm]	—
INDEX TRAUB products	V200 • TNA400.3 • B400.3 • B500.3 • TNA500.3 • V300 • TNA400 • B400 • B500 • TNA500.2 • TNA400.2

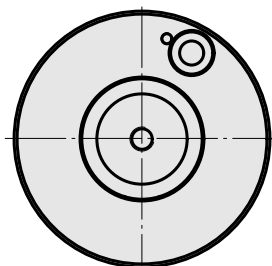
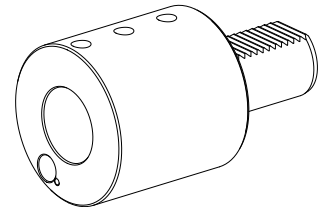

---

## Documents

No downloads available for this product

## Accessories

### Optional accessories

#### Other accessories

#### [Mounting sleeve D40 2x holes](#)

Product ID : 10159790

Previous product ID : W64220.02--

---

#### [Mounting sleeve with collar D40](#)

Product ID : 10480161

Previous product ID : W64222.41--

---

#### [Mounting sleeve D40 3x holes](#)

Product ID : 10789882

Previous product ID : W64221.14--

---

#### [SPRAY NOZZLE 14D/M6](#)

Product ID : 10358770

Previous product ID : 474550.0121

---

#### [Lens head screw](#)

Product ID : 10344546

Previous product ID : 410243.0406

---