

## Turning tool holder VDI 20 square 16x16, double

### Technical data

|                      |              |
|----------------------|--------------|
| Shank VDI            | VDI 20       |
| Drive                | not live     |
| Fixation VDI         | W serration  |
| Cooling              | external     |
| Pressure             | 20 bar       |
| Mounting             | Square 16x16 |
| reversible 180°      | no           |
| X [mm]               | 50 (1.97")   |
| Y [mm]               | -            |
| Z [mm]               | ±33 (±1.30)  |
| INDEX TRAUB products | C100         |

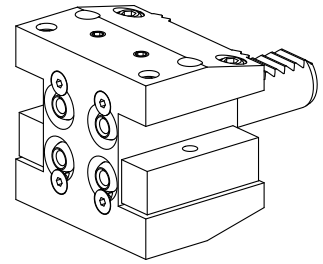

## Documents

No downloads available for this product

## Accessories

Optional accessories

### Other accessories

#### [Seal](#)

Product ID : 10478680

Previous product ID : W67221.4196

---

#### [Coolant Nozzle](#)

Product ID : 11031912

Previous product ID : W67500.3208

---

#### [Countersunk screw M 4x 8/T20 verzinkt 402314 8](#)

Product ID : 10586100

Previous product ID : 410362.0408

---

#### [Nozzle M6 mit D1,6](#)

Product ID : 10147428

Previous product ID : W00019.0216

---