

Grooving tool holding block Trapezoid 32, vertically adjustable

Technical data

| | |
|----------------------|--|
| Drive | not live |
| Cooling | external and internal |
| Pressure | 80 bar |
| Mounting | Trapezoid 32x4 |
| reversible 180° | no |
| X [mm] | 87.5 (3.44") |
| Y [mm] | — |
| Z [mm] | 15 (0.59) |
| INDEX TRAUB products | B400 • TNA400.2 • B500 • TNA500.2 • G420 • G400.2 • G500 • G520 • G300.2 • G320.2 • B400.3 • B500.3 • TNA400.3 • TNA500.3 • G320.3 compact |

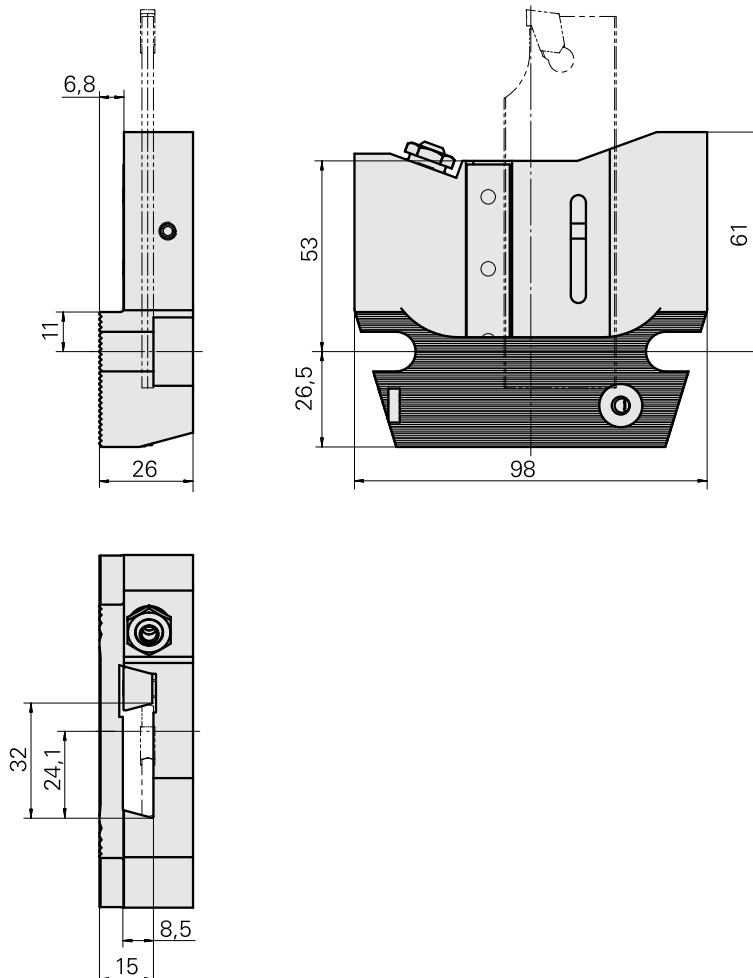
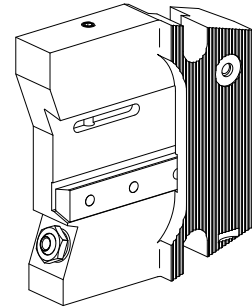

Documents

No downloads available for this product