

## Chuck

### Technical data

<b>INDEX TRAUB products</b>	C200 • R200 • ABC • TNK42/65 • ABC.2
<b>Spindle clearance</b>	65mm
<b>Machining side</b>	Counter spindle
<b>Ext. manufact. product feature</b>	Modular
<b>manufacturer product line</b>	TOPlus chuck
<b>Spindle mounting</b>	AP140
<b>Clamping device size</b>	SK65
<b>manufacturer product line</b>	Hainbuch

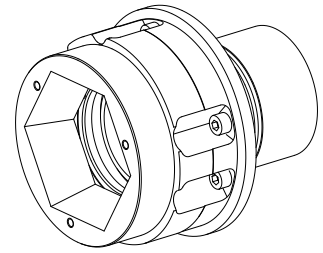

No 3-side view is currently available for this product

## Documents

No downloads available for this product

## Accessories

### Optional accessories

#### Other accessories

#### [Clamping head TOP65 D=5,00mm](#)

Product ID : 10060347

Previous product ID : 900565.R050

Clamping device size SK65	manufacturer product line TOPlus chuck	Clamping type grooved	Nominal diameter (mm) 5 Millimeter
Clamping method External clamping	manufacturer product line Hainbuch		

#### [Clamping head TOP65 D=6,00mm](#)

Product ID : 10912119

Previous product ID : 900565.R060

Clamping device size SK65	manufacturer product line TOPlus chuck	Clamping type grooved	Nominal diameter (mm) 6 Millimeter
Clamping method External clamping	manufacturer product line Hainbuch		

#### [Clamping head TOP65 D=7,00mm](#)

Product ID : 10379194

Previous product ID : 900565.R070

Clamping device size SK65	manufacturer product line TOPlus chuck	Clamping type grooved	Nominal diameter (mm) 7 Millimeter
Clamping method External clamping	manufacturer product line Hainbuch		

### Clamping head TOP65 D=8,00mm

Product ID : 10390927

Previous product ID : 900565.R080

Clamping device size <b>SK65</b>	manufacturer product line <b>TOPlus chuck</b>	Clamping type <b>grooved</b>	Nominal diameter (mm) <b>8 Millimeter</b>
Clamping method <b>External clamping</b>	manufacturer product line <b>Hainbuch</b>		

### Clamping head TOP65 D=9,00mm

Product ID : 11020883

Previous product ID : 900565.R090

Clamping device size <b>SK65</b>	manufacturer product line <b>TOPlus chuck</b>	Clamping type <b>grooved</b>	Nominal diameter (mm) <b>9 Millimeter</b>
Clamping method <b>External clamping</b>	manufacturer product line <b>Hainbuch</b>		

### Clamping head TOP65 D=10,00mm

Product ID : 10620887

Previous product ID : 900565.R100

Clamping device size <b>SK65</b>	manufacturer product line <b>TOPlus chuck</b>	Clamping type <b>grooved</b>	Nominal diameter (mm) <b>10 Millimeter</b>
Clamping method <b>External clamping</b>	manufacturer product line <b>Hainbuch</b>		

### Clamping head TOP65 D=11,00mm

Product ID : 10426765

Previous product ID : 900565.R110

Clamping device size <b>SK65</b>	manufacturer product line <b>TOPlus chuck</b>	Clamping type <b>grooved</b>	Nominal diameter (mm) <b>11 Millimeter</b>
Clamping method <b>External clamping</b>	manufacturer product line <b>Hainbuch</b>		

### Clamping head TOP65 D=12,00mm

Product ID : 10770041

Previous product ID : 900565.R120

Clamping device size <b>SK65</b>	manufacturer product line <b>TOPlus chuck</b>	Clamping type <b>grooved</b>	Nominal diameter (mm) <b>12 Millimeter</b>
Clamping method <b>External clamping</b>	manufacturer product line <b>Hainbuch</b>		

### Clamping head TOP65 D=13,00mm

Product ID : 10233324

Previous product ID : 900565.R130

Clamping device size <b>SK65</b>	manufacturer product line <b>TOPlus chuck</b>	Clamping type <b>grooved</b>	Nominal diameter (mm) <b>13 Millimeter</b>
Clamping method <b>External clamping</b>	manufacturer product line <b>Hainbuch</b>		

### Clamping head TOP65 D=14,00mm

Product ID : 10381736

Previous product ID : 900565.R140

Clamping device size <b>SK65</b>	manufacturer product line <b>TOPlus chuck</b>	Clamping type <b>grooved</b>	Nominal diameter (mm) <b>14 Millimeter</b>
Clamping method <b>External clamping</b>	manufacturer product line <b>Hainbuch</b>		

### Clamping head TOP65 D=15,00mm

Product ID : 10565124

Previous product ID : 900565.R150

Clamping device size <b>SK65</b>	manufacturer product line <b>TOPlus chuck</b>	Clamping type <b>grooved</b>	Nominal diameter (mm) <b>15 Millimeter</b>
Clamping method <b>External clamping</b>	manufacturer product line <b>Hainbuch</b>		

### Clamping head TOP65 D=16,00mm

Product ID : 10490132

Previous product ID : 900565.R160

Clamping device size <b>SK65</b>	manufacturer product line <b>TOPlus chuck</b>	Clamping type <b>grooved</b>	Nominal diameter (mm) <b>16 Millimeter</b>
Clamping method <b>External clamping</b>	manufacturer product line <b>Hainbuch</b>		

### Clamping head TOP65 D=17,00mm

Product ID : 11012494

Previous product ID : 900565.R170

Clamping device size <b>SK65</b>	manufacturer product line <b>TOPlus chuck</b>	Clamping type <b>grooved</b>	Nominal diameter (mm) <b>17 Millimeter</b>
Clamping method <b>External clamping</b>	manufacturer product line <b>Hainbuch</b>		

### Clamping head TOP65 D=18,00mm

Product ID : 10159550

Previous product ID : 900565.R180

Clamping device size <b>SK65</b>	manufacturer product line <b>TOPlus chuck</b>	Clamping type <b>grooved</b>	Nominal diameter (mm) <b>18 Millimeter</b>
Clamping method <b>External clamping</b>	manufacturer product line <b>Hainbuch</b>		

### Clamping head TOP65 D=19,00mm

Product ID : 11030824

Previous product ID : 900565.R190

Clamping device size <b>SK65</b>	manufacturer product line <b>TOPlus chuck</b>	Clamping type <b>grooved</b>	Nominal diameter (mm) <b>19 Millimeter</b>
Clamping method <b>External clamping</b>	manufacturer product line <b>Hainbuch</b>		

### Clamping head TOP65 D=20,00mm

Product ID : 10262515

Previous product ID : 900565.R200

Clamping device size SK65	manufacturer product line TOPlus chuck	Clamping type grooved	Nominal diameter (mm) 20 Millimeter
Clamping method External clamping	manufacturer product line Hainbuch		

### Clamping head TOP65 D=21,00mm

Product ID : 10122419

Previous product ID : 900565.R210

Clamping device size SK65	manufacturer product line TOPlus chuck	Clamping type grooved	Nominal diameter (mm) 21 Millimeter
Clamping method External clamping	manufacturer product line Hainbuch		

### Clamping head TOP65 D=22,00mm

Product ID : 10937055

Previous product ID : 900565.R220

Clamping device size SK65	manufacturer product line TOPlus chuck	Clamping type grooved	Nominal diameter (mm) 22 Millimeter
Clamping method External clamping	manufacturer product line Hainbuch		

### Clamping head TOP65 D=23,00mm

Product ID : 10035683

Previous product ID : 900565.R230

Clamping device size SK65	manufacturer product line TOPlus chuck	Clamping type grooved	Nominal diameter (mm) 23 Millimeter
Clamping method External clamping	manufacturer product line Hainbuch		

### Clamping head TOP65 D=24,00mm

Product ID : 10870713

Previous product ID : 900565.R240

Clamping device size <b>SK65</b>	manufacturer product line <b>TOPlus chuck</b>	Clamping type <b>grooved</b>	Nominal diameter (mm) <b>24 Millimeter</b>
Clamping method <b>External clamping</b>	manufacturer product line <b>Hainbuch</b>		

### Clamping head TOP65 D=25,00mm

Product ID : 10818470

Previous product ID : 900565.R250

Clamping device size <b>SK65</b>	manufacturer product line <b>TOPlus chuck</b>	Clamping type <b>grooved</b>	Nominal diameter (mm) <b>25 Millimeter</b>
Clamping method <b>External clamping</b>	manufacturer product line <b>Hainbuch</b>		

### Clamping head TOP65 D=26,00mm

Product ID : 11023414

Previous product ID : 900565.R260

Clamping device size <b>SK65</b>	manufacturer product line <b>TOPlus chuck</b>	Clamping type <b>grooved</b>	Nominal diameter (mm) <b>26 Millimeter</b>
Clamping method <b>External clamping</b>	manufacturer product line <b>Hainbuch</b>		

### Clamping head TOP65 D=27,00mm

Product ID : 10198813

Previous product ID : 900565.R270

Clamping device size <b>SK65</b>	manufacturer product line <b>TOPlus chuck</b>	Clamping type <b>grooved</b>	Nominal diameter (mm) <b>27 Millimeter</b>
Clamping method <b>External clamping</b>	manufacturer product line <b>Hainbuch</b>		

### Clamping head TOP65 D=28,00mm

Product ID : 11054390

Previous product ID : 900565.R280

Clamping device size SK65	manufacturer product line TOPlus chuck	Clamping type grooved	Nominal diameter (mm) 28 Millimeter
Clamping method External clamping	manufacturer product line Hainbuch		

### Clamping head TOP65 D=29,00mm

Product ID : 10568257

Previous product ID : 900565.R290

Clamping device size SK65	manufacturer product line TOPlus chuck	Clamping type grooved	Nominal diameter (mm) 29 Millimeter
Clamping method External clamping	manufacturer product line Hainbuch		

### Clamping head TOP65 D=30,00mm

Product ID : 10166609

Previous product ID : 900565.R300

Clamping device size SK65	manufacturer product line TOPlus chuck	Clamping type grooved	Nominal diameter (mm) 30 Millimeter
Clamping method External clamping	manufacturer product line Hainbuch		

### Clamping head TOP65 D=31,00mm

Product ID : 10364473

Previous product ID : 900565.R310

Clamping device size SK65	manufacturer product line TOPlus chuck	Clamping type grooved	Nominal diameter (mm) 31 Millimeter
Clamping method External clamping	manufacturer product line Hainbuch		

### Clamping head TOP65 D=32,00mm

Product ID : 10700044

Previous product ID : 900565.R320

Clamping device size SK65	manufacturer product line TOPlus chuck	Clamping type grooved	Nominal diameter (mm) 32 Millimeter
Clamping method External clamping	manufacturer product line Hainbuch		

### Clamping head TOP65 D=33,00mm

Product ID : 10525637

Previous product ID : 900565.R330

Clamping device size SK65	manufacturer product line TOPlus chuck	Clamping type grooved	Nominal diameter (mm) 33 Millimeter
Clamping method External clamping	manufacturer product line Hainbuch		

### Clamping head TOP65 D=34,00mm

Product ID : 10830038

Previous product ID : 900565.R340

Clamping device size SK65	manufacturer product line TOPlus chuck	Clamping type grooved	Nominal diameter (mm) 34 Millimeter
Clamping method External clamping	manufacturer product line Hainbuch		

### Clamping head TOP65 D=35,00mm

Product ID : 10185407

Previous product ID : 900565.R350

Clamping device size SK65	manufacturer product line TOPlus chuck	Clamping type grooved	Nominal diameter (mm) 35 Millimeter
Clamping method External clamping	manufacturer product line Hainbuch		

### Clamping head TOP65 D=36,00mm

Product ID : 10012095

Previous product ID : 900565.R360

Clamping device size <b>SK65</b>	manufacturer product line <b>TOPlus chuck</b>	Clamping type <b>grooved</b>	Nominal diameter (mm) <b>36 Millimeter</b>
Clamping method <b>External clamping</b>	manufacturer product line <b>Hainbuch</b>		

### Clamping head TOP65 D=37,00mm

Product ID : 10692144

Previous product ID : 900565.R370

Clamping device size <b>SK65</b>	manufacturer product line <b>TOPlus chuck</b>	Clamping type <b>grooved</b>	Nominal diameter (mm) <b>37 Millimeter</b>
Clamping method <b>External clamping</b>	manufacturer product line <b>Hainbuch</b>		

### Clamping head TOP65 D=38,00mm

Product ID : 10006264

Previous product ID : 900565.R380

Clamping device size <b>SK65</b>	manufacturer product line <b>TOPlus chuck</b>	Clamping type <b>grooved</b>	Nominal diameter (mm) <b>38 Millimeter</b>
Clamping method <b>External clamping</b>	manufacturer product line <b>Hainbuch</b>		

### Clamping head TOP65 D=39,00mm

Product ID : 10590728

Previous product ID : 900565.R390

Clamping device size <b>SK65</b>	manufacturer product line <b>TOPlus chuck</b>	Clamping type <b>grooved</b>	Nominal diameter (mm) <b>39 Millimeter</b>
Clamping method <b>External clamping</b>	manufacturer product line <b>Hainbuch</b>		

### Clamping head TOP65 D=40,00mm

Product ID : 10635627

Previous product ID : 900565.R400

Clamping device size SK65	manufacturer product line TOPlus chuck	Clamping type grooved	Nominal diameter (mm) 40 Millimeter
Clamping method External clamping	manufacturer product line Hainbuch		

### Clamping head TOP65 D=41,00mm

Product ID : 10983711

Previous product ID : 900565.R410

Clamping device size SK65	manufacturer product line TOPlus chuck	Clamping type grooved	Nominal diameter (mm) 41 Millimeter
Clamping method External clamping	manufacturer product line Hainbuch		

### Clamping head TOP65 D=42,00mm

Product ID : 10739993

Previous product ID : 900565.R420

Clamping device size SK65	manufacturer product line TOPlus chuck	Clamping type grooved	Nominal diameter (mm) 42 Millimeter
Clamping method External clamping	manufacturer product line Hainbuch		

### Clamping head TOP65 D=43,00mm

Product ID : 10371260

Previous product ID : 900565.R430

Clamping device size SK65	manufacturer product line TOPlus chuck	Clamping type grooved	Nominal diameter (mm) 43 Millimeter
Clamping method External clamping	manufacturer product line Hainbuch		

### Clamping head TOP65 D=44,00mm

Product ID : 10060891

Previous product ID : 900565.R440

Clamping device size SK65	manufacturer product line TOPlus chuck	Clamping type grooved	Nominal diameter (mm) 44 Millimeter
Clamping method External clamping	manufacturer product line Hainbuch		

### Clamping head TOP65 D=45,00mm

Product ID : 10413148

Previous product ID : 900565.R450

Clamping device size SK65	manufacturer product line TOPlus chuck	Clamping type grooved	Nominal diameter (mm) 45 Millimeter
Clamping method External clamping	manufacturer product line Hainbuch		

### Clamping head TOP65 D=46,00mm

Product ID : 10025625

Previous product ID : 900565.R460

Clamping device size SK65	manufacturer product line TOPlus chuck	Clamping type grooved	Nominal diameter (mm) 46 Millimeter
Clamping method External clamping	manufacturer product line Hainbuch		

### Clamping head TOP65 D=47,00mm

Product ID : 10123645

Previous product ID : 900565.R470

Clamping device size SK65	manufacturer product line TOPlus chuck	Clamping type grooved	Nominal diameter (mm) 47 Millimeter
Clamping method External clamping	manufacturer product line Hainbuch		

### Clamping head TOP65 D=48,00mm

Product ID : 10622730

Previous product ID : 900565.R480

Clamping device size SK65	manufacturer product line TOPlus chuck	Clamping type grooved	Nominal diameter (mm) 48 Millimeter
Clamping method External clamping	manufacturer product line Hainbuch		

### Clamping head TOP65 D=49,00mm

Product ID : 10644964

Previous product ID : 900565.R490

Clamping device size SK65	manufacturer product line TOPlus chuck	Clamping type grooved	Nominal diameter (mm) 49 Millimeter
Clamping method External clamping	manufacturer product line Hainbuch		

### Clamping head TOP65 D=50,00mm

Product ID : 10589962

Previous product ID : 900565.R500

Clamping device size SK65	manufacturer product line TOPlus chuck	Clamping type grooved	Nominal diameter (mm) 50 Millimeter
Clamping method External clamping	manufacturer product line Hainbuch		

### Clamping head TOP65 D=51,00mm

Product ID : 10952620

Previous product ID : 900565.R510

Clamping device size SK65	manufacturer product line TOPlus chuck	Clamping type grooved	Nominal diameter (mm) 51 Millimeter
Clamping method External clamping	manufacturer product line Hainbuch		

### Clamping head TOP65 D=52,00mm

Product ID : 10756334

Previous product ID : 900565.R520

Clamping device size SK65	manufacturer product line TOPlus chuck	Clamping type grooved	Nominal diameter (mm) 52 Millimeter
Clamping method External clamping	manufacturer product line Hainbuch		

### Clamping head TOP65 D=53,00mm

Product ID : 10156585

Previous product ID : 900565.R530

Clamping device size SK65	manufacturer product line TOPlus chuck	Clamping type grooved	Nominal diameter (mm) 53 Millimeter
Clamping method External clamping	manufacturer product line Hainbuch		

### Clamping head TOP65 D=54,00mm

Product ID : 10452755

Previous product ID : 900565.R540

Clamping device size SK65	manufacturer product line TOPlus chuck	Clamping type grooved	Nominal diameter (mm) 54 Millimeter
Clamping method External clamping	manufacturer product line Hainbuch		

### Clamping head TOP65 D=55,00mm

Product ID : 10166680

Previous product ID : 900565.R550

Clamping device size SK65	manufacturer product line TOPlus chuck	Clamping type grooved	Nominal diameter (mm) 55 Millimeter
Clamping method External clamping	manufacturer product line Hainbuch		

### Clamping head TOP65 D=56,00mm

Product ID : 10265563

Previous product ID : 900565.R560

Clamping device size SK65	manufacturer product line TOPlus chuck	Clamping type grooved	Nominal diameter (mm) 56 Millimeter
Clamping method External clamping	manufacturer product line Hainbuch		

### Clamping head TOP65 D=57,00mm

Product ID : 10558562

Previous product ID : 900565.R570

Clamping device size SK65	manufacturer product line TOPlus chuck	Clamping type grooved	Nominal diameter (mm) 57 Millimeter
Clamping method External clamping	manufacturer product line Hainbuch		

### Clamping head TOP65 D=58,00mm

Product ID : 10784846

Previous product ID : 900565.R580

Clamping device size SK65	manufacturer product line TOPlus chuck	Clamping type grooved	Nominal diameter (mm) 58 Millimeter
Clamping method External clamping	manufacturer product line Hainbuch		

### Clamping head TOP65 D=59,00mm

Product ID : 11058674

Previous product ID : 900565.R590

Clamping device size SK65	manufacturer product line TOPlus chuck	Clamping type grooved	Nominal diameter (mm) 59 Millimeter
Clamping method External clamping	manufacturer product line Hainbuch		

### Clamping head TOP65 D=60,00mm

Product ID : 10628492

Previous product ID : 900565.R600

Clamping device size SK65	manufacturer product line TOPlus chuck	Clamping type grooved	Nominal diameter (mm) 60 Millimeter
Clamping method External clamping	manufacturer product line Hainbuch		

### Clamping head TOP65 D=61,00mm

Product ID : 10001489

Previous product ID : 900565.R610

Clamping device size SK65	manufacturer product line TOPlus chuck	Clamping type grooved	Nominal diameter (mm) 61 Millimeter
Clamping method External clamping	manufacturer product line Hainbuch		

### Clamping head TOP65 D=62,00mm

Product ID : 10744844

Previous product ID : 900565.R620

Clamping device size SK65	manufacturer product line TOPlus chuck	Clamping type grooved	Nominal diameter (mm) 62 Millimeter
Clamping method External clamping	manufacturer product line Hainbuch		

### Clamping head TOP65 D=63,00mm

Product ID : 10013281

Previous product ID : 900565.R630

Clamping device size SK65	manufacturer product line TOPlus chuck	Clamping type grooved	Nominal diameter (mm) 63 Millimeter
Clamping method External clamping	manufacturer product line Hainbuch		

### Clamping head TOP65 D=64,00mm

Product ID : 10468856

Previous product ID : 900565.R640

Clamping device size <b>SK65</b>	manufacturer product line <b>TOPlus chuck</b>	Clamping type <b>grooved</b>	Nominal diameter (mm) <b>64 Millimeter</b>
Clamping method <b>External clamping</b>	manufacturer product line <b>Hainbuch</b>		

### Clamping head TOP65 D=65,00mm

Product ID : 10372670

Previous product ID : 900565.R650

Clamping device size <b>SK65</b>	manufacturer product line <b>TOPlus chuck</b>	Clamping type <b>grooved</b>	Nominal diameter (mm) <b>65 Millimeter</b>
Clamping method <b>External clamping</b>	manufacturer product line <b>Hainbuch</b>		

### Clamping head TOP65 G D=5,00mm

Product ID : 10542192

Previous product ID : 900565.G050

Clamping device size <b>SK65</b>	manufacturer product line <b>TOPlus chuck</b>	Clamping type <b>smooth</b>	Nominal diameter (mm) <b>5 Millimeter</b>
Clamping method <b>External clamping</b>	manufacturer product line <b>Hainbuch</b>		

### Clamping head TOP65 G D=5,00mm

Product ID : 10974591

Previous product ID : 900565.G060

Clamping device size <b>SK65</b>	manufacturer product line <b>TOPlus chuck</b>	Clamping type <b>smooth</b>	Nominal diameter (mm) <b>6 Millimeter</b>
Clamping method <b>External clamping</b>	manufacturer product line <b>Hainbuch</b>		

### Clamping head TOP65 G D=7,00mm

Product ID : 10015322

Previous product ID : 900565.G070

Clamping device size SK65	manufacturer product line TOPlus chuck	Clamping type smooth	Nominal diameter (mm) 7 Millimeter
Clamping method External clamping	manufacturer product line Hainbuch		

### Clamping head TOP65 G D=8,00mm

Product ID : 10190456

Previous product ID : 900565.G080

Clamping device size SK65	manufacturer product line TOPlus chuck	Clamping type smooth	Nominal diameter (mm) 8 Millimeter
Clamping method External clamping	manufacturer product line Hainbuch		

### Clamping head TOP65 G D=9,00mm

Product ID : 10191300

Previous product ID : 900565.G090

Clamping device size SK65	manufacturer product line TOPlus chuck	Clamping type smooth	Nominal diameter (mm) 9 Millimeter
Clamping method External clamping	manufacturer product line Hainbuch		

### Clamping head TOP65 G D=10,00mm

Product ID : 10224878

Previous product ID : 900565.G100

Clamping device size SK65	manufacturer product line TOPlus chuck	Clamping type smooth	Nominal diameter (mm) 10 Millimeter
Clamping method External clamping	manufacturer product line Hainbuch		

### Clamping head TOP65 G D=11,00mm

Product ID : 11077424

Previous product ID : 900565.G110

Clamping device size <b>SK65</b>	manufacturer product line <b>TOPlus chuck</b>	Clamping type <b>smooth</b>	Nominal diameter (mm) <b>11 Millimeter</b>
Clamping method <b>External clamping</b>	manufacturer product line <b>Hainbuch</b>		

### Clamping head TOP65 G D=12,00mm

Product ID : 10661028

Previous product ID : 900565.G120

Clamping device size <b>SK65</b>	manufacturer product line <b>TOPlus chuck</b>	Clamping type <b>smooth</b>	Nominal diameter (mm) <b>12 Millimeter</b>
Clamping method <b>External clamping</b>	manufacturer product line <b>Hainbuch</b>		

### Clamping head TOP65 G D=13,00mm

Product ID : 10866644

Previous product ID : 900565.G130

Clamping device size <b>SK65</b>	manufacturer product line <b>TOPlus chuck</b>	Clamping type <b>smooth</b>	Nominal diameter (mm) <b>13 Millimeter</b>
Clamping method <b>External clamping</b>	manufacturer product line <b>Hainbuch</b>		

### Clamping head TOP65 G D=14,00mm

Product ID : 10085252

Previous product ID : 900565.G140

Clamping device size <b>SK65</b>	manufacturer product line <b>TOPlus chuck</b>	Clamping type <b>smooth</b>	Nominal diameter (mm) <b>14 Millimeter</b>
Clamping method <b>External clamping</b>	manufacturer product line <b>Hainbuch</b>		

### Clamping head TOP65 G D=15,00mm

Product ID : 10387910

Previous product ID : 900565.G150

Clamping device size <b>SK65</b>	manufacturer product line <b>TOPlus chuck</b>	Clamping type <b>smooth</b>	Nominal diameter (mm) <b>15 Millimeter</b>
Clamping method <b>External clamping</b>	manufacturer product line <b>Hainbuch</b>		

### Clamping head TOP65 G D=16,00mm

Product ID : 10216820

Previous product ID : 900565.G160

Clamping device size <b>SK65</b>	manufacturer product line <b>TOPlus chuck</b>	Clamping type <b>smooth</b>	Nominal diameter (mm) <b>16 Millimeter</b>
Clamping method <b>External clamping</b>	manufacturer product line <b>Hainbuch</b>		

### Clamping head TOP65 G D=17,00mm

Product ID : 10030557

Previous product ID : 900565.G170

Clamping device size <b>SK65</b>	manufacturer product line <b>TOPlus chuck</b>	Clamping type <b>smooth</b>	Nominal diameter (mm) <b>17 Millimeter</b>
Clamping method <b>External clamping</b>	manufacturer product line <b>Hainbuch</b>		

### Clamping head TOP65 G D=18,00mm

Product ID : 10376222

Previous product ID : 900565.G180

Clamping device size <b>SK65</b>	manufacturer product line <b>TOPlus chuck</b>	Clamping type <b>smooth</b>	Nominal diameter (mm) <b>18 Millimeter</b>
Clamping method <b>External clamping</b>	manufacturer product line <b>Hainbuch</b>		

### Clamping head TOP65 G D=19,00mm

Product ID : 10245914

Previous product ID : 900565.G190

Clamping device size SK65	manufacturer product line TOPlus chuck	Clamping type smooth	Nominal diameter (mm) 19 Millimeter
Clamping method External clamping	manufacturer product line Hainbuch		

### Clamping head TOP65 G D=20,00mm

Product ID : 10817939

Previous product ID : 900565.G200

Clamping device size SK65	manufacturer product line TOPlus chuck	Clamping type smooth	Nominal diameter (mm) 20 Millimeter
Clamping method External clamping	manufacturer product line Hainbuch		

### Clamping head TOP65 G D=21,00mm

Product ID : 10453824

Previous product ID : 900565.G210

Clamping device size SK65	manufacturer product line TOPlus chuck	Clamping type smooth	Nominal diameter (mm) 21 Millimeter
Clamping method External clamping	manufacturer product line Hainbuch		

### Clamping head TOP65 G D=22,00mm

Product ID : 10755980

Previous product ID : 900565.G220

Clamping device size SK65	manufacturer product line TOPlus chuck	Clamping type smooth	Nominal diameter (mm) 22 Millimeter
Clamping method External clamping	manufacturer product line Hainbuch		

### Clamping head TOP65 G D=23,00mm

Product ID : 10365612

Previous product ID : 900565.G230

Clamping device size SK65	manufacturer product line TOPlus chuck	Clamping type smooth	Nominal diameter (mm) 23 Millimeter
Clamping method External clamping	manufacturer product line Hainbuch		

### Clamping head TOP65 G D=24,00mm

Product ID : 10875901

Previous product ID : 900565.G240

Clamping device size SK65	manufacturer product line TOPlus chuck	Clamping type smooth	Nominal diameter (mm) 24 Millimeter
Clamping method External clamping	manufacturer product line Hainbuch		

### Clamping head TOP65 G D=25,00mm

Product ID : 10649880

Previous product ID : 900565.G250

Clamping device size SK65	manufacturer product line TOPlus chuck	Clamping type smooth	Nominal diameter (mm) 25 Millimeter
Clamping method External clamping	manufacturer product line Hainbuch		

### Clamping head TOP65 G D=26,00mm

Product ID : 10924313

Previous product ID : 900565.G260

Clamping device size SK65	manufacturer product line TOPlus chuck	Clamping type smooth	Nominal diameter (mm) 26 Millimeter
Clamping method External clamping	manufacturer product line Hainbuch		

### Clamping head TOP65 G D=27,00mm

Product ID : 10351148

Previous product ID : 900565.G270

Clamping device size <b>SK65</b>	manufacturer product line <b>TOPlus chuck</b>	Clamping type <b>smooth</b>	Nominal diameter (mm) <b>27 Millimeter</b>
Clamping method <b>External clamping</b>	manufacturer product line <b>Hainbuch</b>		

### Clamping head TOP65 G D=28,00mm

Product ID : 10434870

Previous product ID : 900565.G280

Clamping device size <b>SK65</b>	manufacturer product line <b>TOPlus chuck</b>	Clamping type <b>smooth</b>	Nominal diameter (mm) <b>28 Millimeter</b>
Clamping method <b>External clamping</b>	manufacturer product line <b>Hainbuch</b>		

### Clamping head TOP65 G D=29,00mm

Product ID : 10091067

Previous product ID : 900565.G290

Clamping device size <b>SK65</b>	manufacturer product line <b>TOPlus chuck</b>	Clamping type <b>smooth</b>	Nominal diameter (mm) <b>29 Millimeter</b>
Clamping method <b>External clamping</b>	manufacturer product line <b>Hainbuch</b>		

### Clamping head TOP65 G D=30,00mm

Product ID : 10398942

Previous product ID : 900565.G300

Clamping device size <b>SK65</b>	manufacturer product line <b>TOPlus chuck</b>	Clamping type <b>smooth</b>	Nominal diameter (mm) <b>30 Millimeter</b>
Clamping method <b>External clamping</b>	manufacturer product line <b>Hainbuch</b>		

### Clamping head TOP65 G D=31,00mm

Product ID : 10401326

Previous product ID : 900565.G310

Clamping device size <b>SK65</b>	manufacturer product line <b>TOPlus chuck</b>	Clamping type <b>smooth</b>	Nominal diameter (mm) <b>31 Millimeter</b>
Clamping method <b>External clamping</b>	manufacturer product line <b>Hainbuch</b>		

### Clamping head TOP65 G D=32,00mm

Product ID : 10182841

Previous product ID : 900565.G320

Clamping device size <b>SK65</b>	manufacturer product line <b>TOPlus chuck</b>	Clamping type <b>smooth</b>	Nominal diameter (mm) <b>32 Millimeter</b>
Clamping method <b>External clamping</b>	manufacturer product line <b>Hainbuch</b>		

### Clamping head TOP65 G D=33,00mm

Product ID : 10333080

Previous product ID : 900565.G330

Clamping device size <b>SK65</b>	manufacturer product line <b>TOPlus chuck</b>	Clamping type <b>smooth</b>	Nominal diameter (mm) <b>33 Millimeter</b>
Clamping method <b>External clamping</b>	manufacturer product line <b>Hainbuch</b>		

### Clamping head TOP65 G D=34,00mm

Product ID : 10386770

Previous product ID : 900565.G340

Clamping device size <b>SK65</b>	manufacturer product line <b>TOPlus chuck</b>	Clamping type <b>smooth</b>	Nominal diameter (mm) <b>34 Millimeter</b>
Clamping method <b>External clamping</b>	manufacturer product line <b>Hainbuch</b>		

### Clamping head TOP65 G D=35,00mm

Product ID : 10585990

Previous product ID : 900565.G350

Clamping device size <b>SK65</b>	manufacturer product line <b>TOPlus chuck</b>	Clamping type <b>smooth</b>	Nominal diameter (mm) <b>35 Millimeter</b>
Clamping method <b>External clamping</b>	manufacturer product line <b>Hainbuch</b>		

### Clamping head TOP65 G D=36,00mm

Product ID : 10420614

Previous product ID : 900565.G360

Clamping device size <b>SK65</b>	manufacturer product line <b>TOPlus chuck</b>	Clamping type <b>smooth</b>	Nominal diameter (mm) <b>36 Millimeter</b>
Clamping method <b>External clamping</b>	manufacturer product line <b>Hainbuch</b>		

### Clamping head TOP65 G D=37,00mm

Product ID : 10271460

Previous product ID : 900565.G370

Clamping device size <b>SK65</b>	manufacturer product line <b>TOPlus chuck</b>	Clamping type <b>smooth</b>	Nominal diameter (mm) <b>37 Millimeter</b>
Clamping method <b>External clamping</b>	manufacturer product line <b>Hainbuch</b>		

### Clamping head TOP65 G D=38,00mm

Product ID : 10827173

Previous product ID : 900565.G380

Clamping device size <b>SK65</b>	manufacturer product line <b>TOPlus chuck</b>	Clamping type <b>smooth</b>	Nominal diameter (mm) <b>38 Millimeter</b>
Clamping method <b>External clamping</b>	manufacturer product line <b>Hainbuch</b>		

### Clamping head TOP65 G D=39,00mm

Product ID : 11068800

Previous product ID : 900565.G390

Clamping device size SK65	manufacturer product line TOPlus chuck	Clamping type smooth	Nominal diameter (mm) 39 Millimeter
Clamping method External clamping	manufacturer product line Hainbuch		

### Clamping head TOP65 G D=40,00mm

Product ID : 10174565

Previous product ID : 900565.G400

Clamping device size SK65	manufacturer product line TOPlus chuck	Clamping type smooth	Nominal diameter (mm) 40 Millimeter
Clamping method External clamping	manufacturer product line Hainbuch		

### Clamping head TOP65 G D=41,00mm

Product ID : 10990285

Previous product ID : 900565.G410

Clamping device size SK65	manufacturer product line TOPlus chuck	Clamping type smooth	Nominal diameter (mm) 41 Millimeter
Clamping method External clamping	manufacturer product line Hainbuch		

### Clamping head TOP65 G D=42,00mm

Product ID : 10244210

Previous product ID : 900565.G420

Clamping device size SK65	manufacturer product line TOPlus chuck	Clamping type smooth	Nominal diameter (mm) 42 Millimeter
Clamping method External clamping	manufacturer product line Hainbuch		

### Clamping head TOP65 G D=43,00mm

Product ID : 10181135

Previous product ID : 900565.G430

Clamping device size SK65	manufacturer product line TOPlus chuck	Clamping type smooth	Nominal diameter (mm) 43 Millimeter
Clamping method External clamping	manufacturer product line Hainbuch		

### Clamping head TOP65 G D=44,00mm

Product ID : 11029256

Previous product ID : 900565.G440

Clamping device size SK65	manufacturer product line TOPlus chuck	Clamping type smooth	Nominal diameter (mm) 44 Millimeter
Clamping method External clamping	manufacturer product line Hainbuch		

### Clamping head TOP65 G D=45,00mm

Product ID : 10857184

Previous product ID : 900565.G450

Clamping device size SK65	manufacturer product line TOPlus chuck	Clamping type smooth	Nominal diameter (mm) 45 Millimeter
Clamping method External clamping	manufacturer product line Hainbuch		

### Clamping head TOP65 G D=46,00mm

Product ID : 10704556

Previous product ID : 900565.G460

Clamping device size SK65	manufacturer product line TOPlus chuck	Clamping type smooth	Nominal diameter (mm) 46 Millimeter
Clamping method External clamping	manufacturer product line Hainbuch		

### Clamping head TOP65 G D=47,00mm

Product ID : 10198937

Previous product ID : 900565.G470

Clamping device size <b>SK65</b>	manufacturer product line <b>TOPlus chuck</b>	Clamping type <b>smooth</b>	Nominal diameter (mm) <b>47 Millimeter</b>
Clamping method <b>External clamping</b>	manufacturer product line <b>Hainbuch</b>		

### Clamping head TOP65 G D=48,00mm

Product ID : 10692311

Previous product ID : 900565.G480

Clamping device size <b>SK65</b>	manufacturer product line <b>TOPlus chuck</b>	Clamping type <b>smooth</b>	Nominal diameter (mm) <b>48 Millimeter</b>
Clamping method <b>External clamping</b>	manufacturer product line <b>Hainbuch</b>		

### Clamping head TOP65 G D=49,00mm

Product ID : 10362760

Previous product ID : 900565.G490

Clamping device size <b>SK65</b>	manufacturer product line <b>TOPlus chuck</b>	Clamping type <b>smooth</b>	Nominal diameter (mm) <b>49 Millimeter</b>
Clamping method <b>External clamping</b>	manufacturer product line <b>Hainbuch</b>		

### Clamping head TOP65 G D=50,00mm

Product ID : 10312479

Previous product ID : 900565.G500

Clamping device size <b>SK65</b>	manufacturer product line <b>TOPlus chuck</b>	Clamping type <b>smooth</b>	Nominal diameter (mm) <b>50 Millimeter</b>
Clamping method <b>External clamping</b>	manufacturer product line <b>Hainbuch</b>		

### Clamping head TOP65 G D=51,00mm

Product ID : 10680051

Previous product ID : 900565.G510

Clamping device size SK65	manufacturer product line TOPlus chuck	Clamping type smooth	Nominal diameter (mm) 51 Millimeter
Clamping method External clamping	manufacturer product line Hainbuch		

### Clamping head TOP65 G D=52,00mm

Product ID : 10904617

Previous product ID : 900565.G520

Clamping device size SK65	manufacturer product line TOPlus chuck	Clamping type smooth	Nominal diameter (mm) 52 Millimeter
Clamping method External clamping	manufacturer product line Hainbuch		

### Clamping head TOP65 G D=53,00mm

Product ID : 10031538

Previous product ID : 900565.G530

Clamping device size SK65	manufacturer product line TOPlus chuck	Clamping type smooth	Nominal diameter (mm) 53 Millimeter
Clamping method External clamping	manufacturer product line Hainbuch		

### Clamping head TOP65 G D=54,00mm

Product ID : 10537946

Previous product ID : 900565.G540

Clamping device size SK65	manufacturer product line TOPlus chuck	Clamping type smooth	Nominal diameter (mm) 54 Millimeter
Clamping method External clamping	manufacturer product line Hainbuch		

### Clamping head TOP65 G D=55,00mm

Product ID : 10711577

Previous product ID : 900565.G550

Clamping device size SK65	manufacturer product line TOPlus chuck	Clamping type smooth	Nominal diameter (mm) 55 Millimeter
Clamping method External clamping	manufacturer product line Hainbuch		

### Clamping head TOP65 G D=56,00mm

Product ID : 10688076

Previous product ID : 900565.G560

Clamping device size SK65	manufacturer product line TOPlus chuck	Clamping type smooth	Nominal diameter (mm) 56 Millimeter
Clamping method External clamping	manufacturer product line Hainbuch		

### Clamping head TOP65 G D=57,00mm

Product ID : 10484931

Previous product ID : 900565.G570

Clamping device size SK65	manufacturer product line TOPlus chuck	Clamping type smooth	Nominal diameter (mm) 57 Millimeter
Clamping method External clamping	manufacturer product line Hainbuch		

### Clamping head TOP65 G D=58,00mm

Product ID : 10636437

Previous product ID : 900565.G580

Clamping device size SK65	manufacturer product line TOPlus chuck	Clamping type smooth	Nominal diameter (mm) 58 Millimeter
Clamping method External clamping	manufacturer product line Hainbuch		

### Clamping head TOP65 G D=59,00mm

Product ID : 10691089

Previous product ID : 900565.G590

Clamping device size SK65	manufacturer product line TOPlus chuck	Clamping type smooth	Nominal diameter (mm) 59 Millimeter
Clamping method External clamping	manufacturer product line Hainbuch		

### Clamping head TOP65 G D=60,00mm

Product ID : 10633581

Previous product ID : 900565.G600

Clamping device size SK65	manufacturer product line TOPlus chuck	Clamping type smooth	Nominal diameter (mm) 60 Millimeter
Clamping method External clamping	manufacturer product line Hainbuch		

### Clamping head TOP65 G D=61,00mm

Product ID : 10296772

Previous product ID : 900565.G610

Clamping device size SK65	manufacturer product line TOPlus chuck	Clamping type smooth	Nominal diameter (mm) 61 Millimeter
Clamping method External clamping	manufacturer product line Hainbuch		

### Clamping head TOP65 G D=62,00mm

Product ID : 10416833

Previous product ID : 900565.G620

Clamping device size SK65	manufacturer product line TOPlus chuck	Clamping type smooth	Nominal diameter (mm) 62 Millimeter
Clamping method External clamping	manufacturer product line Hainbuch		

### Clamping head TOP65 G D=63,00mm

Product ID : 10373217

Previous product ID : 900565.G630

Clamping device size <b>SK65</b>	manufacturer product line <b>TOPlus chuck</b>	Clamping type <b>smooth</b>	Nominal diameter (mm) <b>63 Millimeter</b>
Clamping method <b>External clamping</b>	manufacturer product line <b>Hainbuch</b>		

### Clamping head TOP65 G D=64,00mm

Product ID : 10524923

Previous product ID : 900565.G640

Clamping device size <b>SK65</b>	manufacturer product line <b>TOPlus chuck</b>	Clamping type <b>smooth</b>	Nominal diameter (mm) <b>64 Millimeter</b>
Clamping method <b>External clamping</b>	manufacturer product line <b>Hainbuch</b>		

### Clamping head TOP65 G D=65,00mm

Product ID : 10612390

Previous product ID : 900565.G650

Clamping device size <b>SK65</b>	manufacturer product line <b>TOPlus chuck</b>	Clamping type <b>smooth</b>	Nominal diameter (mm) <b>65 Millimeter</b>
Clamping method <b>External clamping</b>	manufacturer product line <b>Hainbuch</b>		

### Clamping head TOP65 HSW D=8,00mm

Product ID : 10899243

Previous product ID : 900565.W080

Clamping device size <b>SK65</b>	manufacturer product line <b>TOPlus chuck</b>	Clamping type <b>Soft for custom boring</b>	Nominal diameter (mm) <b>8 Millimeter</b>
Clamping method <b>External clamping</b>	manufacturer product line <b>Hainbuch</b>		

---

### Clamping head TOP65 HSW D=20,00mm

Product ID : 10324949

Previous product ID : 900565.W200

Clamping device size SK65	manufacturer product line TOPlus chuck	Clamping type Soft for custom boring	Nominal diameter (mm) 20 Millimeter
Clamping method External clamping	manufacturer product line Hainbuch		

### Clamping head TOP65 HSW D=40,00mm

Product ID : 10322862

Previous product ID : 900565.W400

Clamping device size SK65	manufacturer product line TOPlus chuck	Clamping type Soft for custom boring	Nominal diameter (mm) 40 Millimeter
Clamping method External clamping	manufacturer product line Hainbuch		

### HAINBUCH GREASE 2085/0003

Product ID : 10825733

Previous product ID : 373241.1021

manufacturer product line SPANNTOP nova chuck • SPANNTOP mini chuck • TOPlus chuck • TOPlus chuck mini • TOPlus chuck with end-stop	Clamping method External clamping	manufacturer product line Hainbuch
--	--------------------------------------	---------------------------------------

### **Other accessories**

### Clamping head TOP65 HSW D=5,00mm top65hswr5,0

Product ID : 10918749

Previous product ID : 900565.W050

---