

Polygon turning unit Circular prism 1:3, 8,000 rpm

Technical data

Shank TNL	Circular prism
Drive	Spur gear TRAUB TNL12
Fixation TNL	Central tensioning screw
Speed ratio	1:3
Mounting	D12
reversible 180°	no
Direction	opposite to drive direction
X [mm]	20.5 (0.81")
Y [mm]	—
Z [mm]	13.5 (0.53)
INDEX TRAUB products	TNL12

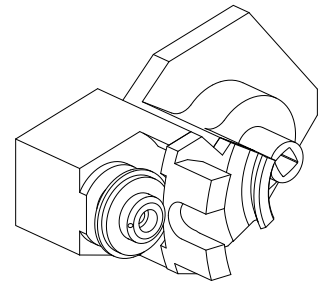

Note

The maximum diameter of the polygon tool is 69 mm! Adjacent stations can only be used to a limited extent!

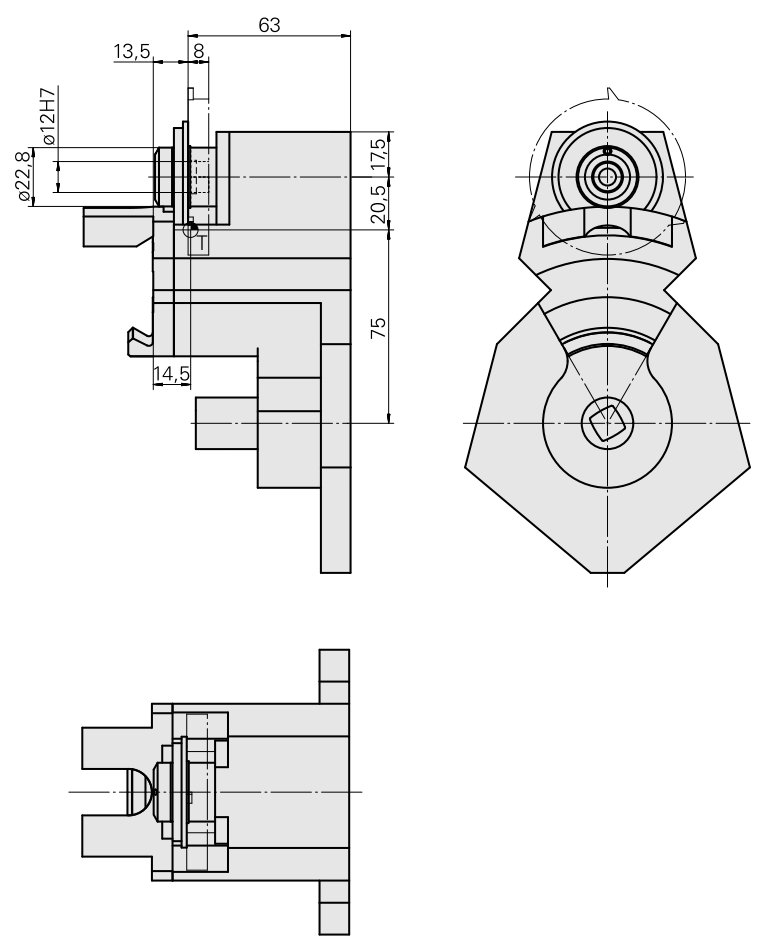

Documents

No downloads available for this product