

## Turning tool holder KPS 45 Square 12x12, triple

### Technical data

|                             |   |
|-----------------------------|---|
| <b>Shank KPS</b>            | KPS 45  |
| <b>Drive</b>                | not live  |
| <b>Cooling</b>              | external  |
| <b>Mounting</b>             | Square 12x12  |
| <b>Pressure</b>             | 10 bar  |
| <b>X [mm]</b>               | 85 (3.35")  |
| <b>Y [mm]</b>               | ±13°  |
| <b>Z [mm]</b>               | -10 (-0.39)   |
| <b>INDEX TRAUB products</b> | TNL18 • TNL20 • TNL32-11<br>compact • TNL20-11 • TNL32<br>compact • TNK40.2-10 • TNL20.2 •<br>TNK40.2 |

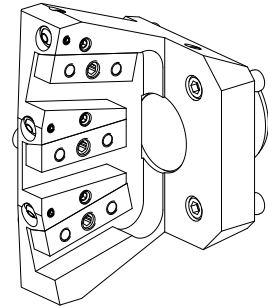

### Note

Particularly suitable for use on the rotary axis!



## **Documents**

No downloads available for this product

## **Accessories**

Optional accessories

### **Other accessories**

#### [BALL SPRAY NOZZLE 10D/M4](#)

Product ID : 10679818

Previous product ID : 474550.0081

---