

Motor

Technical data

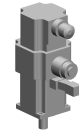

Electrical assemblies	Servomotor
Length	60 Millimeter
Width	106.6 Millimeter
Height	77.1 Millimeter
Current	1.4 Ampere
Voltage	200 Volt
Voltage type	AC~
(Nominal) speed (rpm)	3000 1/minute
Rated power W	200 Watt
(Stall) torque [Nm]	1.9 Newton/meter
Protection class	IP65
Brake	yes - braked

No 3-side view is currently available for this product

10381582
223150

INDEX

Documents

No downloads available for this product