

Basic holder MS32/MS40 Hydraulic expansi, double

Technical data

Slide system MS	MS32/MS40
Drive	not live
Fixation MS	Dovetail
Mounting	Hydraulic expansion chuck D36
X [mm]	73 + 128 (2.87" + 5.04")
Y [mm]	–
Z [mm]	79.5 (3.13)
INDEX TRAUB products	MS32-6.3 • MS32C • MS32-6.2 • MS40-6

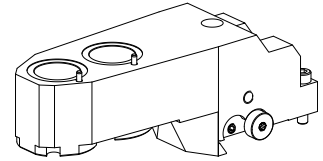

Note

Specially for INDEX MS32-6 with 3-axis-handling in positions 1.2, 2.1 and 5.1!

No 3-side view is currently available for this product

Documents

Product notes

[DE \(pdf\)](#)

[EN \(pdf\)](#)

[FR \(pdf\)](#)

Accessories

Optional accessories

MS tool holders

[Blanking plug](#)

Product ID : 12013851

Previous product ID :

Drive not live	Fixation MS Clamping ring D28.5	X [mm] -	Y [mm] -
Z [mm] -			

Other accessories

[Not defined Standard MS32](#)

Product ID : 10536748

Previous product ID : WM3600.3100F
