

## Drilling tool holder VDI 40 D40, Form E2

### Technical data

|                      |   |
|----------------------|---|
| Shank VDI            | VDI 40  |
| Drive                | not live  |
| Fixation VDI         | none  |
| Cooling              | external  |
| Pressure             | 20 bar  |
| Mounting             | D40   |
| reversible 180°      | no  |
| X [mm]               | 85 (3.35")  |
| Y [mm]               | —   |
| Z [mm]               | —   |
| INDEX TRAUB products | V200 • TNA400.3 • B400.3 • B500.3<br>• TNA500.3 • V300 • TNA400<br>• B400 • B500 • TNA500.2 •<br>TNA400.2 |

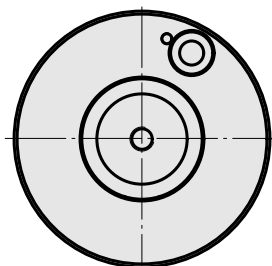
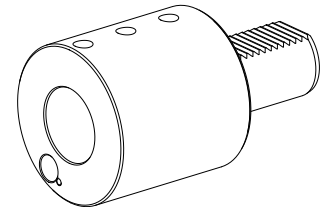

---

## Documents

No downloads available for this product

## Accessories

### Optional accessories

#### Other accessories

#### [Mounting sleeve D40 2x holes](#)

Product ID : 10159790

Previous product ID : W64220.02--

---

#### [Mounting sleeve with collar D40](#)

Product ID : 10480161

Previous product ID : W64222.41--

---

#### [Mounting sleeve D40 3x holes](#)

Product ID : 10789882

Previous product ID : W64221.14--

---

#### [SPRAY NOZZLE 14D/M6](#)

Product ID : 10358770

Previous product ID : 474550.0121

---

#### [Lens head screw](#)

Product ID : 10344546

Previous product ID : 410243.0406

---