

## Grooving tool holding block square 20x20, vertically adjustable

### Technical data

|                      |              |
|----------------------|--------------|
| Drive                | not live     |
| Mounting             | Square 20x20 |
| reversible 180°      | yes          |
| X [mm]               | 37 (1.46")   |
| Y [mm]               | –            |
| Z [mm]               | 28 (1.10)    |
| INDEX TRAUB products | ABC • ABC.2  |

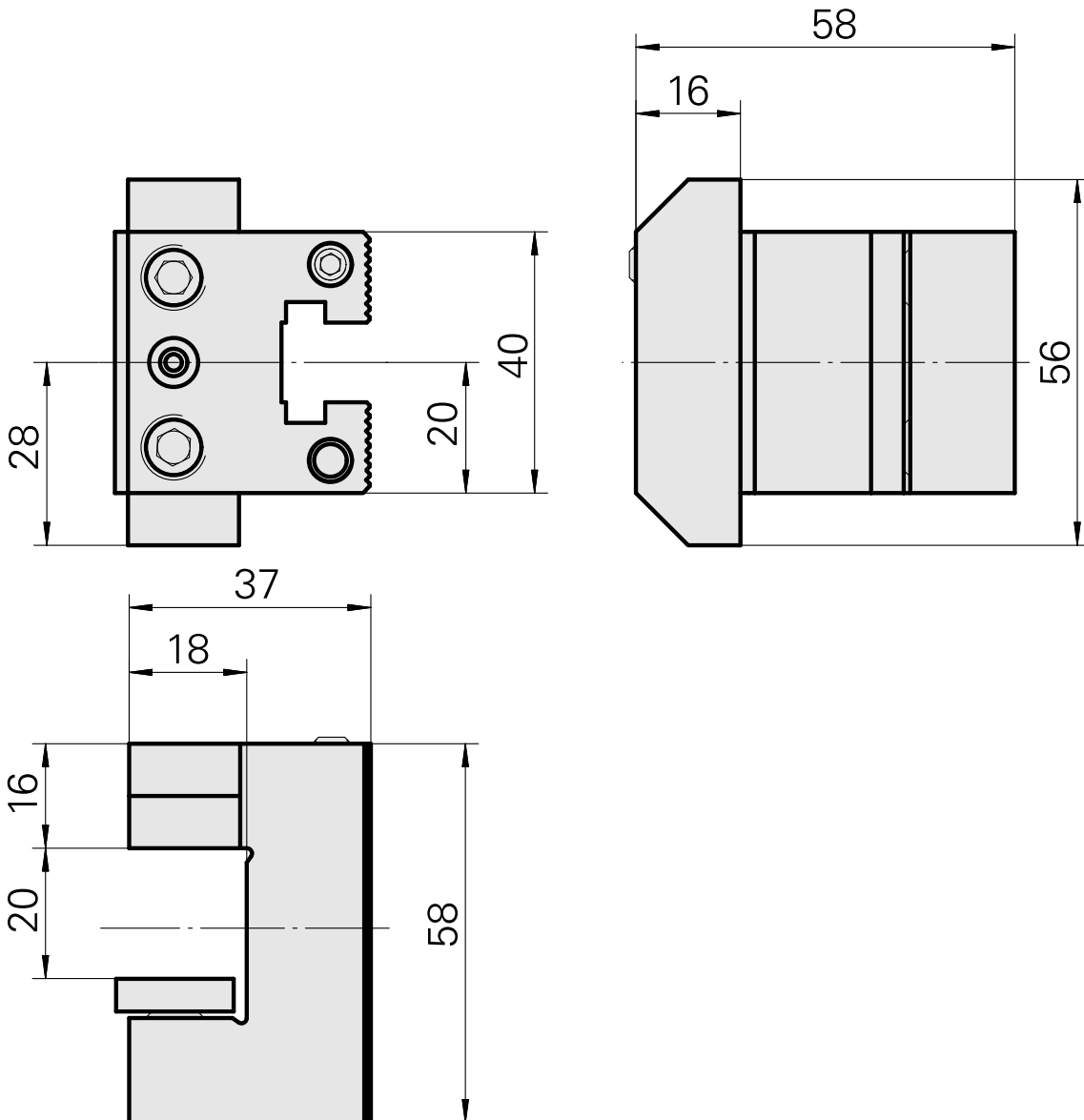
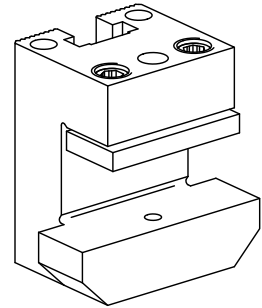

## **Documents**

No downloads available for this product