



## INDEX MS22-8

[Tool holder](#)

[Overview](#)

## **Note on applicability**

Illustrations in this publication may deviate from the product supplied. Errors and omissions due to technical progress expected.

## **A word on copyright**

This document is protected by copyright and was originally compiled in German. The duplication and distribution of this document or parts thereof is prohibited without prior consent of the copyright owner, and any violators will be prosecuted. All rights, including the right to translate, are reserved.

© Copyright by INDEX-Werke GmbH & Co. KG

# Stationary tool holder Cross Slide Unit 1.1 - 8.2

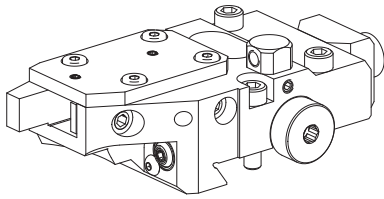

## 10103849 Turning tool holder

<b>Fixation</b>	–
<b>Mounting</b>	Square 12x12
<b>Cooling</b>	external, $p_{\max}$ 20 bar
<b>X / Y / Z</b>	55 (2.17) / – / 13 (0.51) mm (")

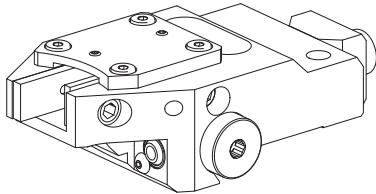

## 10003727 Turning tool holder

<b>Fixation</b>	–
<b>Mounting</b>	square 16x16
<b>Cooling</b>	external, $p_{\max}$ 20 bar
<b>X / Y / Z</b>	49.7 (1.96) / – / 14.5 (0.57) mm (")

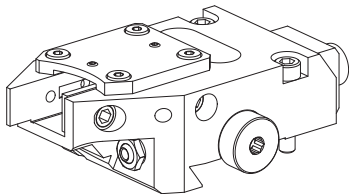

## 12050246 Turning tool holder

<b>Fixation</b>	–
<b>Mounting</b>	square 16x16
<b>Cooling</b>	external and internal, $p_{\max}$ 80 bar
<b>X / Y / Z</b>	49.2 (1.94) / – / 14.5 (0.57) mm (")

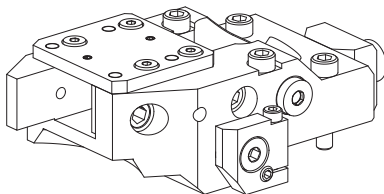

## 10591158 Turning tool holder

<b>Fixation</b>	–
<b>Mounting</b>	square 20x20
<b>Cooling</b>	external, $p_{\max}$ 20 bar
<b>X / Y / Z</b>	60 (2.36) / – / 13 (0.51) mm (")

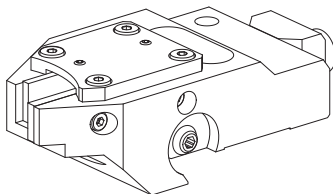

## 10244868 Turning tool holder

<b>Fixation</b>	–
<b>Mounting</b>	square 16x16
<b>Cooling</b>	external, $p_{\max}$ 20 bar
<b>X / Y / Z</b>	49.7 (1.96) / – / 14.5 (0.57) mm (")

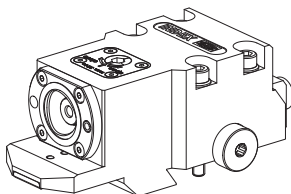

## 10469477 Clamping unit, with stop

<b>Fixation</b>	–
<b>Mounting</b>	INDEX TRAUB CAPTO C3
<b>Cooling</b>	internal, $p_{\max}$ 80 bar
<b>X / Y / Z</b>	46 (1.81) / – / 33 (1.30) mm (")

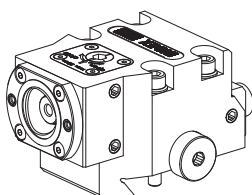

## 10936448 Clamping unit

<b>Fixation</b>	–
<b>Mounting</b>	INDEX TRAUB CAPTO C3
<b>Cooling</b>	internal, $p_{\max}$ 80 bar
<b>X / Y / Z</b>	28.7 (1.13) / – / 33 (1.30) mm (")

# Stationary tool holder Cross Slide Unit 1.1 - 8.2

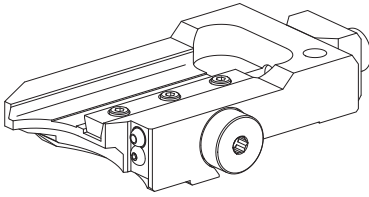

## 10457876 Grooving tool holder

<b>Fixation</b>	–
<b>Mounting</b>	Trapezoid 26x4
<b>Cooling</b>	external, $p_{\max}$ 20 bar
<b>X / Y / Z</b>	49.7 (1.96) / – / 11.5 (0.45) mm (")

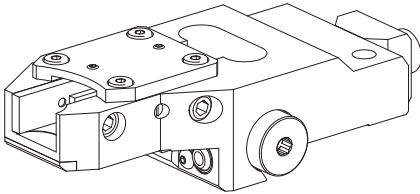

## 10810737 Grooving tool and stop holder

<b>Fixation</b>	–
<b>Mounting</b>	square 16x16
<b>Cooling</b>	external, $p_{\max}$ 20 bar
<b>X / Y / Z</b>	71.7 (2.82) / – / 15 (0.59) mm (")

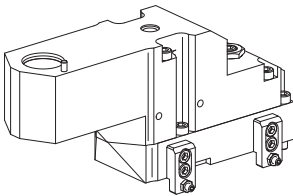

## 10340339 Basic holder

<b>Fixation</b>	–
<b>Mounting</b>	Hydraulic expan. Chuck D28.5
<b>Cooling</b>	–
<b>X / Y / Z</b>	82.3 (3.24) / – / 50 (1.97) mm (")

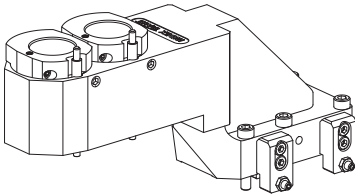

## 10639196 Basic holder, double

<b>Fixation</b>	–
<b>Mounting</b>	Hydraulic expan. Chuck D28.5
<b>Cooling</b>	–
<b>X / Y / Z</b>	67.8 + 111.8 (2.67 + 4.40) / – / 50 (1.97) mm (")

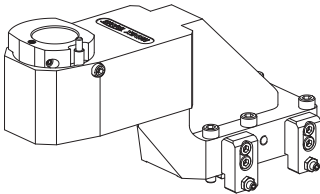

## 10930315 Basic holder

<b>Fixation</b>	–
<b>Mounting</b>	Hydraulic expan. Chuck D28.5
<b>Cooling</b>	–
<b>X / Y / Z</b>	82.3 (3.24) / – / 50 (1.97) mm (")

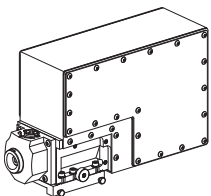

## 10072866 Turning turret

<b>Fixation</b>	–
<b>Mounting</b>	INDEX TRAUB CAPTO C4
<b>Cooling</b>	–
<b>X / Y / Z</b>	23.9 (0.94) / – / 50.3 (1.98) mm (")

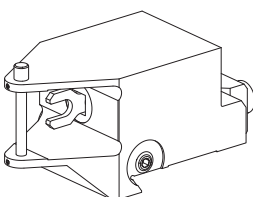

## 12054450 Basic holder

<b>Fixation</b>	–
<b>Mounting</b>	Fette T120
<b>Cooling</b>	–
<b>X / Y / Z</b>	52 (2.05) / – / -31 (1.22) mm (")

# Stationary tool holder Cross Slide Unit 1.1 - 8.2

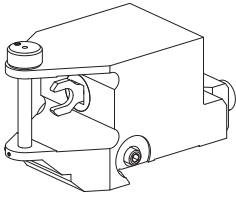

## 12054537 Basic holder

Fixation	–
Mounting	Fette T160
Cooling	–
X / Y / Z	49 (1.93) / – / 35 (1.38) mm (")

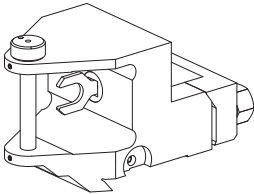

## 12054538 Basic holder

Fixation	–
Mounting	Fette T220
Cooling	–
X / Y / Z	41 (1.61) / – / 47 (1.85) mm (")

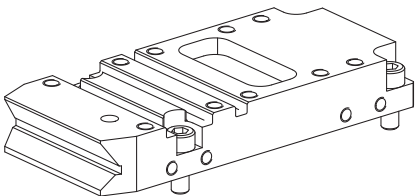

## 10583516 Distance plate

Fixation	–
Mounting	–
Cooling	–
X / Y / Z	– / – / 20 (0.79) mm (")

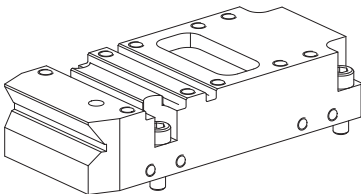

## 10835462 Distance plate

Fixation	–
Mounting	–
Cooling	–
X / Y / Z	– / – / 30 (1.18) mm (")

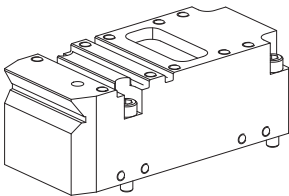

## 10028477 Distance plate

Fixation	–
Mounting	–
Cooling	–
X / Y / Z	– / – / 50 (1.97) mm (")

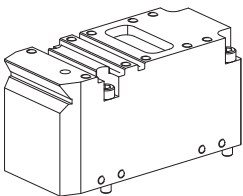

## 10359947 Distance plate

Fixation	–
Mounting	–
Cooling	–
X / Y / Z	– / – / 70 (2.76) mm (")

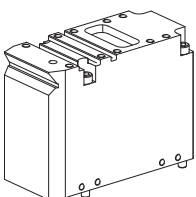

## 10724690 Distance plate

Fixation	–
Mounting	–
Cooling	–
X / Y / Z	– / – / 100 (3.94) mm (")

# Live tool holder Cross Slide Unit 1.1 - 8.2

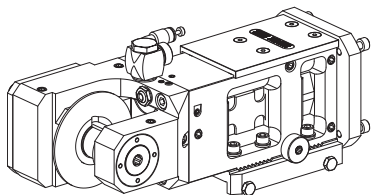

## 10048093 Milling unit

<b>Fixation</b>	–
<b>Mounting</b>	Milling shaft D22 (0.87 ")
<b>Cooling</b>	external, $p_{\max}$ 80 bar
<b>Speed ratio</b>	3.5:1 (3.5)
<b>X / Y / Z</b>	79.3 (3.12) / – / 50 (1.97) mm (")

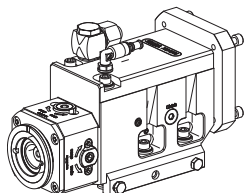

## 11093533 Milling unit

<b>Fixation</b>	–
<b>Mounting</b>	INDEX TRAUB CAPTO C3
<b>Cooling</b>	internal, $p_{\max}$ 80 bar
<b>Speed ratio</b>	1:2 (0.5)
<b>X / Y / Z</b>	42.8 / – / 30 (1.18) mm (")

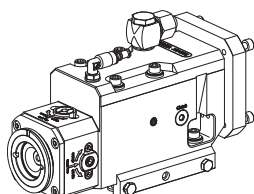

## 11089692 Milling unit

<b>Fixation</b>	–
<b>Mounting</b>	INDEX TRAUB CAPTO C3
<b>Cooling</b>	internal, $p_{\max}$ 80 bar
<b>Speed ratio</b>	1:1 (1)
<b>X / Y / Z</b>	54.3 / – / 30 (1.18) mm (")

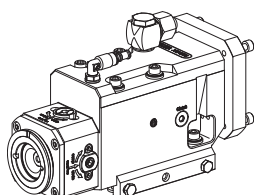

## 11089694 Milling unit

<b>Fixation</b>	–
<b>Mounting</b>	INDEX TRAUB CAPTO C3
<b>Cooling</b>	internal, $p_{\max}$ 80 bar
<b>Speed ratio</b>	2:1 (2)
<b>X / Y / Z</b>	54.3 / – / 30 (1.18) mm (")

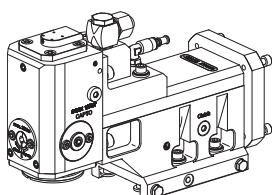

## 11093536 Milling unit

<b>Fixation</b>	–
<b>Mounting</b>	INDEX TRAUB CAPTO C3
<b>Cooling</b>	internal, $p_{\max}$ 80 bar
<b>Speed ratio</b>	1:2 (0.5)
<b>X / Y / Z</b>	68.3 / – / 32.5 (1.28) mm (")

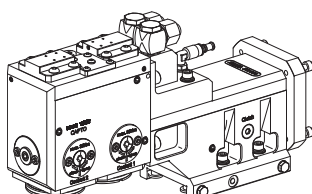

## 11093539 Milling unit, double

<b>Fixation</b>	–
<b>Mounting</b>	INDEX TRAUB CAPTO C3
<b>Cooling</b>	internal, $p_{\max}$ 80 bar
<b>Speed ratio</b>	1:2 (0.5)
<b>X / Y / Z</b>	68.3 + 128.3 (2.69 + 5.05) / – / 32.5 (1.28) mm (")

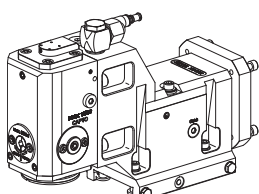

## 11093534 Milling unit

<b>Fixation</b>	–
<b>Mounting</b>	INDEX TRAUB CAPTO C3
<b>Cooling</b>	internal, $p_{\max}$ 80 bar
<b>Speed ratio</b>	1:1 (1)
<b>X / Y / Z</b>	68.3 / – / 32.5 (1.28) mm (")

# Live tool holder Cross Slide Unit 1.1 - 8.2

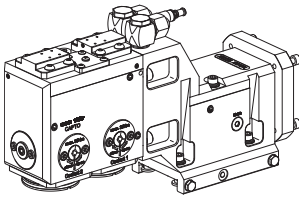

## 11093537 Milling unit, double

<b>Fixation</b>	–
<b>Mounting</b>	INDEX TRAUB CAPTO C3
<b>Cooling</b>	internal, $p_{\max}$ 80 bar
<b>Speed ratio</b>	1:1 (1)
<b>X / Y / Z</b>	68.3 + 128.3 (2.69 + 5.05) / – / 32.5 (1.28) mm (")

---

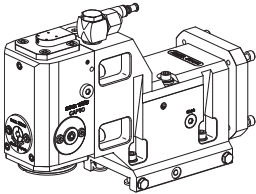

## 11093535 Milling unit

<b>Fixation</b>	–
<b>Mounting</b>	INDEX TRAUB CAPTO C3
<b>Cooling</b>	internal, $p_{\max}$ 80 bar
<b>Speed ratio</b>	2:1 (2)
<b>X / Y / Z</b>	68.3 / – / 32.5 (1.28) mm (")

---

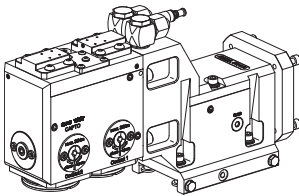

## 11093538 Milling unit, double

<b>Fixation</b>	–
<b>Mounting</b>	INDEX TRAUB CAPTO C3
<b>Cooling</b>	internal, $p_{\max}$ 80 bar
<b>Speed ratio</b>	2:1 (2)
<b>X / Y / Z</b>	68.3 + 128.3 (2.69 + 5.05) / – / 32.5 (1.28) mm (")

---

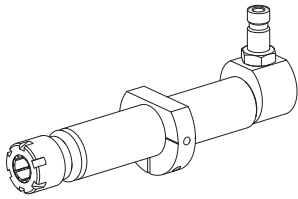

**10672317 Drilling tool holder**

**Fixation** Clamping ring D28.5  
**Mounting** ER 20  
**Cooling** internal,  $p_{max}$  80 bar  
**X / Y / Z** - / - / - mm (")

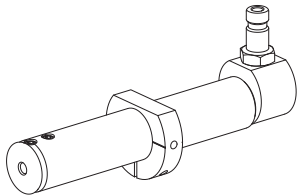

**10188150 Drilling tool holder**

**Fixation** Clamping ring D28.5  
**Mounting** DIN 1835 B/E D6 (0.24 ")  
**Cooling** internal,  $p_{max}$  80 bar  
**X / Y / Z** - / - / - mm (")

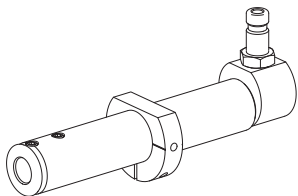

**10480870 Drilling tool holder**

**Fixation** Clamping ring D28.5  
**Mounting** DIN 1835 B/E D14 (0.55 ")  
**Cooling** internal,  $p_{max}$  80 bar  
**X / Y / Z** - / - / - mm (")

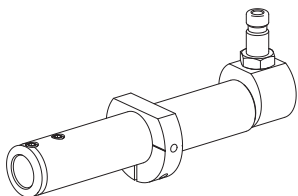

**10219251 Drilling tool holder**

**Fixation** Clamping ring D28.5  
**Mounting** DIN 1835 B/E D18 (0.71 ")  
**Cooling** internal,  $p_{max}$  80 bar  
**X / Y / Z** - / - / - mm (")

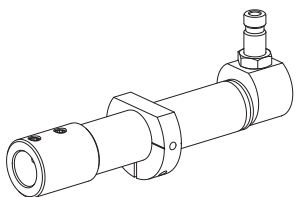

**10617778 Drilling tool holder**

**Fixation** Clamping ring D28.5  
**Mounting** DIN 1835 B/E D20 (0.79 ")  
**Cooling** internal,  $p_{max}$  80 bar  
**X / Y / Z** - / - / - mm (")

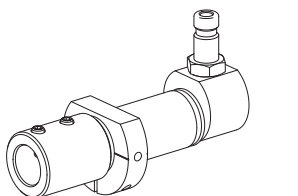

**10684441 Drilling tool holder**

**Fixation** Clamping ring D28.5  
**Mounting** DIN 1835 B/E D20 (0.79 ")  
**Cooling** internal,  $p_{max}$  80 bar  
**X / Y / Z** - / - / - mm (")

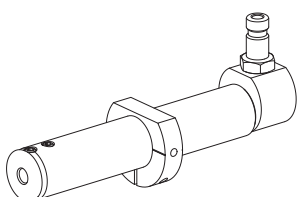

**11015755 Drilling tool holder**

**Fixation** Clamping ring D28.5  
**Mounting** D8 (0.31 ")  
**Cooling** internal,  $p_{max}$  80 bar  
**X / Y / Z** - / - / - mm (")



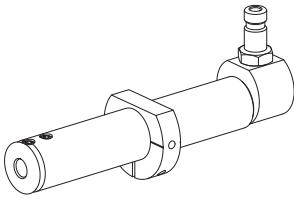

**10258744 Drilling tool holder**

**Fixation** Clamping ring D28.5  
**Mounting** D10 (0.39 ")  
**Cooling** internal,  $p_{max}$  80 bar  
**X / Y / Z** - / - / - mm (")

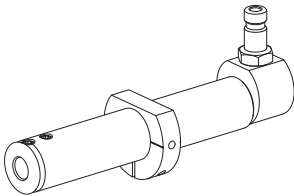

**10218953 Drilling tool holder**

**Fixation** Clamping ring D28.5  
**Mounting** D12 (0.47 ")  
**Cooling** internal,  $p_{max}$  80 bar  
**X / Y / Z** - / - / - mm (")

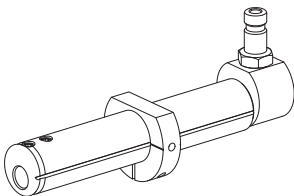

**10852940 Drilling tool holder**

**Fixation** Clamping ring D28.5  
**Mounting** D12 (0.47 ")  
**Cooling** internal,  $p_{max}$  80 bar  
**X / Y / Z** 4 (0.16) / - / - mm (")

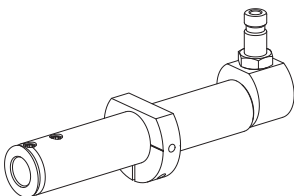

**10139115 Drilling tool holder**

**Fixation** Clamping ring D28.5  
**Mounting** D16 (0.63 ")  
**Cooling** internal,  $p_{max}$  80 bar  
**X / Y / Z** - / - / - mm (")

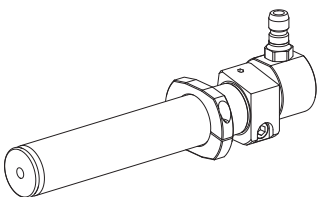

**12008759 Drilling tool holder**

**Fixation** Clamping ring D28.5  
**Mounting** Hydraulic expansion chuck D6  
**Cooling** internal,  $p_{max}$  80 bar  
**X / Y / Z** - / - / - mm (")

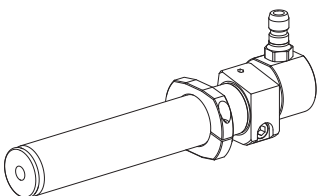

**12034261 Drilling tool holder**

**Fixation** Clamping ring D28.5  
**Mounting** Hydraulic expansion chuck D8  
**Cooling** internal,  $p_{max}$  80 bar  
**X / Y / Z** - / - / - mm (")

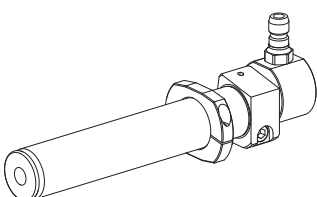

**12028308 Drilling tool holder**

**Fixation** Clamping ring D28.5  
**Mounting** Hydraulic expansion chuck D10  
**Cooling** internal,  $p_{max}$  80 bar  
**X / Y / Z** - / - / - mm (")

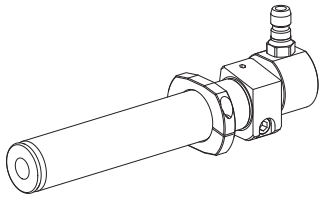

**12028307 Drilling tool holder**

**Fixation** Clamping ring D28.5  
**Mounting** Hydraulic expansion chuck D12  
**Cooling** internal,  $p_{max}$  80 bar  
**X / Y / Z** - / - / - mm (")

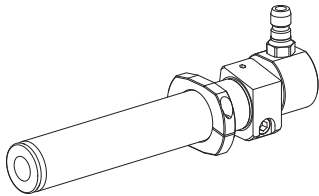

**12034215 Drilling tool holder**

**Fixation** Clamping ring D28.5  
**Mounting** Hydraulic expansion chuck D14  
**Cooling** internal,  $p_{max}$  80 bar  
**X / Y / Z** - / - / - mm (")

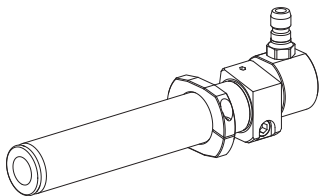

**12028305 Drilling tool holder**

**Fixation** Clamping ring D28.5  
**Mounting** Hydraulic expansion chuck D16  
**Cooling** internal,  $p_{max}$  80 bar  
**X / Y / Z** - / - / - mm (")

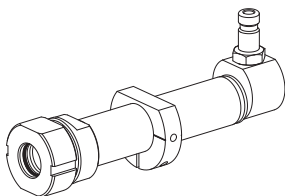

**10132662 Compensation holder**

**Fixation** Clamping ring D28.5  
**Mounting** D3/4"  
**Cooling** internal,  $p_{max}$  80 bar  
**X / Y / Z** - / - / - mm (")

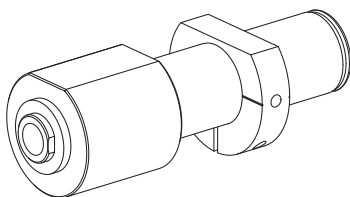

**11016418 Center holder**

**Fixation** Clamping ring D28.5  
**Mounting** D11.2 (0.44 ") / Cone 1:7.5  
**Cooling** -  
**X / Y / Z** - / - / - mm (")

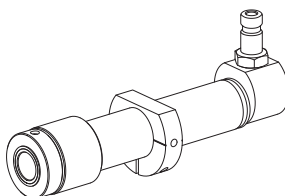

**10270154 Reaming tool holder**

**Fixation** Clamping ring D28.5  
**Mounting** D16 (0.63 ")  
**Cooling** internal,  $p_{max}$  80 bar  
**X / Y / Z** - / - / - mm (")

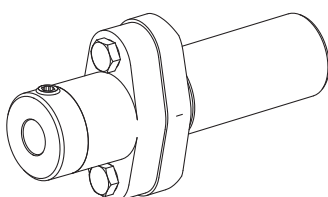

**10796227 Broaching/ Slotting holder**

**Fixation** Clamping ring D28.5  
**Mounting** D12 (0.47 ")  
**Cooling** -  
**X / Y / Z** 54 (2.13) / - / - mm (")

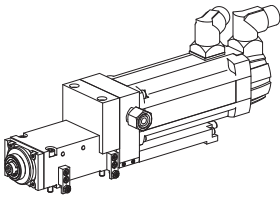

**10299617 Milling unit**

<b>Fixation</b>	–
<b>Mounting</b>	HSK 25 C
<b>Cooling</b>	internal, $p_{\max}$ 30 bar
<b>Speed ratio</b>	1:2 (0.5)
<b>X / Y / Z</b>	– / – / – mm (")

---

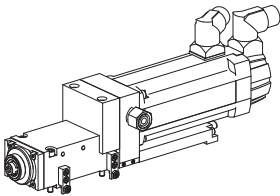

**10442232 Milling unit**

<b>Fixation</b>	–
<b>Mounting</b>	HSK 25 C
<b>Cooling</b>	external, $p_{\max}$ 30 bar
<b>Speed ratio</b>	1:2 (0.5)
<b>X / Y / Z</b>	– / – / – mm (")

---

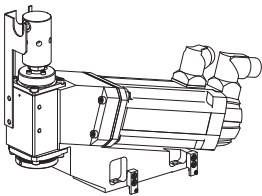

**10470546 Milling unit**

<b>Fixation</b>	–
<b>Mounting</b>	HSK 25 C
<b>Cooling</b>	internal, $p_{\max}$ 30 bar
<b>Speed ratio</b>	1:1.69 (0.59)
<b>X / Y / Z</b>	– / – / – mm (")

---

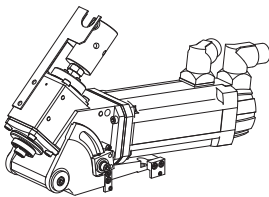

**10246158 Milling unit, angle-adjustable**

<b>Fixation</b>	–
<b>Mounting</b>	HSK 25 C
<b>Cooling</b>	external and internal, $p_{\max}$ 30 bar
<b>Speed ratio</b>	1:1.66 (0.6)
<b>X / Y / Z</b>	– / – / – mm (")

---

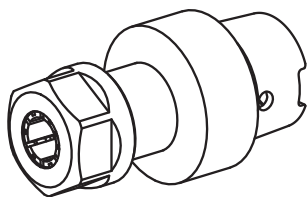

**10362267 Drilling tool holder**

**Form** C  
**Mounting** ER 11  
**Cooling** internal,  $p_{max}$  40 bar  
**X / Z** 32.5 (1.28) / – mm (")

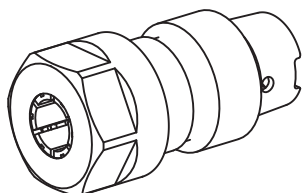

**10851232 Drilling tool holder**

**Form** C  
**Mounting** ER 16  
**Cooling** internal,  $p_{max}$  40 bar  
**X / Z** 40 (1.57) / – mm (")

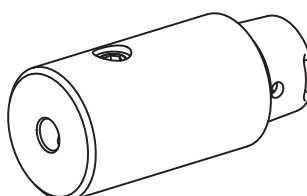

**10088455 Drilling tool holder**

**Form** C  
**Mounting** DIN 1835 B/E D6 (0.24 ")  
**Cooling** internal,  $p_{max}$  40 bar  
**X / Z** 42 (1.65) / – mm (")

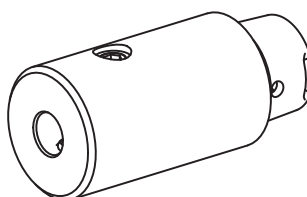

**10227271 Drilling tool holder**

**Form** C  
**Mounting** DIN 1835 B/E D8 (0.31 ")  
**Cooling** internal,  $p_{max}$  40 bar  
**X / Z** 42 (1.65) / – mm (")

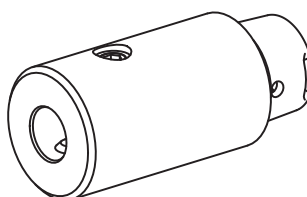

**11010216 Drilling tool holder**

**Form** C  
**Mounting** DIN 1835 B/E D10 (0.39 ")  
**Cooling** internal,  $p_{max}$  40 bar  
**X / Z** 42 (1.65) / – mm (")

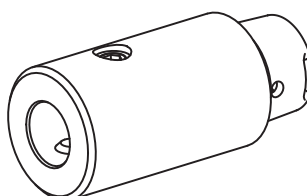

**10180188 Drilling tool holder**

**Form** C  
**Mounting** DIN 1835 B/E D12 (0.47 ")  
**Cooling** internal,  $p_{max}$  40 bar  
**X / Z** 42 (1.65) / – mm (")

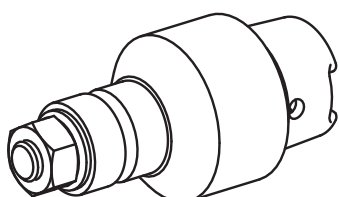

**10145135 Milling cutter holder**

**Form** C  
**Mounting** Milling shaft D8 (0.31 ")  
**Cooling** internal,  $p_{max}$  40 bar  
**X / Z** 24 (0.94) / – mm (")

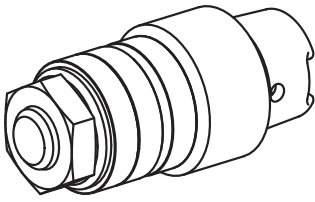

**10053566 Milling cutter holder**

<b>Form</b>	C
<b>Mounting</b>	Milling shaft D10 (0.39 ")
<b>Cooling</b>	internal, $p_{\max}$ 40 bar
<b>X / Z</b>	19 (0.75) / – mm (")

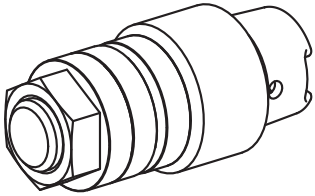

**10357133 Milling cutter holder**

<b>Form</b>	C
<b>Mounting</b>	Milling shaft D13 (0.51 ")
<b>Cooling</b>	internal, $p_{\max}$ 40 bar
<b>X / Z</b>	20 (0.79) / – mm (")

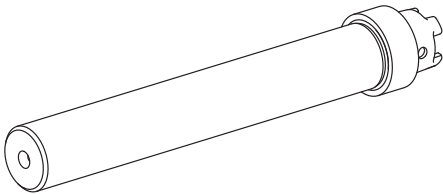

**10454596 Calibrating tool**

<b>Form</b>	C
<b>Mounting</b>	D20 (0.79 ")
<b>Cooling</b>	–
<b>X / Z</b>	140 (5.51) / – mm (")

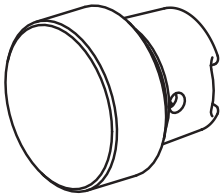

**10325737 Blanking plug**

<b>Form</b>	C
<b>Mounting</b>	–
<b>Cooling</b>	–
<b>X / Z</b>	10 (0.39) / – mm (")

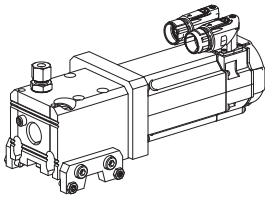

**10667347 Tool drive unit**

<b>Fixation</b>	–
<b>Mounting</b>	VDI 20
<b>Cooling</b>	internal, $p_{\max}$ 30 bar
<b>Speed ratio</b>	1:1 (1)
<b>X / Y / Z</b>	– / – / – mm (")

---

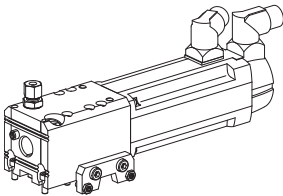

**10850665 Tool drive unit, for control C200-sl**

<b>Fixation</b>	–
<b>Mounting</b>	VDI 20
<b>Cooling</b>	external and internal, $p_{\max}$ 80 bar
<b>Speed ratio</b>	1:1 (1)
<b>X / Y / Z</b>	– / – / – mm (")

---

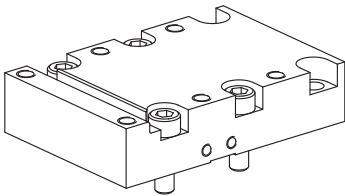

**11094714 Distance plate**

<b>Fixation</b>	–
<b>Mounting</b>	–
<b>Cooling</b>	–
<b>X / Y / Z</b>	– / – / 20 (0.79) mm (")

---

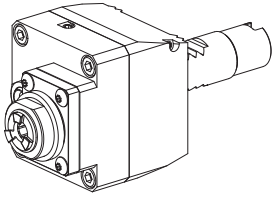

**10652900 Drilling unit**

<b>Fixation</b>	W serration
<b>Mounting</b>	ER 11
<b>Cooling</b>	external, $p_{\max}$ 20 bar
<b>Speed ratio</b>	1:2.63 (0.38)
<b>X / Y / Z</b>	75 (2.95) / – / 12.5 (0.49) mm (")

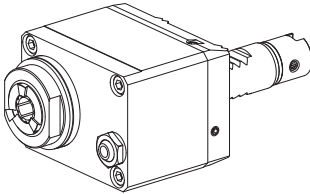

**10645146 Drilling unit**

<b>Fixation</b>	W serration
<b>Mounting</b>	ER 16
<b>Cooling</b>	external, $p_{\max}$ 80 bar
<b>Speed ratio</b>	1:1 (1)
<b>X / Y / Z</b>	70 (2.76) / – / 25.5 (1.004) mm (")

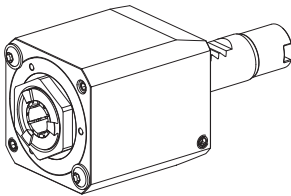

**10848930 Drilling unit**

<b>Fixation</b>	none
<b>Mounting</b>	ER 20
<b>Cooling</b>	internal, $p_{\max}$ 80 bar
<b>Speed ratio</b>	1:1 (1)
<b>X / Y / Z</b>	70 (2.76) / – / – mm (")

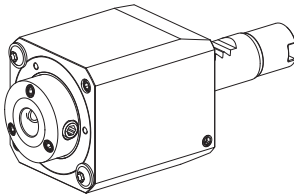

**10890575 Drilling unit**

<b>Fixation</b>	none
<b>Mounting</b>	DIN 1835 B/E D12 (0.47 ")
<b>Cooling</b>	internal, $p_{\max}$ 80 bar
<b>Speed ratio</b>	1:1 (1)
<b>X / Y / Z</b>	77.5 (3.05) / – / – mm (")

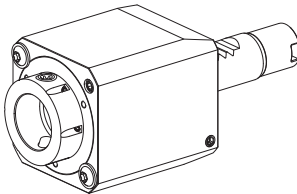

**10646417 Drilling unit**

<b>Fixation</b>	none
<b>Mounting</b>	WFB 24-16
<b>Cooling</b>	internal, $p_{\max}$ 80 bar
<b>Speed ratio</b>	1:1 (1)
<b>X / Y / Z</b>	77 (3.03) / – / – mm (")

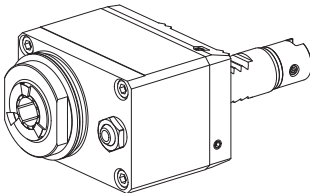

**10246097 Milling unit**

<b>Fixation</b>	W serration
<b>Mounting</b>	ER 20
<b>Cooling</b>	external, $p_{\max}$ 80 bar
<b>Speed ratio</b>	1.94:1 (1.944)
<b>X / Y / Z</b>	70 (2.76) / – / 27 (1.06) mm (")

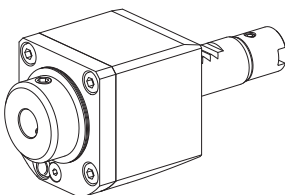

**10411063 Milling unit**

<b>Fixation</b>	none
<b>Mounting</b>	DIN 1835 B/E D12 (0.47 ")
<b>Cooling</b>	external, $p_{\max}$ 80 bar
<b>Speed ratio</b>	1:1 (1)
<b>X / Y / Z</b>	70 (2.76) / – / – mm (")

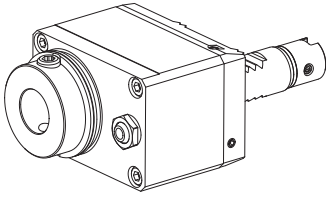

**10643102 Milling unit**

<b>Fixation</b>	W serration
<b>Mounting</b>	DIN 1835 B/E D20 (0.79 ")
<b>Cooling</b>	external, $p_{max}$ 80 bar
<b>Speed ratio</b>	1.94:1 (1.944)
<b>X / Y / Z</b>	76 (2.99) / – / 27 (1.06) mm (")

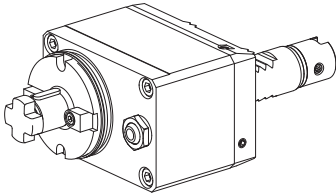

**10202174 Milling unit**

<b>Fixation</b>	W serration
<b>Mounting</b>	Milling shaft D16 (0.63 ")
<b>Cooling</b>	external, $p_{max}$ 80 bar
<b>Speed ratio</b>	1.94:1 (1.944)
<b>X / Y / Z</b>	67 (2.64) / – / 27 (1.06) mm (")

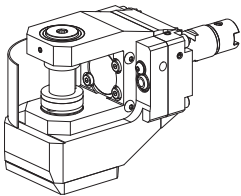

**10051025 Circular saw unit**

<b>Fixation</b>	W serration
<b>Mounting</b>	Milling shaft D16 (0.63 ")
<b>Cooling</b>	external, $p_{max}$ 80 bar
<b>Speed ratio</b>	2.96:1 (2.96)
<b>X / Y / Z</b>	76 (2.99) / – / – mm (")

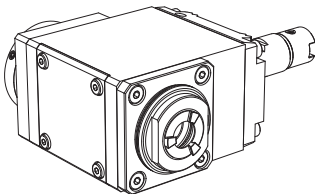

**10966907 Drilling unit**

<b>Fixation</b>	W serration
<b>Mounting</b>	ER 16
<b>Cooling</b>	internal, $p_{max}$ 80 bar
<b>Speed ratio</b>	1:2 (0.5)
<b>X / Y / Z</b>	64 (2.52) / – / 50 (1.97) mm (")

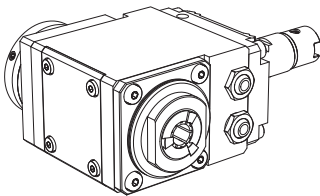

**10354264 Milling unit**

<b>Fixation</b>	W serration
<b>Mounting</b>	ER 16
<b>Cooling</b>	external, internal optional, $p_{max}$ 80 bar
<b>Speed ratio</b>	1:1 (1)
<b>X / Y / Z</b>	64 (2.52) / – / 46.5 (1.83) mm (")

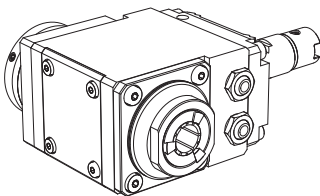

**10105063 Milling unit**

<b>Fixation</b>	W serration
<b>Mounting</b>	ER 20
<b>Cooling</b>	external, internal optional, $p_{max}$ 80 bar
<b>Speed ratio</b>	1:1 (1)
<b>X / Y / Z</b>	64 (2.52) / – / 50.5 (1.99) mm (")

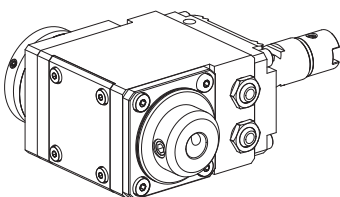

**10062216 Milling unit**

<b>Fixation</b>	W serration
<b>Mounting</b>	D12 (0.47 ")
<b>Cooling</b>	external, internal optional, $p_{max}$ 80 bar
<b>Speed ratio</b>	1:1 (1)
<b>X / Y / Z</b>	64 (2.52) / – / 54 (2.13) mm (")



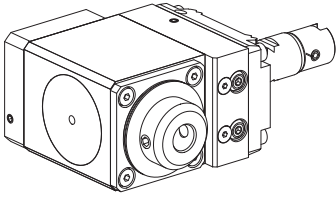

**10354335 Milling unit**

<b>Fixation</b>	W serration
<b>Mounting</b>	D12.7 (0.50 ")
<b>Cooling</b>	internal, $p_{max}$ 80 bar
<b>Speed ratio</b>	1:1 (1)
<b>X / Y / Z</b>	64 (2.52) / – / 50 (1.97) mm (")

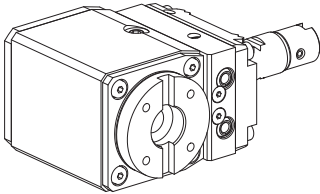

**10393142 Milling unit**

<b>Fixation</b>	W serration
<b>Mounting</b>	–
<b>Cooling</b>	external, $p_{max}$ 80 bar
<b>Speed ratio</b>	2.5:1 (2.5)
<b>X / Y / Z</b>	60 (2.36) / – / 41 (1.61) mm (")

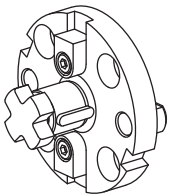

**10670447 Milling cutter holding block**

<b>Fixation</b>	–
<b>Mounting</b>	Milling shaft D13 (0.51 ")
<b>Cooling</b>	–
<b>X / Y / Z</b>	– / – / – mm (")

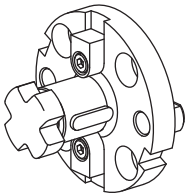

**11041286 Milling cutter holding block**

<b>Fixation</b>	–
<b>Mounting</b>	Milling shaft D16 (0.63 ")
<b>Cooling</b>	–
<b>X / Y / Z</b>	– / – / – mm (")

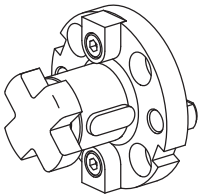

**10435497 Milling cutter holding block**

<b>Fixation</b>	–
<b>Mounting</b>	Milling shaft D22 (0.87 ")
<b>Cooling</b>	–
<b>X / Y / Z</b>	– / – / – mm (")

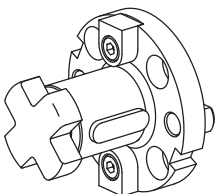

**12011567 Milling cutter holding block**

<b>Fixation</b>	–
<b>Mounting</b>	Milling shaft D22 (0.87 ")
<b>Cooling</b>	–
<b>X / Y / Z</b>	32.5 (1.28) / – / – mm (")

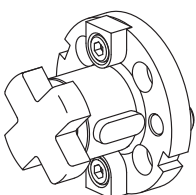

**10807705 Milling cutter holding block**

<b>Fixation</b>	–
<b>Mounting</b>	Milling shaft D27 (1.06 ")
<b>Cooling</b>	–
<b>X / Y / Z</b>	– / – / – mm (")

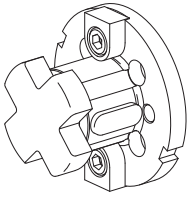

**10223928 Milling cutter holding block**

<b>Fixation</b>	–
<b>Mounting</b>	Milling shaft D32 (1.26 ")
<b>Cooling</b>	–
<b>X / Y / Z</b>	– / – / – mm (")

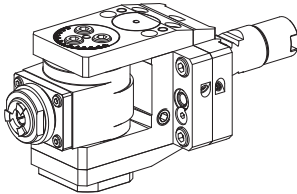

**10593764 Drilling unit**

<b>Fixation</b>	W serration
<b>Mounting</b>	ER 11
<b>Cooling</b>	external, $p_{\max}$ 80 bar
<b>Speed ratio</b>	1:1.88 (0.533)
<b>X / Y / Z</b>	60 (2.36) / – / – mm (")

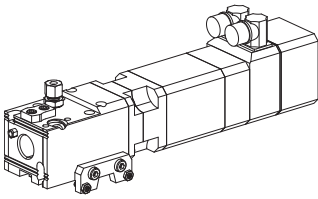

**10872340 Tool drive unit**

<b>Fixation</b>	–
<b>Mounting</b>	VDI 25
<b>Cooling</b>	external and internal, $p_{\max}$ 80 bar
<b>Speed ratio</b>	1:1 (1)
<b>X / Y / Z</b>	– / – / 37 (1.46) mm (")

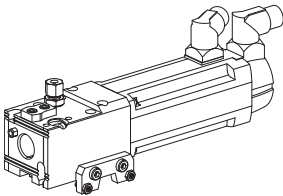

**10024095 Tool drive unit, for control C200-sl**

<b>Fixation</b>	–
<b>Mounting</b>	VDI 25
<b>Cooling</b>	external and internal, $p_{\max}$ 80 bar
<b>Speed ratio</b>	1:1 (1)
<b>X / Y / Z</b>	– / – / – mm (")

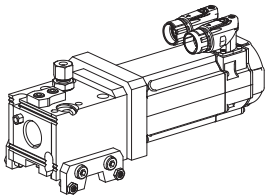

**11010949 Tool drive unit**

<b>Fixation</b>	–
<b>Mounting</b>	VDI 25
<b>Cooling</b>	internal, $p_{\max}$ 30 bar
<b>Speed ratio</b>	1:1 (1)
<b>X / Y / Z</b>	– / – / – mm (")

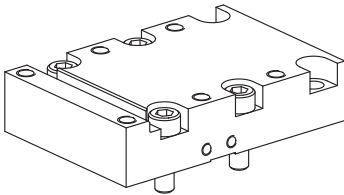

**11094714 Distance plate**

<b>Fixation</b>	–
<b>Mounting</b>	–
<b>Cooling</b>	–
<b>X / Y / Z</b>	– / – / 20 (0.79) mm (")

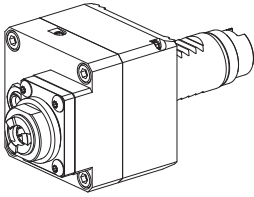

**10898137 Drilling unit**

<b>Fixation</b>	W serration
<b>Mounting</b>	ER 11
<b>Cooling</b>	external, $p_{\max}$ 20 bar
<b>Speed ratio</b>	1:3 (0.333)
<b>X / Y / Z</b>	75 (2.95) / – / 15 (0.59) mm (")

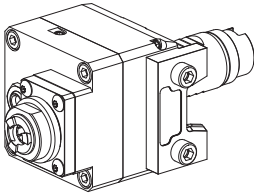

**10418218 Drilling unit**

<b>Fixation</b>	Vee bar
<b>Mounting</b>	ER 11
<b>Cooling</b>	external, $p_{\max}$ 20 bar
<b>Speed ratio</b>	1:3 (0.333)
<b>X / Y / Z</b>	75 (2.95) / – / 15 (0.59) mm (")

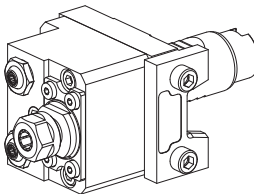

**10648402 Drilling unit**

<b>Fixation</b>	Vee bar
<b>Mounting</b>	ER 11
<b>Cooling</b>	external, $p_{\max}$ 20 bar
<b>Speed ratio</b>	1:1.33 (0.75)
<b>X / Y / Z</b>	71 (2.80) / – / 17.5 (0.69) mm (")

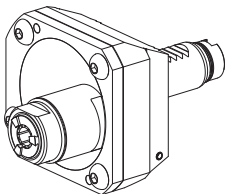

**10444245 Drilling unit, vertically adjustable**

<b>Fixation</b>	W serration
<b>Mounting</b>	ER 16
<b>Cooling</b>	external, $p_{\max}$ 20 bar
<b>Speed ratio</b>	1:2.07 (0.483)
<b>X / Y / Z</b>	85 (3.35) / – / 22.5 (0.89) mm (")

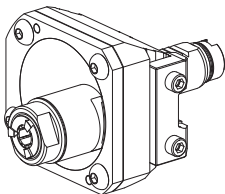

**10701271 Drilling unit, vertically adjustable**

<b>Fixation</b>	Vee bar
<b>Mounting</b>	ER 16
<b>Cooling</b>	external, $p_{\max}$ 20 bar
<b>Speed ratio</b>	1:2.07 (0.483)
<b>X / Y / Z</b>	85 (3.35) / $\pm 22.5$ ( $\pm 0.98$ ) / $\pm 22.5$ ( $\pm 0.89$ ) mm (")

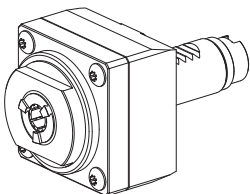

**11050767 Drilling unit**

<b>Fixation</b>	none
<b>Mounting</b>	ER 16
<b>Cooling</b>	external, $p_{\max}$ 80 bar
<b>Speed ratio</b>	1:1 (1)
<b>X / Y / Z</b>	54 (2.13) / – / – mm (")

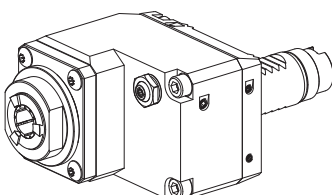

**10205569 Drilling unit**

<b>Fixation</b>	W serration
<b>Mounting</b>	ER 20
<b>Cooling</b>	external and internal, $p_{\max}$ 80 bar
<b>Speed ratio</b>	1:3 (0.333)
<b>X / Y / Z</b>	86.1 (3.39) / – / 35 (1.38) mm (")

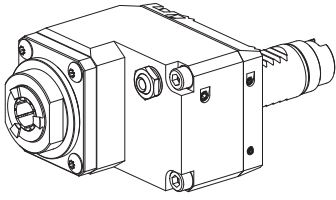

**11005948 Drilling unit**

<b>Fixation</b>	W serration
<b>Mounting</b>	ER 20
<b>Cooling</b>	external, $p_{max}$ 80 bar
<b>Speed ratio</b>	1:3 (0.333)
<b>X / Y / Z</b>	86.1 (3.39) / – / 35 (1.38) mm (")

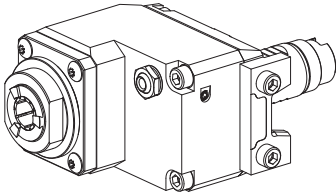

**10385172 Drilling unit**

<b>Fixation</b>	Vee bar
<b>Mounting</b>	ER 20
<b>Cooling</b>	external, $p_{max}$ 80 bar
<b>Speed ratio</b>	1:3 (0.333)
<b>X / Y / Z</b>	86.1 (3.39) / – / 35 (1.38) mm (")

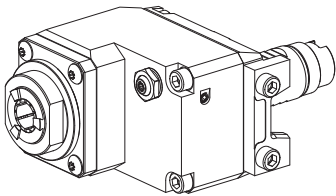

**11016410 Drilling unit**

<b>Fixation</b>	Vee bar
<b>Mounting</b>	ER 20
<b>Cooling</b>	external and internal, $p_{max}$ 80 bar
<b>Speed ratio</b>	1:3 (0.333)
<b>X / Y / Z</b>	86.1 (3.39) / – / 35 (1.38) mm (")

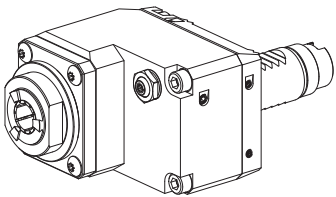

**10380606 Drilling unit**

<b>Fixation</b>	W serration
<b>Mounting</b>	ER 20
<b>Cooling</b>	external and internal, $p_{max}$ 80 bar
<b>Speed ratio</b>	1:2 (0.5)
<b>X / Y / Z</b>	86.1 (3.39) / – / 35 (1.38) mm (")

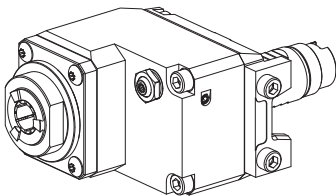

**10767041 Drilling unit**

<b>Fixation</b>	Vee bar
<b>Mounting</b>	ER 20
<b>Cooling</b>	external and internal, $p_{max}$ 80 bar
<b>Speed ratio</b>	1:2 (0.5)
<b>X / Y / Z</b>	86.1 (3.39) / – / 35 (1.38) mm (")

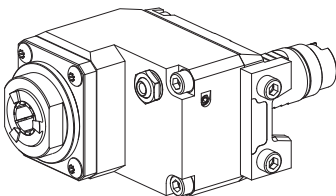

**10892233 Drilling unit**

<b>Fixation</b>	Vee bar
<b>Mounting</b>	ER 20
<b>Cooling</b>	external, $p_{max}$ 80 bar
<b>Speed ratio</b>	1:2 (0.5)
<b>X / Y / Z</b>	86 (3.39) / – / 35 (1.38) mm (")

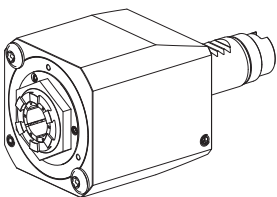

**10506013 Drilling unit**

<b>Fixation</b>	none
<b>Mounting</b>	ER 25
<b>Cooling</b>	internal, $p_{max}$ 80 bar
<b>Speed ratio</b>	1:1 (1)
<b>X / Y / Z</b>	81 (3.19) / – / – mm (")

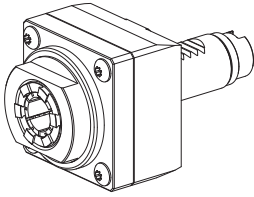

**10828154 Drilling unit**

<b>Fixation</b>	none
<b>Mounting</b>	ER 25
<b>Cooling</b>	external, $p_{\max}$ 80 bar
<b>Speed ratio</b>	1:1 (1)
<b>X / Y / Z</b>	57 (2.24) / - / - mm (")

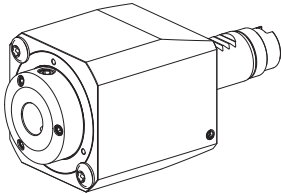

**10161303 Drilling unit**

<b>Fixation</b>	none
<b>Mounting</b>	DIN 1835 B/E D16 (0.63 ")
<b>Cooling</b>	internal, $p_{\max}$ 80 bar
<b>Speed ratio</b>	1:1 (1)
<b>X / Y / Z</b>	89 (3.50) / - / - mm (")

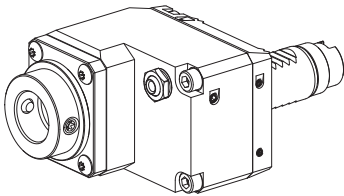

**10415684 Drilling unit**

<b>Fixation</b>	W serration
<b>Mounting</b>	WFB 24-16
<b>Cooling</b>	external, $p_{\max}$ 80 bar
<b>Speed ratio</b>	1:3 (0.333)
<b>X / Y / Z</b>	89.6 (3.53) / - / 35 (1.38) mm (")

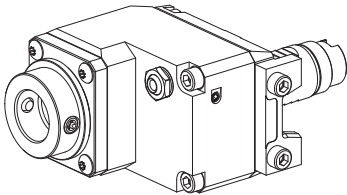

**10535176 Drilling unit**

<b>Fixation</b>	Vee bar
<b>Mounting</b>	WFB 24-16
<b>Cooling</b>	external, $p_{\max}$ 80 bar
<b>Speed ratio</b>	1:3 (0.333)
<b>X / Y / Z</b>	89.6 (3.53) / - / 35 (1.38) mm (")

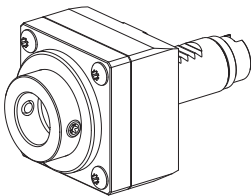

**10275970 Drilling unit**

<b>Fixation</b>	none
<b>Mounting</b>	WFB 24-16
<b>Cooling</b>	external, $p_{\max}$ 80 bar
<b>Speed ratio</b>	1:1 (1)
<b>X / Y / Z</b>	59 (2.32) / - / - mm (")

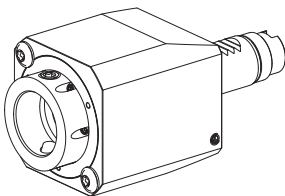

**10857273 Drilling unit**

<b>Fixation</b>	none
<b>Mounting</b>	WFB 32-20
<b>Cooling</b>	internal, $p_{\max}$ 80 bar
<b>Speed ratio</b>	1:1 (1)
<b>X / Y / Z</b>	90 (3.54) / - / - mm (")

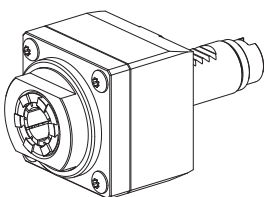

**11067030 Milling unit**

<b>Fixation</b>	none
<b>Mounting</b>	ER 25
<b>Cooling</b>	external, $p_{\max}$ 80 bar
<b>Speed ratio</b>	1:1 (1)
<b>X / Y / Z</b>	67 (2.64) / - / - mm (")

# Live tool holder Shank VDI25

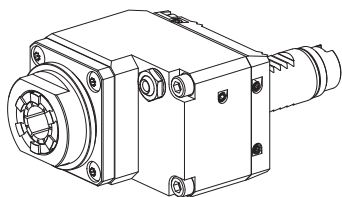

## 10716400 Milling unit

<b>Fixation</b>	W serration
<b>Mounting</b>	ER 25
<b>Cooling</b>	external and internal, $p_{\max}$ 80 bar
<b>Speed ratio</b>	1:1 (1)
<b>X / Y / Z</b>	89.9 (3.54) / – / 31 (1.22) mm (")

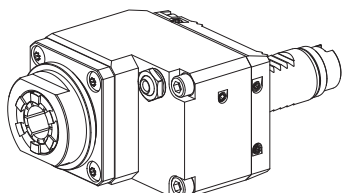

## 10991401 Milling unit

<b>Fixation</b>	W serration
<b>Mounting</b>	ER 25
<b>Cooling</b>	external, $p_{\max}$ 80 bar
<b>Speed ratio</b>	1:1 (1)
<b>X / Y / Z</b>	89.9 (3.54) / – / 31 (1.22) mm (")

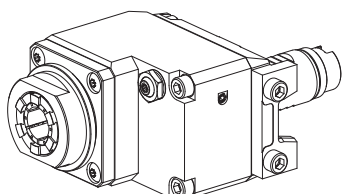

## 10031272 Milling unit

<b>Fixation</b>	Vee bar
<b>Mounting</b>	ER 25
<b>Cooling</b>	external and internal, $p_{\max}$ 80 bar
<b>Speed ratio</b>	1:1 (1)
<b>X / Y / Z</b>	89.9 (3.54) / – / 31 (1.22) mm (")

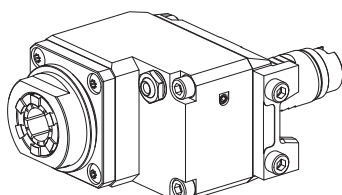

## 11030759 Milling unit

<b>Fixation</b>	Vee bar
<b>Mounting</b>	ER 25
<b>Cooling</b>	external, $p_{\max}$ 80 bar
<b>Speed ratio</b>	1:1 (1)
<b>X / Y / Z</b>	90 (3.54) / – / 31 (1.22) mm (")

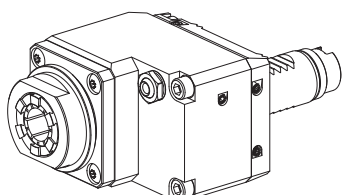

## 10265219 Milling unit

<b>Fixation</b>	W serration
<b>Mounting</b>	ER 25
<b>Cooling</b>	external, $p_{\max}$ 80 bar
<b>Speed ratio</b>	2:1 (2)
<b>X / Y / Z</b>	89.9 (3.54) / – / 31 (1.22) mm (")

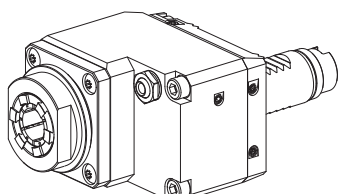

## 10322749 Milling unit

<b>Fixation</b>	W serration
<b>Mounting</b>	ER 25
<b>Cooling</b>	external and internal, $p_{\max}$ 80 bar
<b>Speed ratio</b>	2:1 (2)
<b>X / Y / Z</b>	89.9 (3.54) / – / 31 (1.22) mm (")

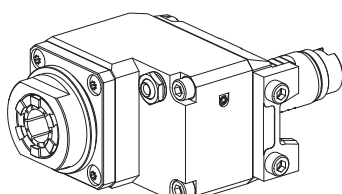

## 10907448 Milling unit

<b>Fixation</b>	Vee bar
<b>Mounting</b>	ER 25
<b>Cooling</b>	external, $p_{\max}$ 80 bar
<b>Speed ratio</b>	2:1 (2)
<b>X / Y / Z</b>	90 (3.54) / – / 31 (1.22) mm (")

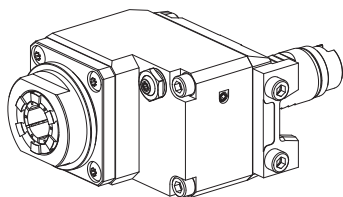

**10987856 Milling unit**

<b>Fixation</b>	Vee bar
<b>Mounting</b>	ER 25
<b>Cooling</b>	external and internal, $p_{\max}$ 80 bar
<b>Speed ratio</b>	2:1 (2)
<b>X / Y / Z</b>	89.9 (3.54) / – / 31 (1.22) mm (")

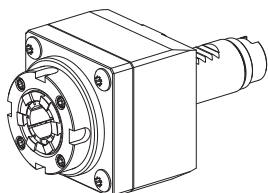

**10292861 Milling unit**

<b>Fixation</b>	none
<b>Mounting</b>	ER 25 PRECI-FLEX
<b>Cooling</b>	external, $p_{\max}$ 80 bar
<b>Speed ratio</b>	1:1 (1)
<b>X / Y / Z</b>	67 (2.64) / – / – mm (")

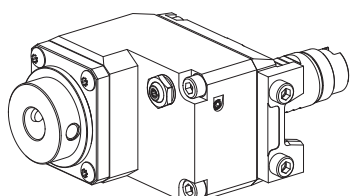

**10748355 Milling unit**

<b>Fixation</b>	Vee bar
<b>Mounting</b>	DIN 1835 B/E D15 (0.59 ")
<b>Cooling</b>	external and internal, $p_{\max}$ 80 bar
<b>Speed ratio</b>	1:2 (0.5)
<b>X / Y / Z</b>	89.6 (3.53) / – / 35 (1.38) mm (")

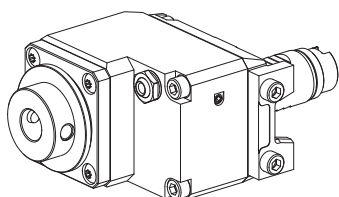

**10345067 Milling unit**

<b>Fixation</b>	Vee bar
<b>Mounting</b>	DIN 1835 B/E D15 (0.59 ")
<b>Cooling</b>	external, $p_{\max}$ 80 bar
<b>Speed ratio</b>	1:1 (1)
<b>X / Y / Z</b>	91 (3.58) / – / 31 (1.22) mm (")

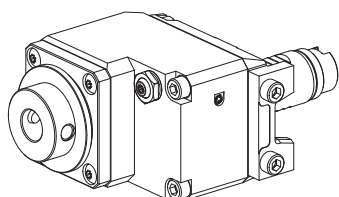

**10409453 Milling unit**

<b>Fixation</b>	Vee bar
<b>Mounting</b>	DIN 1835 B/E D15 (0.59 ")
<b>Cooling</b>	external and internal, $p_{\max}$ 80 bar
<b>Speed ratio</b>	1:1 (1)
<b>X / Y / Z</b>	90.9 (3.58) / – / 31 (1.22) mm (")

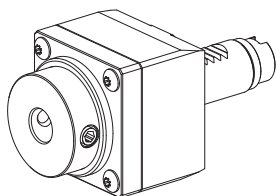

**10202307 Milling unit**

<b>Fixation</b>	none
<b>Mounting</b>	DIN 1835 B/E D16 (0.63 ")
<b>Cooling</b>	external, $p_{\max}$ 80 bar
<b>Speed ratio</b>	1:1 (1)
<b>X / Y / Z</b>	72 (2.83) / – / – mm (")

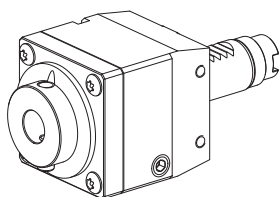

**11063004 Milling unit**

<b>Fixation</b>	–
<b>Mounting</b>	DIN 1835 B/E D16 (0.63 ")
<b>Cooling</b>	external, $p_{\max}$ 20 bar
<b>Speed ratio</b>	4.5:1 (4.5)
<b>X / Y / Z</b>	83.5 (3.29) / – / 0 ( ) mm (")



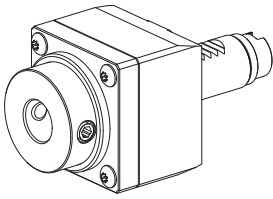

**10307933 Milling unit**

<b>Fixation</b>	none
<b>Mounting</b>	DIN 1835 B/E D20 (0.79 ")
<b>Cooling</b>	external, $p_{max}$ 80 bar
<b>Speed ratio</b>	1:1 (1)
<b>X / Y / Z</b>	72 (2.83) / - / - mm (")

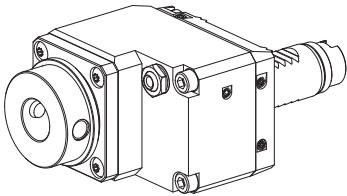

**10719900 Milling unit**

<b>Fixation</b>	W serration
<b>Mounting</b>	DIN 1835 B/E D20 (0.79 ")
<b>Cooling</b>	external, $p_{max}$ 20 bar
<b>Speed ratio</b>	2:1 (2)
<b>X / Y / Z</b>	93 (3.66) / - / 31 (1.22) mm (")

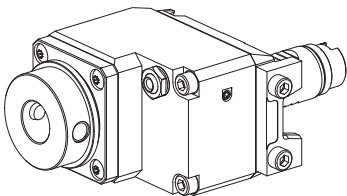

**10642666 Milling unit**

<b>Fixation</b>	Vee bar
<b>Mounting</b>	DIN 1835 B/E D20 (0.79 ")
<b>Cooling</b>	external, $p_{max}$ 80 bar
<b>Speed ratio</b>	2:1 (2)
<b>X / Y / Z</b>	93 (3.66) / - / 31 (1.22) mm (")

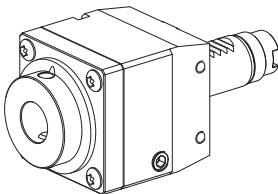

**10591979 Milling unit**

<b>Fixation</b>	none
<b>Mounting</b>	DIN 1835 B/E D20 (0.79 ")
<b>Cooling</b>	external, $p_{max}$ 20 bar
<b>Speed ratio</b>	4.5:1 (4.5)
<b>X / Y / Z</b>	83.5 (3.29) / - / 0 ( ) mm (")

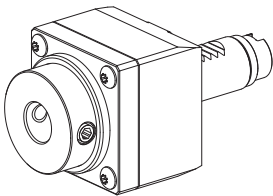

**10857236 Milling unit**

<b>Fixation</b>	none
<b>Mounting</b>	DIN 1835 B/E D3/4"
<b>Cooling</b>	external, $p_{max}$ 80 bar
<b>Speed ratio</b>	1:1 (1)
<b>X / Y / Z</b>	72 (2.83) / - / - mm (")

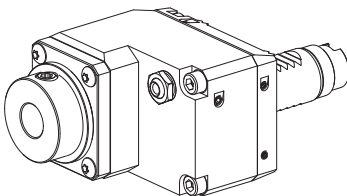

**10136933 Milling unit**

<b>Fixation</b>	W serration
<b>Mounting</b>	D16 (0.63 ")
<b>Cooling</b>	external, $p_{max}$ 80 bar
<b>Speed ratio</b>	1:2 (0.5)
<b>X / Y / Z</b>	92 (3.62) / - / 35 (1.38) mm (")

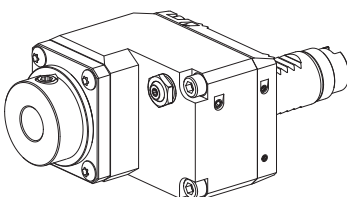

**10410570 Milling unit**

<b>Fixation</b>	W serration
<b>Mounting</b>	D16 (0.63 ")
<b>Cooling</b>	external and internal, $p_{max}$ 80 bar
<b>Speed ratio</b>	1:2 (0.5)
<b>X / Y / Z</b>	92 (3.62) / - / 35 (1.38) mm (")

# Live tool holder Shank VDI25

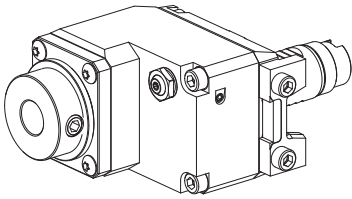

## 10480988 Milling unit

<b>Fixation</b>	Vee bar
<b>Mounting</b>	D16 (0.63 ")
<b>Cooling</b>	external and internal, $p_{max}$ 80 bar
<b>Speed ratio</b>	1:2 (0.5)
<b>X / Y / Z</b>	92 (3.62) / – / 35 (1.38) mm (")

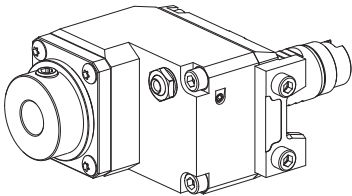

## 10790396 Milling unit

<b>Fixation</b>	Vee bar
<b>Mounting</b>	D16 (0.63 ")
<b>Cooling</b>	external, $p_{max}$ 80 bar
<b>Speed ratio</b>	1:2 (0.5)
<b>X / Y / Z</b>	92 (3.62) / – / 35 (1.38) mm (")

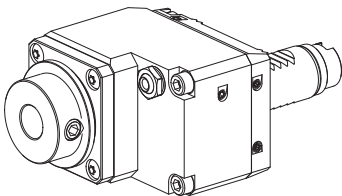

## 10420233 Milling unit

<b>Fixation</b>	W serration
<b>Mounting</b>	D16 (0.63 ")
<b>Cooling</b>	external and internal, $p_{max}$ 80 bar
<b>Speed ratio</b>	1:1 (1)
<b>X / Y / Z</b>	93 (3.66) / – / 31 (1.22) mm (")

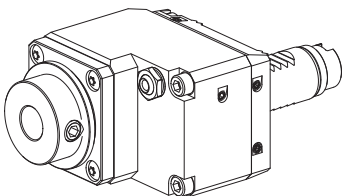

## 11062897 Milling unit

<b>Fixation</b>	W serration
<b>Mounting</b>	D16 (0.63 ")
<b>Cooling</b>	external, $p_{max}$ 80 bar
<b>Speed ratio</b>	1:1 (1)
<b>X / Y / Z</b>	93 (3.66) / – / 31 (1.22) mm (")

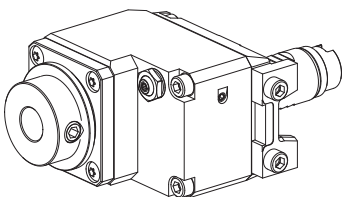

## 10860043 Milling unit

<b>Fixation</b>	Vee bar
<b>Mounting</b>	D16 (0.63 ")
<b>Cooling</b>	external and internal, $p_{max}$ 80 bar
<b>Speed ratio</b>	1:1 (1)
<b>X / Y / Z</b>	93 (3.66) / – / 31 (1.22) mm (")

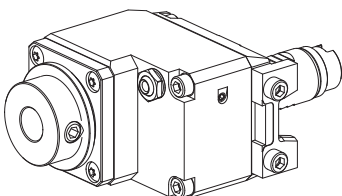

## 11043249 Milling unit

<b>Fixation</b>	Vee bar
<b>Mounting</b>	D16 (0.63 ")
<b>Cooling</b>	external, $p_{max}$ 80 bar
<b>Speed ratio</b>	1:1 (1)
<b>X / Y / Z</b>	93 (3.66) / – / 31 (1.22) mm (")

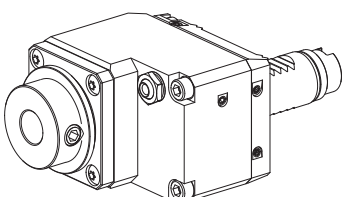

## 10038392 Milling unit

<b>Fixation</b>	W serration
<b>Mounting</b>	D16 (0.63 ")
<b>Cooling</b>	external and internal, $p_{max}$ 80 bar
<b>Speed ratio</b>	2:1 (2)
<b>X / Y / Z</b>	93 (3.66) / – / 31 (1.22) mm (")

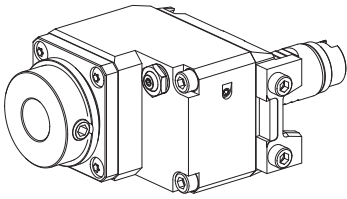

**11090796 Milling unit**

<b>Fixation</b>	Vee bar
<b>Mounting</b>	D20 (0.79 ")
<b>Cooling</b>	internal, $p_{max}$ 80 bar
<b>Speed ratio</b>	2:1 (2)
<b>X / Y / Z</b>	93 (3.66) / - / 31 (1.22) mm (")

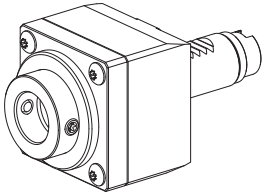

**10801026 Milling unit**

<b>Fixation</b>	none
<b>Mounting</b>	WFB 24-16
<b>Cooling</b>	external, $p_{max}$ 80 bar
<b>Speed ratio</b>	1:1 (1)
<b>X / Y / Z</b>	69 (2.72) / - / - mm (")

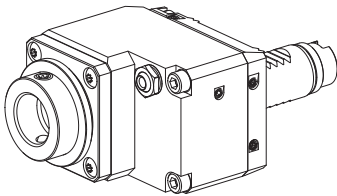

**10061745 Milling unit**

<b>Fixation</b>	W serration
<b>Mounting</b>	WFB 24-16
<b>Cooling</b>	external, $p_{max}$ 80 bar
<b>Speed ratio</b>	2:1 (2)
<b>X / Y / Z</b>	91.4 (3.60) / - / 31 (1.22) mm (")

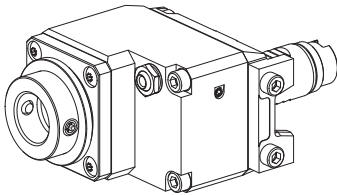

**10411900 Milling unit**

<b>Fixation</b>	Vee bar
<b>Mounting</b>	WFB 24-16
<b>Cooling</b>	external, $p_{max}$ 80 bar
<b>Speed ratio</b>	2:1 (2)
<b>X / Y / Z</b>	91 (3.58) / - / 31 (1.22) mm (")

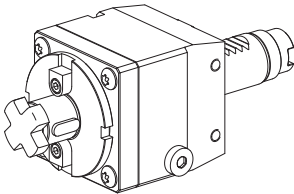

**10425512 Milling unit**

<b>Fixation</b>	none
<b>Mounting</b>	Milling shaft D22 (0.87 ")
<b>Cooling</b>	external, $p_{max}$ 20 bar
<b>Speed ratio</b>	4.5:1 (4.5)
<b>X / Y / Z</b>	73.5 (2.89) / - / 0 ( ) mm (")

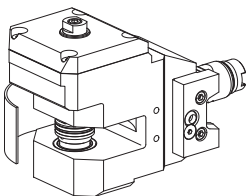

**10403930 Circular saw unit, vertically adjustable**

<b>Fixation</b>	Vee bar
<b>Mounting</b>	Milling shaft D16 (0.63 ")
<b>Cooling</b>	external, $p_{max}$ 20 bar
<b>Speed ratio</b>	2.05:1 (2.05)
<b>X / Y / Z</b>	79.5 (3.13) / - / - mm (")

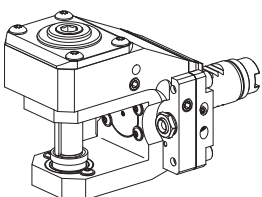

**10546310 Circular saw unit**

<b>Fixation</b>	W serration
<b>Mounting</b>	Milling shaft D16 (0.63 ")
<b>Cooling</b>	external, $p_{max}$ 80 bar
<b>Speed ratio</b>	3.5:1 (3.5)
<b>X / Y / Z</b>	79 (3.11) / - / - mm (")

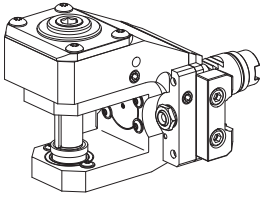

**10444685 Circular saw unit**

<b>Fixation</b>	Vee bar
<b>Mounting</b>	Milling shaft D16 (0.63 ")
<b>Cooling</b>	external, $p_{\max}$ 80 bar
<b>Speed ratio</b>	3.5:1 (3.5)
<b>X / Y / Z</b>	79 (3.11) / - / - mm (")

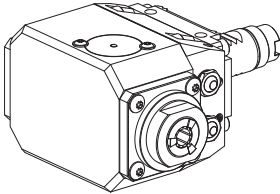

**10793977 Drilling unit**

<b>Fixation</b>	W serration
<b>Mounting</b>	ER 16
<b>Cooling</b>	external, internal optional, $p_{\max}$ 80 bar
<b>Speed ratio</b>	1:2.88 (0.347)
<b>X / Y / Z</b>	70 (2.76) / - / 80 (3.15) mm (")

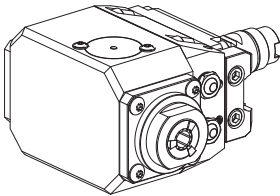

**10293075 Drilling unit**

<b>Fixation</b>	Vee bar
<b>Mounting</b>	ER 16
<b>Cooling</b>	external, internal optional, $p_{\max}$ 80 bar
<b>Speed ratio</b>	1:2.88 (0.347)
<b>X / Y / Z</b>	70 (2.76) / - / 80 (3.15) mm (")

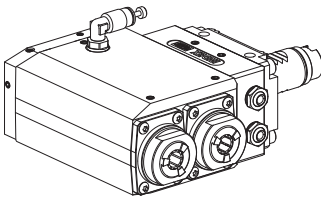

**10037360 Drilling unit**

<b>Fixation</b>	W serration
<b>Mounting</b>	ER 16
<b>Cooling</b>	external, $p_{\max}$ 80 bar
<b>Speed ratio</b>	1:2 (0.5)
<b>X / Y / Z</b>	70 + 110 (2.76 + 4.33) / - / 71.3 (2.81) mm (")

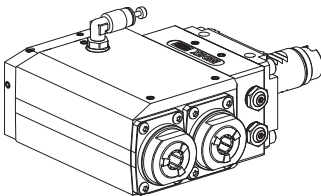

**10163263 Drilling unit**

<b>Fixation</b>	W serration
<b>Mounting</b>	ER 16
<b>Cooling</b>	internal, $p_{\max}$ 80 bar
<b>Speed ratio</b>	1:2 (0.5)
<b>X / Y / Z</b>	70 + 110 (2.76 + 4.33) / - / 71.3 (2.81) mm (")

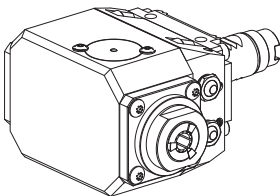

**10363369 Drilling unit**

<b>Fixation</b>	W serration
<b>Mounting</b>	ER 16
<b>Cooling</b>	external, internal optional, $p_{\max}$ 80 bar
<b>Speed ratio</b>	1:2 (0.5)
<b>X / Y / Z</b>	70 (2.76) / - / 80 (3.15) mm (")

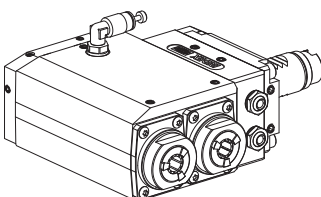

**10115327 Drilling unit**

<b>Fixation</b>	Vee bar
<b>Mounting</b>	ER 16
<b>Cooling</b>	external, $p_{\max}$ 80 bar
<b>Speed ratio</b>	1:2 (0.5)
<b>X / Y / Z</b>	70 + 110 (2.76 + 4.33) / - / 71 (2.80) mm (")

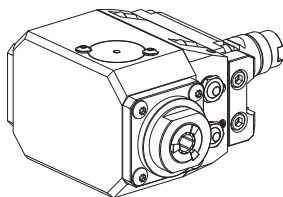

**10298225 Drilling unit**

<b>Fixation</b>	Vee bar
<b>Mounting</b>	ER 16
<b>Cooling</b>	external, internal optional, $p_{max}$ 80 bar
<b>Speed ratio</b>	1:2 (0.5)
<b>X / Y / Z</b>	70 (2.76) / – / 80 (3.15) mm (")

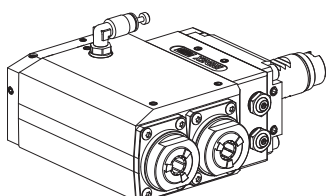

**10835385 Drilling unit**

<b>Fixation</b>	Vee bar
<b>Mounting</b>	ER 16
<b>Cooling</b>	internal, $p_{max}$ 80 bar
<b>Speed ratio</b>	1:2 (0.5)
<b>X / Y / Z</b>	70 + 110 (2.76 + 4.33) / – / 71.3 (2.81) mm (")

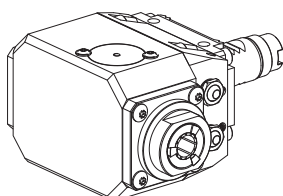

**11064426 Drilling unit**

<b>Fixation</b>	W serration
<b>Mounting</b>	ER 20
<b>Cooling</b>	external, internal optional, $p_{max}$ 80 bar
<b>Speed ratio</b>	1:2 (0.5)
<b>X / Y / Z</b>	70 (2.76) / – / 80 (3.15) mm (")

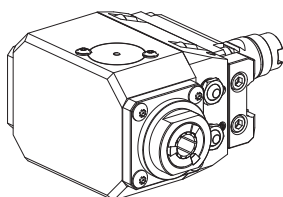

**10303082 Drilling unit**

<b>Fixation</b>	Vee bar
<b>Mounting</b>	ER 20
<b>Cooling</b>	external, internal optional, $p_{max}$ 80 bar
<b>Speed ratio</b>	1:2 (0.5)
<b>X / Y / Z</b>	70 (2.76) / – / 80 (3.15) mm (")

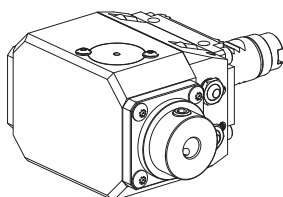

**10180528 Drilling unit**

<b>Fixation</b>	W serration
<b>Mounting</b>	DIN 1835 B/E D12 (0.47 ")
<b>Cooling</b>	external, internal optional, $p_{max}$ 80 bar
<b>Speed ratio</b>	1:2.88 (0.347)
<b>X / Y / Z</b>	70 (2.76) / – / 85.5 (3.37) mm (")

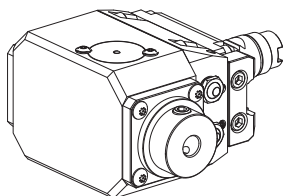

**10826106 Drilling unit**

<b>Fixation</b>	Vee bar
<b>Mounting</b>	DIN 1835 B/E D12 (0.47 ")
<b>Cooling</b>	external, internal optional, $p_{max}$ 80 bar
<b>Speed ratio</b>	1:2.88 (0.347)
<b>X / Y / Z</b>	70 (2.76) / – / 85.5 (3.37) mm (")

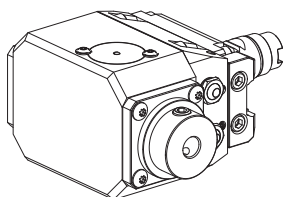

**10665790 Drilling unit**

<b>Fixation</b>	Vee bar
<b>Mounting</b>	DIN 1835 B/E D12 (0.47 ")
<b>Cooling</b>	external, internal optional, $p_{max}$ 80 bar
<b>Speed ratio</b>	1:2 (0.5)
<b>X / Y / Z</b>	70 (2.76) / – / 85.5 (3.37) mm (")

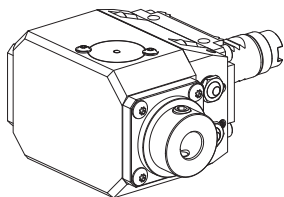

#### 10822454 Drilling unit

<b>Fixation</b>	W serration
<b>Mounting</b>	DIN 1835 B/E D16 (0.63 ")
<b>Cooling</b>	external, internal optional, $p_{\max}$ 80 bar
<b>Speed ratio</b>	1:2 (0.5)
<b>X / Y / Z</b>	70 (2.76) / – / 85.5 (3.37) mm (")

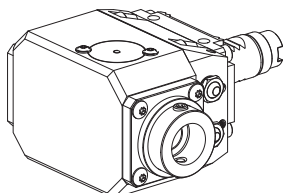

#### 11024822 Drilling unit

<b>Fixation</b>	W serration
<b>Mounting</b>	WFB 24-16
<b>Cooling</b>	external, internal optional, $p_{\max}$ 80 bar
<b>Speed ratio</b>	1:2.88 (0.347)
<b>X / Y / Z</b>	70 (2.76) / – / 82.5 (3.25) mm (")

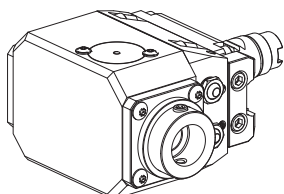

#### 10860091 Drilling unit

<b>Fixation</b>	Vee bar
<b>Mounting</b>	WFB 24-16
<b>Cooling</b>	external, internal optional, $p_{\max}$ 80 bar
<b>Speed ratio</b>	1:2.88 (0.347)
<b>X / Y / Z</b>	70 (2.76) / – / 82.5 (3.25) mm (")

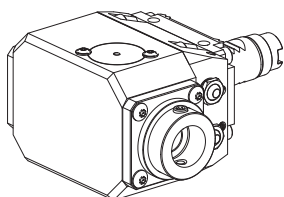

#### 10592359 Drilling unit

<b>Fixation</b>	W serration
<b>Mounting</b>	WFB 24-16
<b>Cooling</b>	external, internal optional, $p_{\max}$ 80 bar
<b>Speed ratio</b>	1:2 (0.5)
<b>X / Y / Z</b>	70 (2.76) / – / 82.5 (3.25) mm (")

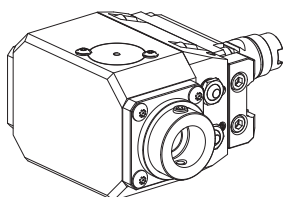

#### 10512409 Drilling unit

<b>Fixation</b>	Vee bar
<b>Mounting</b>	WFB 24-16
<b>Cooling</b>	external, internal optional, $p_{\max}$ 80 bar
<b>Speed ratio</b>	1:2 (0.5)
<b>X / Y / Z</b>	70 (2.76) / – / 82.5 (3.25) mm (")

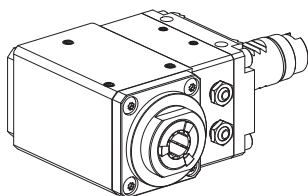

#### 10017916 Milling unit

<b>Fixation</b>	W serration
<b>Mounting</b>	ER 20
<b>Cooling</b>	external, internal optional, $p_{\max}$ 80 bar
<b>Speed ratio</b>	1:1 (1)
<b>X / Y / Z</b>	70 (2.76) / – / 60.5 (2.38) mm (")

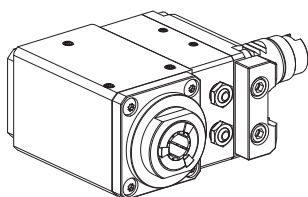

#### 10111860 Milling unit

<b>Fixation</b>	Vee bar
<b>Mounting</b>	ER 20
<b>Cooling</b>	external, internal optional, $p_{\max}$ 80 bar
<b>Speed ratio</b>	1:1 (1)
<b>X / Y / Z</b>	70 (2.76) / – / 61 (2.40) mm (")

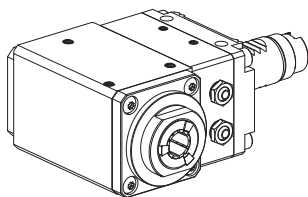

**10362884 Milling unit**

<b>Fixation</b>	W serration
<b>Mounting</b>	ER 20
<b>Cooling</b>	external, internal optional, $p_{max}$ 80 bar
<b>Speed ratio</b>	2:1 (2)
<b>X / Y / Z</b>	70 (2.76) / – / 61 (2.40) mm (")

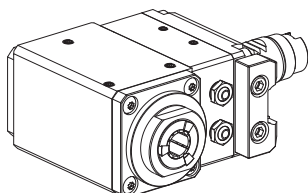

**10356084 Milling unit**

<b>Fixation</b>	Vee bar
<b>Mounting</b>	ER 20
<b>Cooling</b>	external, internal optional, $p_{max}$ 80 bar
<b>Speed ratio</b>	2:1 (2)
<b>X / Y / Z</b>	70 (2.76) / – / 60.5 (2.38) mm (")

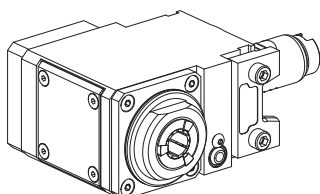

**10764640 Milling unit**

<b>Fixation</b>	Vee bar
<b>Mounting</b>	ER 20
<b>Cooling</b>	external, internal optional, $p_{max}$ 20 bar
<b>Speed ratio</b>	2:1 (2)
<b>X / Y / Z</b>	70 (2.76) / – / 53 (2.09) mm (")

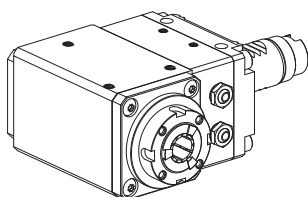

**10689846 Milling unit**

<b>Fixation</b>	W serration
<b>Mounting</b>	ER 20 PRECI-FLEX
<b>Cooling</b>	external, internal optional, $p_{max}$ 80 bar
<b>Speed ratio</b>	1:1 (1)
<b>X / Y / Z</b>	70 (2.76) / – / 63 (2.48) mm (")

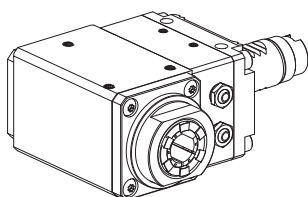

**10392320 Milling unit**

<b>Fixation</b>	W serration
<b>Mounting</b>	ER 25
<b>Cooling</b>	external, internal optional, $p_{max}$ 80 bar
<b>Speed ratio</b>	1:1 (1)
<b>X / Y / Z</b>	70 (2.76) / – / 64 (2.52) mm (")

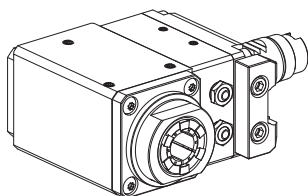

**10892159 Milling unit**

<b>Fixation</b>	Vee bar
<b>Mounting</b>	ER 25
<b>Cooling</b>	external, internal optional, $p_{max}$ 80 bar
<b>Speed ratio</b>	1:1 (1)
<b>X / Y / Z</b>	70 (2.76) / – / 64 (2.52) mm (")

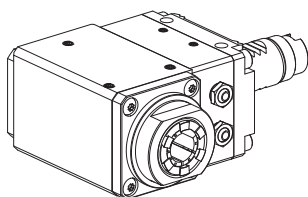

**10079110 Milling unit**

<b>Fixation</b>	W serration
<b>Mounting</b>	ER 25
<b>Cooling</b>	external, internal optional, $p_{max}$ 80 bar
<b>Speed ratio</b>	2:1 (2)
<b>X / Y / Z</b>	70 (2.76) / – / 64 (2.52) mm (")



# Live tool holder Shank VDI25

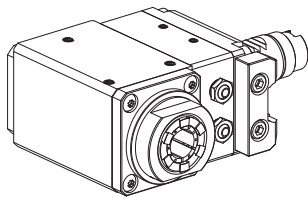

## 10941580 Milling unit

<b>Fixation</b>	Vee bar
<b>Mounting</b>	ER 25
<b>Cooling</b>	external, internal optional, $p_{\max}$ 80 bar
<b>Speed ratio</b>	2:1 (2)
<b>X / Y / Z</b>	70 (2.76) / – / 64 (2.52) mm (")

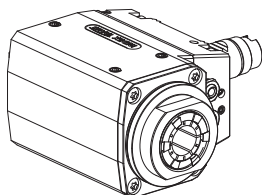

## 11164790 Milling unit

<b>Fixation</b>	W serration
<b>Mounting</b>	ER 32
<b>Cooling</b>	external, internal optional, $p_{\max}$ 80 bar
<b>Speed ratio</b>	1:1 (1)
<b>X / Y / Z</b>	70 (2.76) / – / 90 (3.54) mm (")

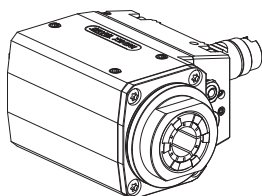

## 11164783 Milling unit

<b>Fixation</b>	W serration
<b>Mounting</b>	ER 32
<b>Cooling</b>	external, internal optional, $p_{\max}$ 80 bar
<b>Speed ratio</b>	2:1 (2)
<b>X / Y / Z</b>	70 (2.76) / – / 90 (3.54) mm (")

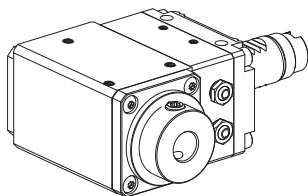

## 10425542 Milling unit

<b>Fixation</b>	W serration
<b>Mounting</b>	DIN 1835 B/E D16 (0.63 ")
<b>Cooling</b>	external, internal optional, $p_{\max}$ 80 bar
<b>Speed ratio</b>	1:1 (1)
<b>X / Y / Z</b>	70 (2.76) / – / 67 (2.64) mm (")

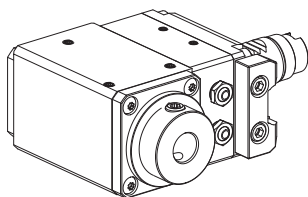

## 10517132 Milling unit

<b>Fixation</b>	Vee bar
<b>Mounting</b>	DIN 1835 B/E D16 (0.63 ")
<b>Cooling</b>	external, internal optional, $p_{\max}$ 80 bar
<b>Speed ratio</b>	1:1 (1)
<b>X / Y / Z</b>	70 (2.76) / – / 67 (2.64) mm (")

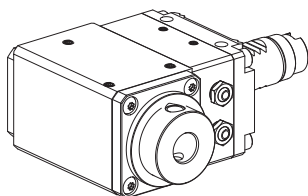

## 10702769 Milling unit

<b>Fixation</b>	W serration
<b>Mounting</b>	DIN 1835 B/E D16 (0.63 ")
<b>Cooling</b>	external, internal optional, $p_{\max}$ 80 bar
<b>Speed ratio</b>	2:1 (2)
<b>X / Y / Z</b>	70 (2.76) / – / 67 (2.64) mm (")

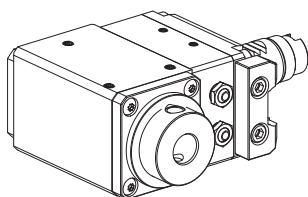

## 10344410 Milling unit

<b>Fixation</b>	Vee bar
<b>Mounting</b>	DIN 1835 B/E D16 (0.63 ")
<b>Cooling</b>	external, internal optional, $p_{\max}$ 80 bar
<b>Speed ratio</b>	2:1 (2)
<b>X / Y / Z</b>	70 (2.76) / – / 67 (2.64) mm (")



# Live tool holder Shank VDI25

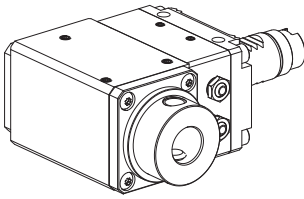

## 10444044 Milling unit

<b>Fixation</b>	W serration
<b>Mounting</b>	DIN 1835 B/E D20 (0.79 ")
<b>Cooling</b>	external, internal optional, $p_{\max}$ 80 bar
<b>Speed ratio</b>	2:1 (2)
<b>X / Y / Z</b>	70 (2.76) / – / 71 (2.80) mm (")

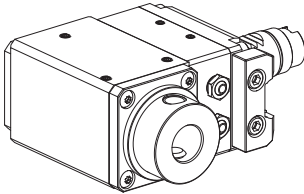

## 10975060 Milling unit

<b>Fixation</b>	Vee bar
<b>Mounting</b>	DIN 1835 B/E D20 (0.79 ")
<b>Cooling</b>	external, internal optional, $p_{\max}$ 80 bar
<b>Speed ratio</b>	2:1 (2)
<b>X / Y / Z</b>	70 (2.76) / – / 71 (2.80) mm (")

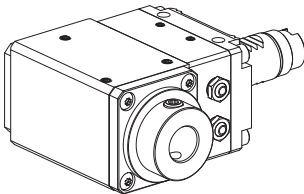

## 10721543 Milling unit

<b>Fixation</b>	W serration
<b>Mounting</b>	DIN 1835 B/E D3/4"
<b>Cooling</b>	external, internal optional, $p_{\max}$ 80 bar
<b>Speed ratio</b>	1:1 (1)
<b>X / Y / Z</b>	69.5 (2.74) / – / 68.5 (2.70) mm (")

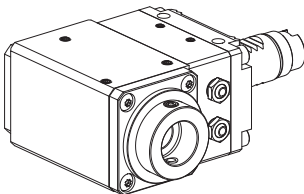

## 10169413 Milling unit

<b>Fixation</b>	W serration
<b>Mounting</b>	WFB 24-16
<b>Cooling</b>	external, internal optional, $p_{\max}$ 80 bar
<b>Speed ratio</b>	1:1 (1)
<b>X / Y / Z</b>	70 (2.76) / – / 64.5 (2.54) mm (")

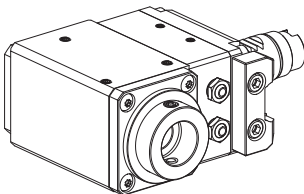

## 10193100 Milling unit

<b>Fixation</b>	Vee bar
<b>Mounting</b>	WFB 24-16
<b>Cooling</b>	external, internal optional, $p_{\max}$ 80 bar
<b>Speed ratio</b>	1:1 (1)
<b>X / Y / Z</b>	70 (2.76) / – / 64.5 (2.54) mm (")

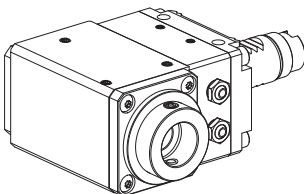

## 10216902 Milling unit

<b>Fixation</b>	W serration
<b>Mounting</b>	WFB 24-16
<b>Cooling</b>	external, internal optional, $p_{\max}$ 80 bar
<b>Speed ratio</b>	2:1 (2)
<b>X / Y / Z</b>	70 (2.76) / – / 64.5 (2.54) mm (")

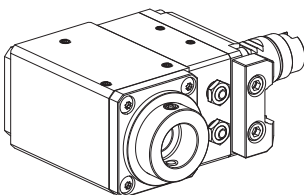

## 10196660 Milling unit

<b>Fixation</b>	Vee bar
<b>Mounting</b>	WFB 24-16
<b>Cooling</b>	external, internal optional, $p_{\max}$ 80 bar
<b>Speed ratio</b>	2:1 (2)
<b>X / Y / Z</b>	70 (2.76) / – / 64.5 (2.54) mm (")

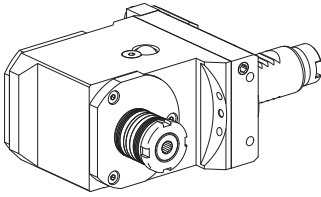

**10305967 Milling unit**

<b>Fixation</b>	Vee bar
<b>Mounting</b>	Milling shaft D16 (0.63 ")
<b>Cooling</b>	external, $p_{max}$ 20 bar
<b>Speed ratio</b>	2.36:1 (2.36)
<b>X / Y / Z</b>	73 (2.87) / – / 17 (0.67) mm (")

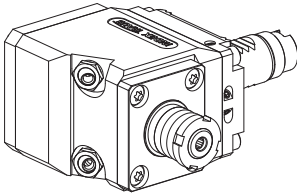

**10483871 Milling unit**

<b>Fixation</b>	W serration
<b>Mounting</b>	Milling shaft D16 (0.63 ")
<b>Cooling</b>	external, $p_{max}$ 80 bar
<b>Speed ratio</b>	2.5:1 (2.5)
<b>X / Y / Z</b>	55 (2.17) / – / 45 (1.77) mm (")

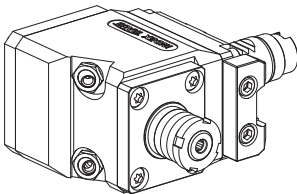

**10272736 Milling unit**

<b>Fixation</b>	Vee bar
<b>Mounting</b>	Milling shaft D16 (0.63 ")
<b>Cooling</b>	external, $p_{max}$ 80 bar
<b>Speed ratio</b>	2.5:1 (2.5)
<b>X / Y / Z</b>	55 (2.17) / – / 45 (1.77) mm (")

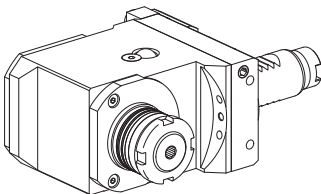

**10783835 Milling unit**

<b>Fixation</b>	Vee bar
<b>Mounting</b>	Milling shaft D22 (0.87 ")
<b>Cooling</b>	external, $p_{max}$ 20 bar
<b>Speed ratio</b>	2.36:1 (2.36)
<b>X / Y / Z</b>	73 (2.87) / – / 20 (0.79) mm (")

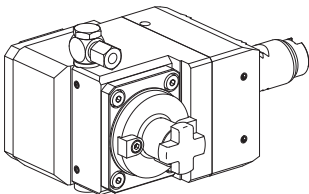

**10356214 Milling unit**

<b>Fixation</b>	W serration
<b>Mounting</b>	Milling shaft D22 (0.87 ")
<b>Cooling</b>	external, $p_{max}$ 80 bar
<b>Speed ratio</b>	2.5:1 (2.5)
<b>X / Y / Z</b>	75 (2.95) / – / 41 (1.61) mm (")

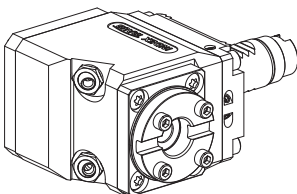

**10838926 Milling unit**

<b>Fixation</b>	W serration
<b>Mounting</b>	–
<b>Cooling</b>	external, $p_{max}$ 80 bar
<b>Speed ratio</b>	2.5:1 (2.5)
<b>X / Y / Z</b>	55 (2.17) / – / 53 (2.09) mm (")

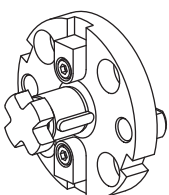

**10670447 Milling cutter holding block**

<b>Fixation</b>	–
<b>Mounting</b>	Milling shaft D13 (0.51 ")
<b>Cooling</b>	–
<b>X / Y / Z</b>	– / – / – mm (")

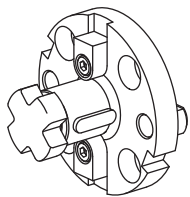

**11041286 Milling cutter holding block**

<b>Fixation</b>	–
<b>Mounting</b>	Milling shaft D16 (0.63 ")
<b>Cooling</b>	–
<b>X / Y / Z</b>	– / – / – mm (")

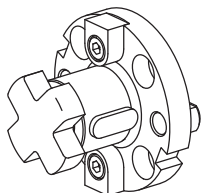

**10435497 Milling cutter holding block**

<b>Fixation</b>	–
<b>Mounting</b>	Milling shaft D22 (0.87 ")
<b>Cooling</b>	–
<b>X / Y / Z</b>	– / – / – mm (")

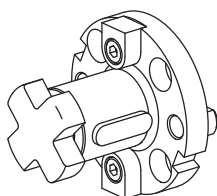

**12011567 Milling cutter holding block**

<b>Fixation</b>	–
<b>Mounting</b>	Milling shaft D22 (0.87 ")
<b>Cooling</b>	–
<b>X / Y / Z</b>	32.5 (1.28) / – / – mm (")

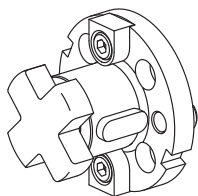

**10807705 Milling cutter holding block**

<b>Fixation</b>	–
<b>Mounting</b>	Milling shaft D27 (1.06 ")
<b>Cooling</b>	–
<b>X / Y / Z</b>	– / – / – mm (")

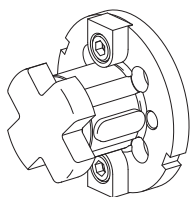

**10223928 Milling cutter holding block**

<b>Fixation</b>	–
<b>Mounting</b>	Milling shaft D32 (1.26 ")
<b>Cooling</b>	–
<b>X / Y / Z</b>	– / – / – mm (")

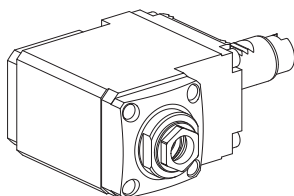

**10390037 Tapping unit**

<b>Fixation</b>	W serration
<b>Mounting</b>	ER 20
<b>Cooling</b>	external, p <sub>max</sub> 80 bar
<b>Speed ratio</b>	2:1 (2)
<b>X / Y / Z</b>	70 (2.76) / – / 69 (2.72) mm (")

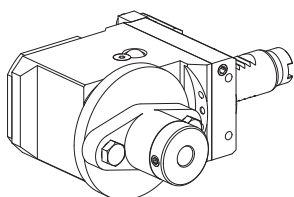

**10622506 Broaching/ Slotting unit**

<b>Fixation</b>	Vee bar
<b>Mounting</b>	D12 (0.47 ")
<b>Cooling</b>	external, p <sub>max</sub> 20 bar
<b>Speed ratio</b>	2.36:1 (2.36)
<b>X / Y / Z</b>	73 (2.87) / – / 73.6 (2.90) mm (")

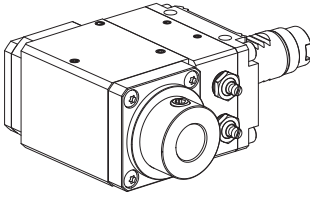

**10766208 Broaching/ Slotting unit**

<b>Fixation</b>	W serration
<b>Mounting</b>	D20 (0.79 ")
<b>Cooling</b>	external, internal optional, $p_{max}$ 80 bar
<b>Speed ratio</b>	1:1 (1)
<b>X / Y / Z</b>	70 (2.76) / – / 69 (2.72) mm (")

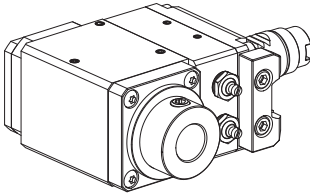

**10971676 Broaching/ Slotting unit**

<b>Fixation</b>	Vee bar
<b>Mounting</b>	D20 (0.79 ")
<b>Cooling</b>	external, internal optional, $p_{max}$ 80 bar
<b>Speed ratio</b>	1:1 (1)
<b>X / Y / Z</b>	70 (2.76) / – / 69 (2.72) mm (")

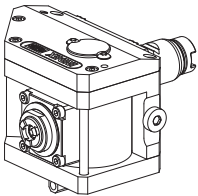

**10558202 Drilling unit**

<b>Fixation</b>	W serration
<b>Mounting</b>	ER 11
<b>Cooling</b>	external, $p_{max}$ 80 bar
<b>Speed ratio</b>	1:1.7 (0.588)
<b>X / Y / Z</b>	44 (1.73) / – / 37 (1.46) mm (")

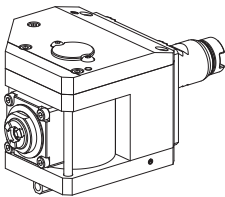

**10566421 Drilling unit, angle-adjustable**

<b>Fixation</b>	W serration
<b>Mounting</b>	ER 11
<b>Cooling</b>	external, $p_{max}$ 80 bar
<b>Speed ratio</b>	1:1.7 (0.588)
<b>X / Y / Z</b>	67 (2.64) / – / 24 (0.94) mm (")

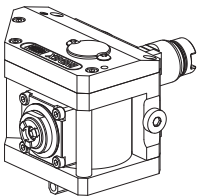

**10345861 Drilling unit, angle-adjustable**

<b>Fixation</b>	Vee bar
<b>Mounting</b>	ER 11
<b>Cooling</b>	external, $p_{max}$ 80 bar
<b>Speed ratio</b>	1:1.7 (0.588)
<b>X / Y / Z</b>	44 (1.73) / – / 67 (2.64) mm (")

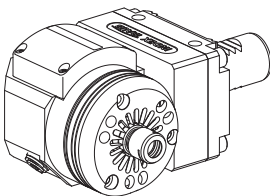

**10646377 Fluid spindle, up to 40,000 1/min**

<b>Fixation</b>	W serration
<b>Mounting</b>	ER 11
<b>Cooling</b>	external, $p_{max}$ 40 bar
<b>X / Y / Z</b>	70 (2.76) / – / 64 (2.52) mm (")

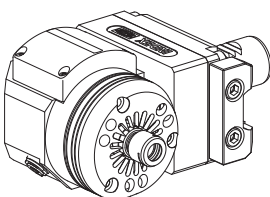

**11095303 Fluid spindle, up to 40,000 1/min**

<b>Fixation</b>	Vee bar
<b>Mounting</b>	ER 11
<b>Cooling</b>	external, $p_{max}$ 40 bar
<b>X / Y / Z</b>	70 (2.76) / – / 64 (2.52) mm (")

# Tool holder to spring-loaded tap holder Shank 3/4"

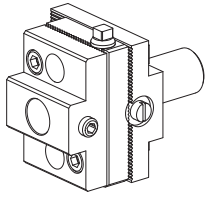

## 11074608 Drilling tool holder, vertically adjustable

<b>Fixation</b>	none
<b>Mounting</b>	D15 (0.59 ")
<b>Cooling</b>	–
<b>X / Y / Z</b>	48 (1.89) / – / – mm (")

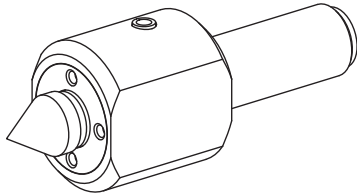

## 10376272 Center holder, elastic, live

<b>Fixation</b>	none
<b>Mounting</b>	MK0
<b>Cooling</b>	–
<b>X / Y / Z</b>	61 (2.40) / – / – mm (")

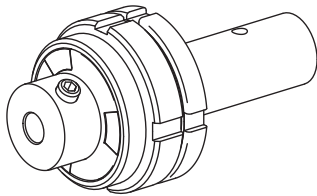

## 10398672 Tapping tool holder, over-running

<b>Fixation</b>	none
<b>Mounting</b>	D8 (0.31 ")
<b>Cooling</b>	–
<b>X / Y / Z</b>	41 (1.61) / – / – mm (")

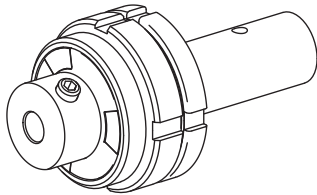

## 10646298 Tapping tool holder, over-running

<b>Fixation</b>	none
<b>Mounting</b>	D8 (0.31 ")
<b>Cooling</b>	–
<b>X / Y / Z</b>	41 (1.61) / – / – mm (")

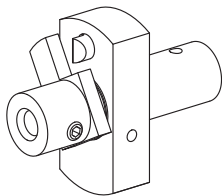

## 10955662 Tapping tool holder, over-running

<b>Fixation</b>	none
<b>Mounting</b>	D8 (0.31 ")
<b>Cooling</b>	–
<b>X / Y / Z</b>	38 (1.50) / – / – mm (")

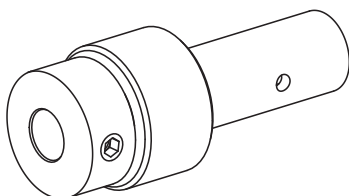

## 10022420 Tapping tool holder, extendable

<b>Fixation</b>	none
<b>Mounting</b>	D12 (0.47 ")
<b>Cooling</b>	–
<b>X / Y / Z</b>	36 (1.42) / – / – mm (")

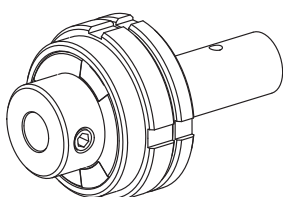

## 10367051 Tapping tool holder, over-running

<b>Fixation</b>	none
<b>Mounting</b>	D12 (0.47 ")
<b>Cooling</b>	–
<b>X / Y / Z</b>	41 (1.61) / – / – mm (")

# Tool holder to spring-loaded tap holder Shank 3/4"

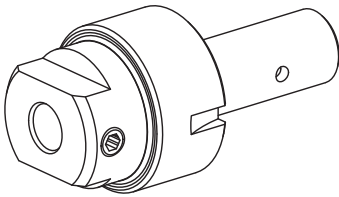

## 10691613 Tapping tool holder, extendable

Fixation	none
Mounting	D12 (0.47 ")
Cooling	–
X / Y / Z	41 (1.61) / – / – mm (")

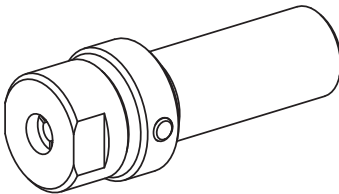

## 10114544 Tapping tool holder, extendable

Fixation	none
Mounting	–
Cooling	–
X / Y / Z	26 (1.02) / – / – mm (")

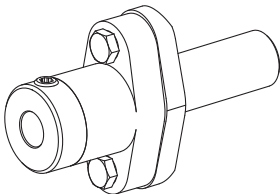

## 10852881 Broaching/ Slotting holder, rotating, live

Fixation	none
Mounting	D12 (0.47 ")
Cooling	–
X / Y / Z	52 (2.05) / – / – mm (")

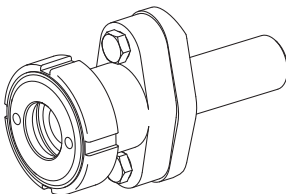

## 10694118 Broaching/ Slotting holder, rotating, live

Fixation	none
Mounting	D24 (0.94 ")
Cooling	–
X / Y / Z	55 (2.17) / – / – mm (")

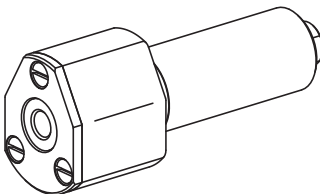

## 10497461 Guide holder

Fixation	none
Mounting	D6 (0.24 ")
Cooling	–
X / Y / Z	27 (1.06) / – / – mm (")

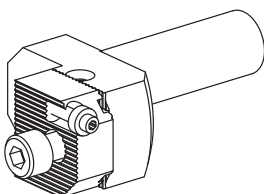

## 10974901 Guide holder, adjustable

Fixation	none
Mounting	D12 (0.47 ")
Cooling	–
X / Y / Z	34 (1.34) / – / – mm (")

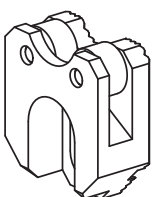

## 10686673 Roller holding block

Fixation	–
Mounting	–
Cooling	–
X / Y / Z	– / – / – mm (")

# Tool holder to spring-loaded tap holder Shank 3/4"

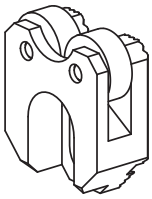

## 11071318 Roller holding block

<b>Fixation</b>	–
<b>Mounting</b>	–
<b>Cooling</b>	–
<b>X / Y / Z</b>	– / – / – mm (")

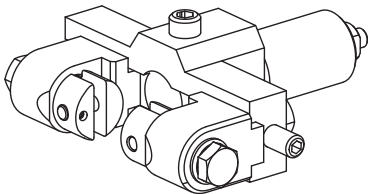

## 10126683 Knurling tool holder, adjustable

<b>Fixation</b>	none
<b>Mounting</b>	D2-24 (0.08 " - 0.94 ")
<b>Cooling</b>	–
<b>X / Y / Z</b>	51 (2.01) / – / – mm (")

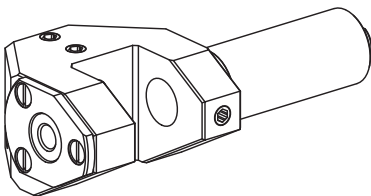

## 10900179 Turning and guide holder

<b>Fixation</b>	none
<b>Mounting</b>	D6 (0.24 ")
<b>Cooling</b>	–
<b>X / Y / Z</b>	48 (1.89) / – / – mm (")

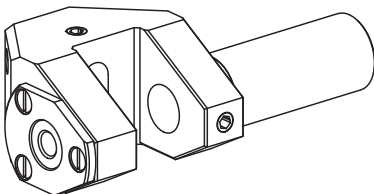

## 11045363 Turning and guide holder

<b>Fixation</b>	none
<b>Mounting</b>	D6 (0.24 ")
<b>Cooling</b>	–
<b>X / Y / Z</b>	48 (1.89) / – / – mm (")

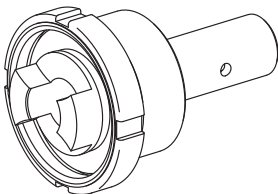

## 10612591 Thread cutting holder, extendable

<b>Fixation</b>	none
<b>Mounting</b>	Buttress thread S48x1.5
<b>Cooling</b>	–
<b>X / Y / Z</b>	38 (1.50) / – / – mm (")

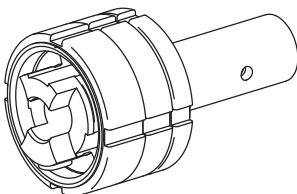

## 10218668 Thread cutting holder, over-running

<b>Fixation</b>	none
<b>Mounting</b>	Buttress thread S38x1.5
<b>Cooling</b>	–
<b>X / Y / Z</b>	38 (1.50) / – / – mm (")

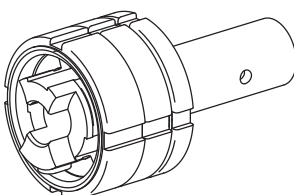

## 10320599 Thread cutting holder, over-running

<b>Fixation</b>	none
<b>Mounting</b>	Buttress thread S38x1.5
<b>Cooling</b>	–
<b>X / Y / Z</b>	38 (1.50) / – / – mm (")

# Tool holder to spring-loaded tap holder Shank 3/4"

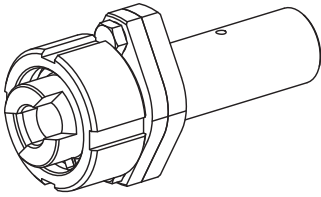

## 10949890 Thread cutting holder, extendable

<b>Fixation</b>	none
<b>Mounting</b>	M28x1
<b>Cooling</b>	–
<b>X / Y / Z</b>	38 (1.50) / – / – mm (")

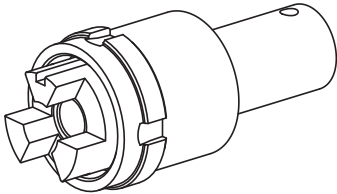

## 10448210 Thread cutting holder, extendable

<b>Fixation</b>	none
<b>Mounting</b>	M29x1
<b>Cooling</b>	–
<b>X / Y / Z</b>	43 (1.69) / – / – mm (")

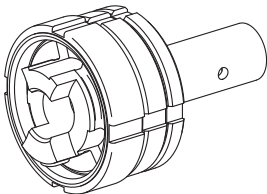

## 10247273 Thread cutting holder, over-running

<b>Fixation</b>	none
<b>Mounting</b>	M48x1.5
<b>Cooling</b>	–
<b>X / Y / Z</b>	41 (1.61) / – / – mm (")



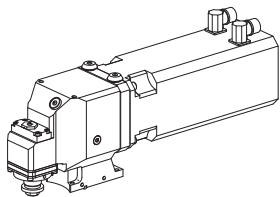

## 10098017 Polygon turning unit

<b>Fixation</b>	–
<b>Mounting</b>	INDEX KK-32
<b>Cooling</b>	external, $p_{\max}$ 30 bar
<b>Speed ratio</b>	1:1 (1)
<b>X / Y / Z</b>	– / – / – mm (")

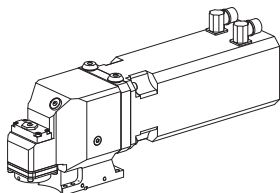

## 10973223 Polygon turning unit

<b>Fixation</b>	–
<b>Mounting</b>	INDEX KK-32
<b>Cooling</b>	external, $p_{\max}$ 30 bar
<b>Speed ratio</b>	1:1 (1)
<b>X / Y / Z</b>	– / – / – mm (")

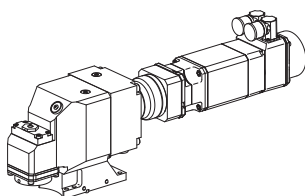

## 10889230 Polygon turning unit

<b>Fixation</b>	–
<b>Mounting</b>	INDEX KK-32
<b>Cooling</b>	external, $p_{\max}$ 30 bar
<b>Speed ratio</b>	5:1 (5)
<b>X / Y / Z</b>	– / – / – mm (")

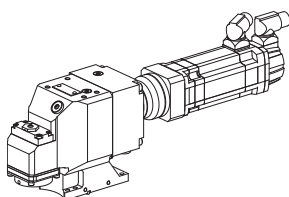

## 10989902 Polygon turning unit, for control C200-sl

<b>Fixation</b>	–
<b>Mounting</b>	INDEX KK-32
<b>Cooling</b>	external, $p_{\max}$ 30 bar
<b>Speed ratio</b>	5:1 (5)
<b>X / Y / Z</b>	– / – / – mm (")

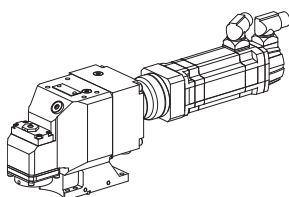

## 1095783 Polygon turning unit, for control C200-sl

<b>Fixation</b>	–
<b>Mounting</b>	INDEX KK-32
<b>Cooling</b>	external, $p_{\max}$ 30 bar
<b>Speed ratio</b>	7:1 (7)
<b>X / Y / Z</b>	– / – / – mm (")

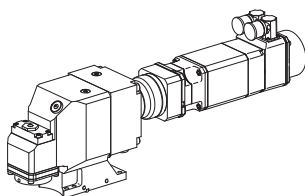

## 10970341 Polygon turning unit

<b>Fixation</b>	–
<b>Mounting</b>	INDEX KK-32
<b>Cooling</b>	external, $p_{\max}$ 30 bar
<b>Speed ratio</b>	7:1 (7)
<b>X / Y / Z</b>	– / – / – mm (")

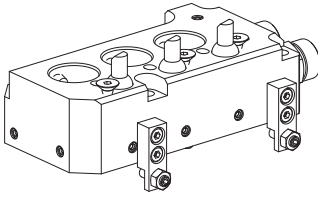

### 10123787 Back end unit

<b>Fixation</b>	–
<b>Mounting</b>	Drill holding block D22
<b>Cooling</b>	external and internal, $p_{max}$ extern. 40 bar, intern. 80 bar
<b>X / Y / Z</b>	– / – / – mm (")

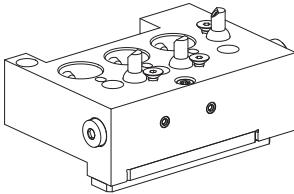

### 10168590 Back end unit

<b>Fixation</b>	–
<b>Mounting</b>	Drill holding block D22
<b>Cooling</b>	external, $p_{max}$ 30 bar
<b>X / Y / Z</b>	– / – / – mm (")

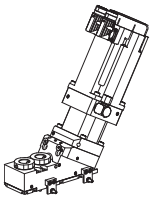

### 10397072 Back end unit, spindle position 3

<b>Fixation</b>	–
<b>Mounting</b>	WFB 20-12
<b>Cooling</b>	external, $p_{max}$ 30 bar
<b>Speed ratio</b>	1:1.8 (0.555)
<b>X / Y / Z</b>	– / – / – mm (")

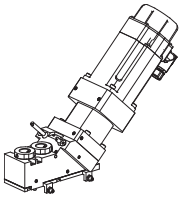

### 10362096 Back end unit

<b>Fixation</b>	–
<b>Mounting</b>	WFB 20-12
<b>Cooling</b>	external, $p_{max}$ 30 bar
<b>Speed ratio</b>	2:1 (2)
<b>X / Y / Z</b>	– / – / – mm (")

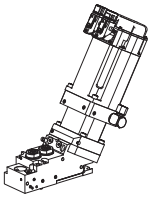

### 11059380 Back end unit

<b>Fixation</b>	–
<b>Mounting</b>	1x D22 (0.87") – 2x ER 11
<b>Cooling</b>	external, $p_{max}$ 30 bar
<b>Speed ratio</b>	1:2 (0.5)
<b>X / Y / Z</b>	– / – / – mm (")

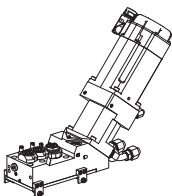

### 10026174 Back end unit

<b>Fixation</b>	–
<b>Mounting</b>	2x D22 (0.87") – 1x WFB 20-12
<b>Cooling</b>	external and internal, $p_{max}$ 30 bar
<b>Speed ratio</b>	1:1,90 (0,526)
<b>X / Y / Z</b>	– / – / – mm (")

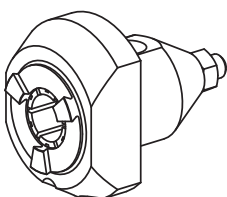

### 10417636 Drill holding block

<b>Fixation</b>	Shank D22
<b>Mounting</b>	ER 16
<b>Cooling</b>	–
<b>X / Y / Z</b>	13 (0.51) / – / – mm (")

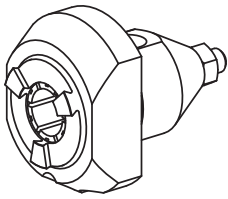

### 10757759 Drill holding block, sealed

<b>Fixation</b>	Shank D22
<b>Mounting</b>	ER 16
<b>Cooling</b>	–
<b>X / Y / Z</b>	13 (0.51) / – / – mm (")

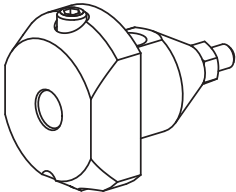

### 10884793 Drill holding block

<b>Fixation</b>	Shank D22
<b>Mounting</b>	D8 (0.31 ")
<b>Cooling</b>	–
<b>X / Y / Z</b>	13 (0.51) / – / – mm (")

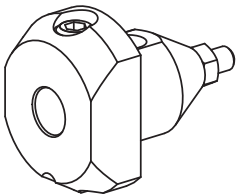

### 11168823 Drill holding block

<b>Fixation</b>	Shank D22
<b>Mounting</b>	D10 (0.39 ")
<b>Cooling</b>	–
<b>X / Y / Z</b>	13 (0.51) / – / – mm (")

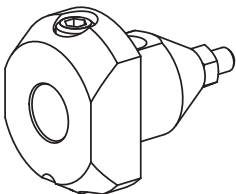

### 10406274 Drill holding block

<b>Fixation</b>	Shank D22
<b>Mounting</b>	D12 (0.47 ")
<b>Cooling</b>	–
<b>X / Y / Z</b>	13 (0.51) / – / – mm (")

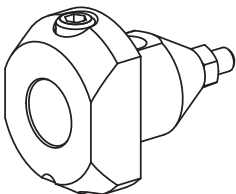

### 10336013 Drill holding block

<b>Fixation</b>	Shank D22
<b>Mounting</b>	D14 (0.55 ")
<b>Cooling</b>	–
<b>X / Y / Z</b>	13 (0.51) / – / – mm (")

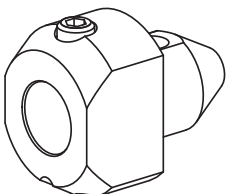

### 10246879 Drill holding block

<b>Fixation</b>	Shank D22
<b>Mounting</b>	D16 (0.63 ")
<b>Cooling</b>	–
<b>X / Y / Z</b>	21 (0.83) / – / – mm (")

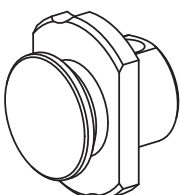

### 10633382 Blanking plug

<b>Fixation</b>	Shank D22
<b>Mounting</b>	–
<b>Cooling</b>	–
<b>X / Y / Z</b>	13 (0.51) / – / – mm (")



**INDEX-Werke GmbH & Co. KG  
Hahn & Tessky**

Plochinger Straße 92  
D-73730 Esslingen

Fon +49 711 3191-0  
Fax +49 711 3191-587

[info@index-werke.de](mailto:info@index-werke.de)  
[www.index-werke.de](http://www.index-werke.de)