



INDEX G520

Tool holder Basic equipment

INDEX G520, VDI40 - Basic Equipment-Tool Holders

We recommend the following basic equipment for tool holders and accessories.

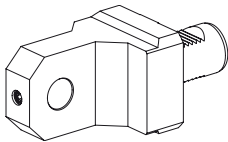

1x Bar stop, live

Part no. 10875475
Fixation none
Mounting D25
Cooling –
X / Y / Z 90 / – / 1 mm

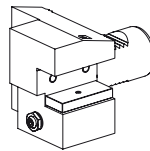

6x Turning tool holder, form C2/C3

Part no. 12098663
Fixation W-serration
Mounting Square 25x25
Cooling external & internal, p_{\max} 80 bar
X / Y / Z 60,6 / – / 47,5 mm

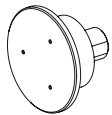

1x Bar stop, live

Part no. 10452051
Fixation –
Mounting D85
Cooling –
X / Y / Z – / – / 30 mm

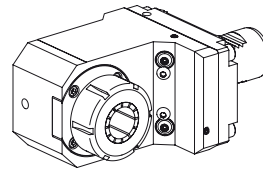

4x Drill holder

Part no. 10829165
Fixation W-serration
Mounting ER 40
Cooling external, p_{\max} 20 bar
X / Y / Z 110 / – / 49 mm

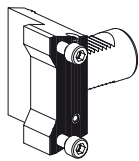

1x Base holder, adjustable

Part no. 10846334
Fixation W-serration
Mounting –
Cooling external
X / Y / Z 17 / – / 34,8 mm

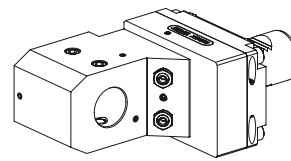

2x Drill holder

Part no. 12036278
Fixation W-serration
Mounting DIN 1835 B/E D32
Cooling external & internal, p_{\max} 80 bar
X / Y / Z 110 / – / – mm

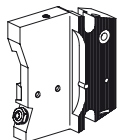

1x Grooving tool holder block

Part no. 10908238
Fixation –
Mounting Trapez 32x8
Cooling external & internal, p_{\max} 80 bar
X / Y / Z 87,5 / – / 20 mm

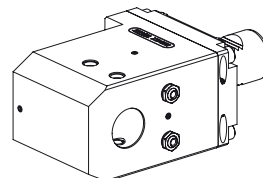

4x Drill holder

Part no. 12026368
Fixation W-serration
Mounting DIN 1835 B/E D32
Cooling external & internal, p_{\max} 80 bar
X / Y / Z 110 / – / 57,5 mm

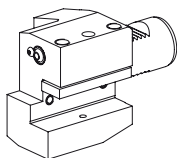

10x Turning tool holder, form C1/C4

Part no. 10965815
Fixation none
Mounting Square 25x25
Cooling external, p_{\max} 20 bar
X / Y / Z 85 / – / 42,5 mm

2x Reduction sleeve D32/06

Part no. 10735500

2x Reduction sleeve D32/10

Part no. 10264567

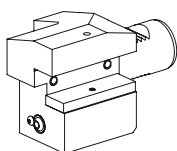

6x Turning tool holder, form C2/C3

Part no. 10810887
Fixation none
Mounting Square 25x25
Cooling external, p_{\max} 20 bar
X / Y / Z 85 / – / 47,5 mm



2x Reduction sleeve D32/12

Part no. 10865452

2x Reduction sleeve D32/16

Part no. 10246709

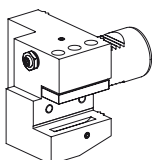

10x Turning tool holder, form C1/C4

Part no. 12077312
Fixation W-serration
Mounting Square 25x25
Cooling external & internal, p_{\max} 80 bar
X / Y / Z 61,3 / – / 47,5 mm

2x Reduction sleeve D32/20

Part no. 10787586

2x Reduction sleeve D32/25

Part no. 10626419

INDEX G520, VDI40 - Basic Equipment-Tool Holders

We will be happy to send you an individual offer. Simply give us a call at +49 711 3191-9854 or send us an e-mail to werkzeughalter@index-werke.de

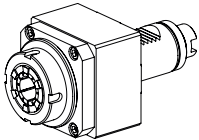

4x Milling unit

Part no. 12088208
Fixation none
Mounting ER 32
Cooling external, p_{max} 80 bar
Transmission ratio 1:1 (1)
X / Y / Z 82 / - / - mm

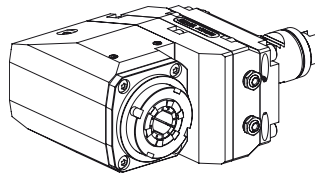

2x Milling unit

Part no. 12042168
Fixation W-serration
Mounting ER 32
Cooling external, p_{max} 80 bar
Transmission ratio 1:1 (1)
X / Y / Z 110 / - / 49,5 mm

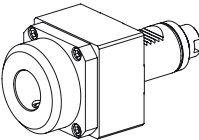

3x Milling unit

Part no. 12028521
Fixation none
Mounting D32
Cooling external, p_{max} 80 bar
Transmission ratio 1:1 (1)
X / Y / Z 85 / - / - mm

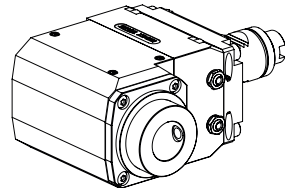

1x Milling unit

Part no. 12032576
Fixation W-serration
Mounting D32
Cooling external, opt.internal, p_{max} 80 bar
Transmission ratio 1:1 (1)
X / Y / Z 110 / - / 100 mm

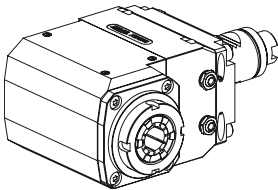

4x Milling unit

Part no. 12033177
Fixation W-serration
Mounting ER 32
Cooling external, opt.internal, p_{max} 80 bar
Transmission ratio 1:1 (1)
X / Y / Z 110 / - / 93,5 mm

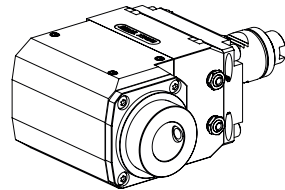

1x Milling unit

Part no. 12032524
Fixation W-serration
Mounting D32
Cooling external, opt.internal, p_{max} 80 bar
Transmission ratio 2:1 (2)
X / Y / Z 110 / - / 100 mm

We will be happy to expand the listed basic equipment tailored to your production requirements.

Please keep in mind that machine-specific and material-specific components, such as clamping devices, spindle reductions and accessories are also needed for the bar loading magazine.

INDEX G520, VDI40 - Basic Equipment-Machine Accessories

You will also get from INDEX other accessories.



Chuck Key

Type ER32

Part no. 10174063

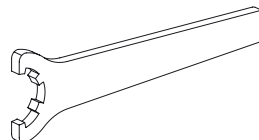

Chuck Key

Type ER40

Part no. 10474438



IC-attachment

Internal cooling 80 bar

Part no. 10687215

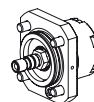

IC-attachment

Internal cooling 160 bar

Part no. 10236572

For more information see ixshop.ixworld.com

INDEX G520, CAPTO C6 - Basic Equipment-Tool Holders

We recommend the following basic equipment for tool holders.

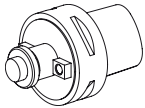

1x Milling cutter holder
Part no. 12081860
Mounting Milling shaft D22

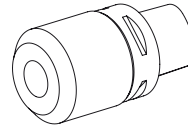

3x Drill holder
Part no. 12081928
Mounting D25

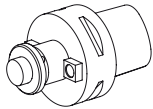

1x Milling cutter holder
Part no. 12081921
Mounting Milling shaft D27

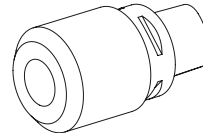

3x Drill holder
Part no. 12081929
Mounting D32

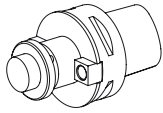

1x Milling cutter holder
Part no. 12081922
Mounting Milling shaft D32

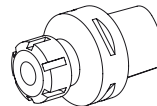

6x Drill holder
Part no. 12081936
Mounting ER25

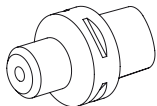

2x Drill holder
Part no. 12081923
Mounting D10

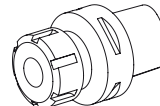

6x Drill holder
Part no. 12081937
Mounting ER32

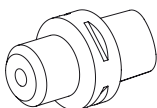

3x Drill holder
Part no. 12081925
Mounting D12

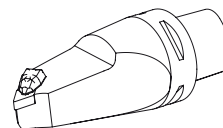

1x Turning tool holder, left
Part no. 12081940
Mounting for CN.. 1104..

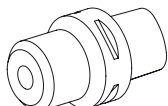

3x Drill holder
Part no. 12081926
Mounting D16

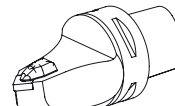

1x Turning tool holder
Part no. 12081939
Mounting for CN.. 1204..

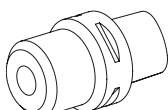

3x Drill holder
Part no. 12081927
Mounting D20

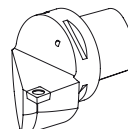

1x Turning tool holder, right
Part no. 12081945
Mounting for CN.. 1204..

INDEX G520, CAPTO C6 - Basic Equipment-Tool Holders

We will be happy to send you an individual offer. Simply give us a call at +49 711 3191-9854 or send us an e-mail to werkzeughalter@index-werke.de

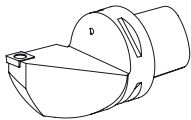

1x Turning tool holder, left

Part no. 12081946
Mounting for CN.. 1204..

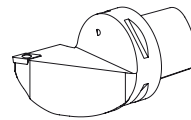

1x Turning tool holder, left

Part no. 12081943
Mounting for DC.. 11T3..

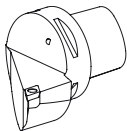

1x Turning tool holder, right

Part no. 12081942
Mounting for DC.. 11T3..

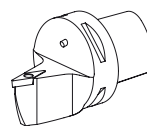

1x Turning tool holder

Part no. 12081941
Mounting for VB.. 1604..

We will be happy to expand the listed basic equipment tailored to your production requirements.

Please keep in mind that machine-specific and material-specific components, such as clamping devices, spindle reductions and accessories are also needed for the bar loading magazine.

INDEX G520, CAPTO C6 - Basic Equipment-Machine Accessories

You will also get from INDEX other accessories.

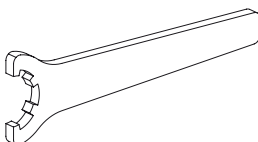

Chuck Key

Type ER25

Part no. 10802433

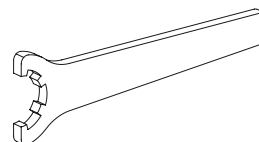

Chuck Key

Type ER32

Part no. 10181051



Coolant adapter kit

Type CAPTO C6

Part no. 10865732



Socket wrench

Type CAPTO C6

Part no. 10352082

For more information see ixshop.ixworld.com

INDEX G520, HSK63 - Basic Equipment-Tool Holders

We recommend the following basic equipment for tool holders and accessories.

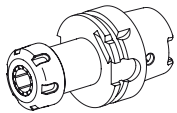

5x Drill holder

Part no. 10613579
Form A
Mounting ER25
Cooling internal, p_{max} 80 bar
X / Z 80 / – mm

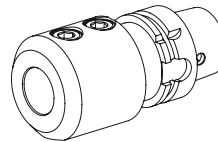

2x Drill holder

Part no. 10123145
Form A
Mounting D32
Cooling internal, p_{max} 80 bar
X / Z 110 / – mm

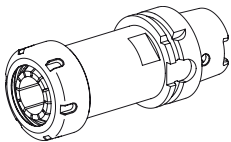

5x Drill holder

Part no. 10155467
Form A
Mounting ER 40
Cooling internal, p_{max} 80 bar
X / Z 120 / – mm

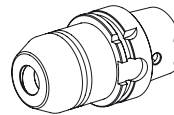

2x Drill holder

Part no. 10869184
Form A
Mounting Hydraulic expansion chuck D20
Cooling internal, p_{max} 80 bar
X / Z 80 / – mm

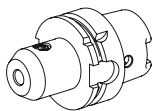

5x Drill holder

Part no. 10971880
Form A
Mounting D10
Cooling internal, p_{max} 40 bar
X / Z 65 / – mm

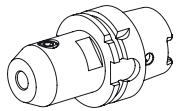

5x Drill holder

Part no. 10221444
Form A
Mounting D12
Cooling internal, p_{max} 80 bar
X / Z 80 / – mm



2x Reduction sleeve D20/06

Part no. 10052498

2x Reduction sleeve D20/08

Part no. 10880268

2x Reduction sleeve D20/10

Part no. 10422510

2x Reduction sleeve D20/12

Part no. 10508491

2x Reduction sleeve D20/16

Part no. 10445247

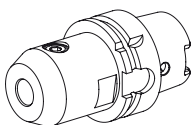

5x Drill holder

Part no. 10415848
Form A
Mounting D16
Cooling internal, p_{max} 80 bar
X / Z 80 / – mm

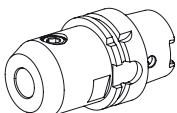

5x Drill holder

Part no. 10336873
Form A
Mounting D20
Cooling internal, p_{max} 80 bar
X / Z 80 / – mm

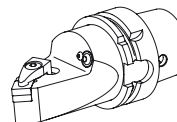

2x Turning tool holder

Part no. 10809872
Form T
Mounting for CN.. 1204..
Cooling external, p_{max} 80 bar
X / Z 100 / – mm

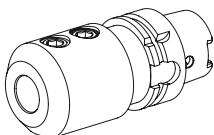

5x Drill holder

Part no. 10695393
Form A
Mounting D25
Cooling internal, p_{max} 80 bar
X / Z 110 / – mm

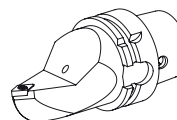

2x Turning tool holder

Part no. 11016276
Form T
Mounting for DC.. 11T3..
Cooling external, p_{max} 80 bar
X / Z 100 / – mm

INDEX G520, HSK63 - Basic Equipment-Tool Holders

We will be happy to send you an individual offer. Simply give us a call at +49 711 3191-9854 or send us an e-mail to werkzeughalter@index-werke.de

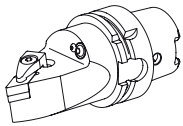

2x Turning tool holder

Part no. 10652895
Form T
Mounting for DN.. 1506..
Cooling external, p_{max} 80 bar
X / Z 100 / – mm

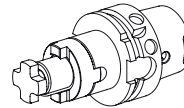

2x Milling cutter holder

Part no. 10662987
Form A
Mounting Milling shaft D22
Cooling –
X / Z 48 / – mm

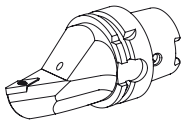

1x Turning tool holder

Part no. 10468828
Form T
Mounting for VC.. 1604..
Cooling external, p_{max} 80 bar
X / Z 100 / – mm

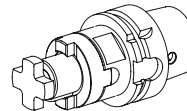

2x Milling cutter holder

Part no. 10834685
Form A
Mounting Milling shaft D27
Cooling –
X / Z 48 / – mm

We will be happy to expand the listed basic equipment tailored to your production requirements.

Please keep in mind that machine-specific and material-specific components, such as clamping devices, spindle reductions and accessories are also needed for the bar loading magazine.

INDEX G520, HSK63 - Basic Equipment-Machine Accessories

You will also get from INDEX other accessories.

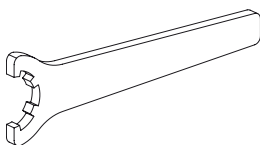

Chuck Key

Type ER25

Part no. 10802433

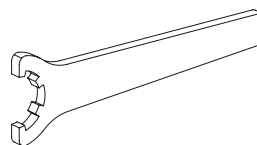

Chuck Key

Type ER40

Part no. 10474438



Coolant adapter kit

Type HSK63 max. 80 bar

Part no. 11074450



Coolant adapter kit

Type HSK63 max. 120 bar

Part no. 12024087

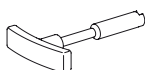

Socket wrench

Type HSK63

Part no. 10352082

For more information see ixshop.ixworld.com

INDEX G520 - Basic Equipment-Machine Accessories

You will also get from INDEX presetting adapters and mounting aids for damage-free installation and measuring your tool holders.

VDI

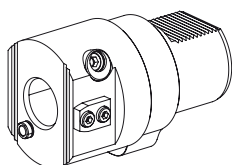

**Presetting adapter
VDI80**

Tool mounting VDI40
Part no. 10531917

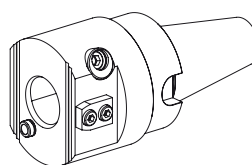

**Presetting adapter
quick-release taper 50**

Tool mounting VDI40
Part no. 10921942

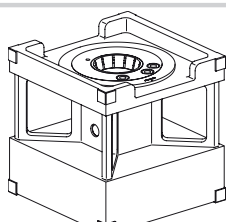

Pre-adjustment block

Basic body
Part no. 10444808

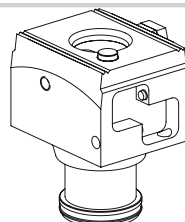

Pre-adjustment block

Adapter tool mounting VDI40
Part no. 10946082

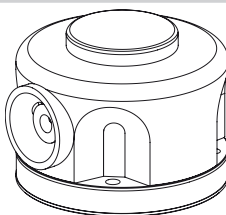

Mounting aid TOOLFIX

Basic body
Part no. 10917422

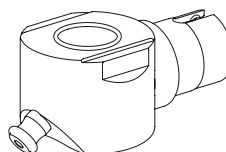

Mounting aid TOOLFIX

Adapter tool mounting VDI40
Part no. 10416978

INDEX G520 - Basic Equipment-Machine Accessories

You will also get from INDEX presetting adapters and mounting aids for damage-free installation and measuring your tool holders.

CAPTO C6

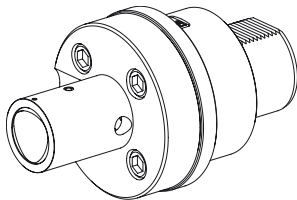

**Presetting adapter
VDI80**

Tool mounting CAPTO C6
Part no. 12102653

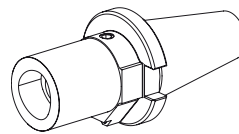

**Presetting adapter
quick-release taper 50**

Tool mounting CAPTO C6
Part no. 12095573

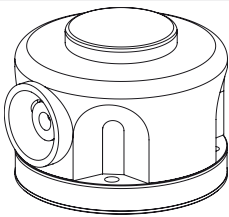

Mounting aid TOOLFIX

Basic body
Part no. 10917422

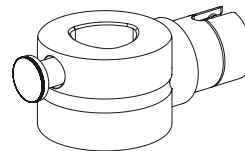

Mounting aid TOOLFIX

Adapter tool mounting CAPTO C6
Part no. 12095515

HSK63

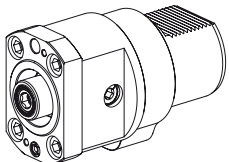

**Presetting adapter
VDI80**

Tool mounting HSK63
Part no. 10094249

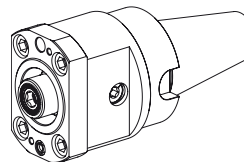

**Presetting adapter
quick-release taper 50**

Tool mounting HSK63
Part no. 10614276

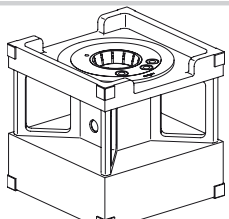

Pre-adjustment block

Basic body
Part no. 10444808

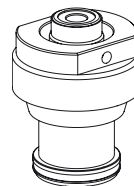

Pre-adjustment block

Adapter tool mounting HSK63
Part no. 10643359

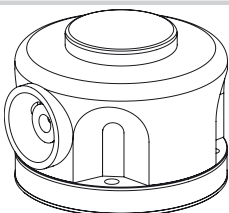

Mounting aid TOOLFIX

Basic body
Part no. 10917422

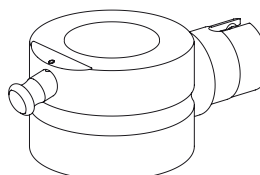

Mounting aid TOOLFIX

Adapter tool mounting HSK63
Part no. 10573278

INDEX G520 - Basic Equipment-Machine Accessories

For best operation of your machine, INDEX offers tailor-made spindle reducers and clamping devices.

Spindle diameter 120mm

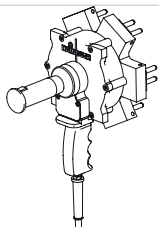

**Hainbuch, Changing Fixture pneumatic
Spanntop nova chuck**

Part no. 12066309

Clamping device size 125
External clamping

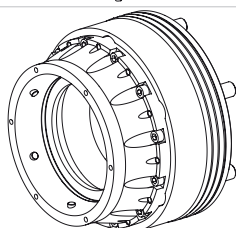

**Hainbuch
Spanntop nova chuck, Modular**

Part no. 12080565

Spindle clearance 104/120mm
Spindle mounting KK11
Clamping device size 125

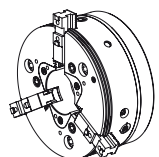

**Schunk
Rota THW Plus 315 - 104 - A11**

Part no. 12080519

Spindle clearance 102/120mm
Spindle mounting KK11
Clamping device size 315

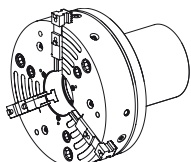

**Schunk
Rota THW Plus 400 - 120 - A11**

Part no. 12029596

Spindle clearance 104/120mm
Spindle mounting KK11
Clamping device size 400

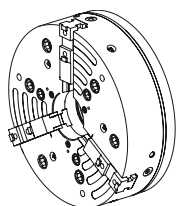

**Schunk
Rota THW Plus 500 - 128 - A11 GBK**

Part no. 12080564

Spindle clearance 120/128mm
Spindle mounting KK11
Clamping device size 500

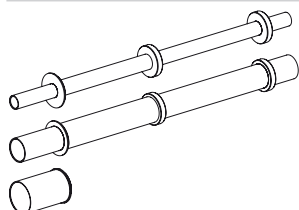

**Spindle clearance 120mm
Clamping stroke 48mm
Material diameter D40 - D120**

Please note the part no. from the
Spindle Reductions section under ixshop.ixworld.com

INDEX

INDEX

INDEX-Werke GmbH & Co. KG Hahn & Tessky

Plochinger Straße 92
D-73730 Esslingen

Fon +49 711 3191-0
Fax +49 711 3191-587

info@index-werke.de
www.index-werke.de