



## INDEX C200, VDI30

Tool holder      Basic equipment

## INDEX C200, VDI30 - Basic Equipment - Tool Holders

We recommend the following basic equipment for tool holders and accessories.

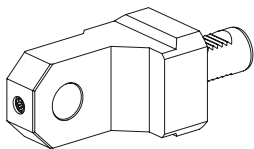

### 1x Bar stop, live

Part no. 11018887  
 Fixation none  
 Mounting –  
 Cooling –  
 X / Y / Z 92 / – / 31 mm

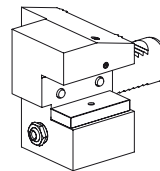

### 6x Turning tool holder, form C2/C3

Part no. 12048895  
 Fixation W-serration  
 Mounting Square 25x25  
 Cooling external,  $p_{max}$  80 bar  
 X / Y / Z 60,6 / – / 56 mm

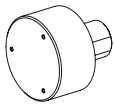

### 1x Bar stop, live

Part no. 10900227  
 Fixation –  
 Mounting D58  
 Cooling –  
 X / Y / Z – / – / 30 mm

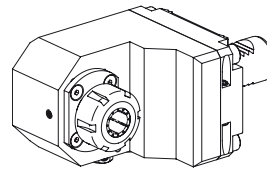

### 4x Drill holder

Part no. 10192281  
 Fixation W-serration  
 Mounting ER 25  
 Cooling external & internal,  $p_{max}$  80 bar  
 X / Y / Z 90 / – / 29 mm

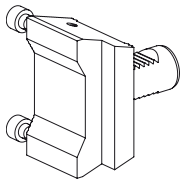

### 1x Base holder, adjustable

Part no. 10774339  
 Fixation W-serration  
 Mounting –  
 Cooling external,  $p_{max}$  20 bar  
 X / Y / Z 38 / – / 32 mm

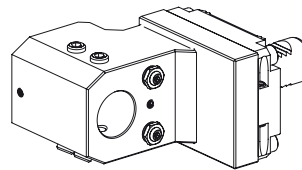

### 2x Drill holder

Part no. 10092885  
 Fixation W-serration  
 Mounting DIN 1835 B/E D32  
 Cooling external & internal,  $p_{max}$  80 bar  
 X / Y / Z 100 / – / – mm

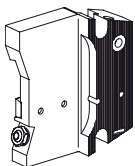

### 1x Grooving tool holder block

Part no. 10453502  
 Fixation –  
 Mounting Trapezoidal 32x8  
 Cooling external,  $p_{max}$  80 bar  
 X / Y / Z 87,5 / – / 20 mm

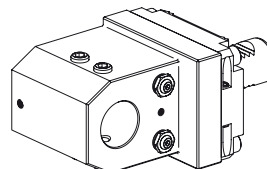

### 4x Drill holder

Part no. 10941548  
 Fixation W-serration  
 Mounting DIN 1835 B/E D32  
 Cooling external & internal,  $p_{max}$  80 bar  
 X / Y / Z 90 / – / 30 mm

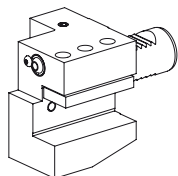

### 10x Turning tool holder, form C1/C4

Part no. 10663275  
 Fixation none  
 Mounting Square 25x25  
 Cooling external,  $p_{max}$  40 bar  
 X / Y / Z 70 / – / 40 mm

### 2x Reduction sleeve D32/06

Part no. 10735500

### 2x Reduction sleeve D32/10

Part no. 10264567

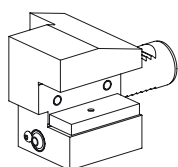

### 6x Turning tool holder, form C2/C3

Part no. 10719601  
 Fixation none  
 Mounting Square 25x25  
 Cooling external,  $p_{max}$  40 bar  
 X / Y / Z 70 / – / 46 mm



### 2x Reduction sleeve D32/12

Part no. 10865452

### 2x Reduction sleeve D32/16

Part no. 10246709

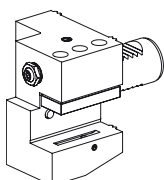

### 10x Turning tool holder, form C1/C4

Part no. 12056031  
 Fixation W-serration  
 Mounting Square 25x25  
 Cooling external,  $p_{max}$  80 bar  
 X / Y / Z 60,6 / – / 40 mm

### 2x Reduction sleeve D32/20

Part no. 10787586

### 2x Reduction sleeve D32/25

Part no. 10626419

## INDEX C200, VDI30 - Basic Equipment - Tool Holders

We will be happy to send you an individual offer. Simply give us a call at +49 711 3191-9854 or send us an e-mail to [werkzeughalter@index-werke.de](mailto:werkzeughalter@index-werke.de)

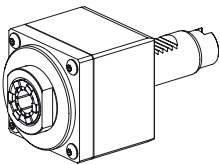

### 4x Milling unit

Part no. 10692074  
 Fixation none  
 Mounting ER 25  
 Cooling external,  $p_{max}$  80 bar  
 Transmission ratio 1:1 (1)  
 X / Y / Z 81 / - / - mm

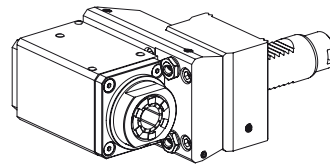

### 2x Milling unit

Part no. 10005333  
 Fixation W-serration  
 Mounting ER 25  
 Cooling external, opt. internal,  $p_{max}$  80 bar  
 Transmission ratio 1:1 (1)  
 X / Y / Z 90 / - / 22 mm

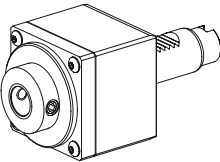

### 3x Milling unit

Part no. 10657344  
 Fixation none  
 Mounting DIN 1835 B/E D20  
 Cooling external,  $p_{max}$  80 bar  
 Transmission ratio 1:1 (1)  
 X / Y / Z 86.5 / - / - mm

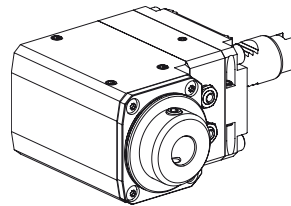

### 1x Milling unit

Part no. 10202810  
 Fixation W-serration  
 Mounting DIN 1835 B/E D20  
 Cooling external, opt. internal,  $p_{max}$  80 bar  
 Transmission ratio 1:1 (1)  
 X / Y / Z 90 / - / 93 mm

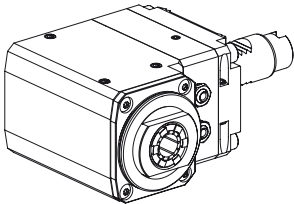

### 4x Milling unit

Part no. 10571448  
 Fixation W-serration  
 Mounting ER 25  
 Cooling external, opt. internal,  $p_{max}$  80 bar  
 Transmission ratio 1:1 (1)  
 X / Y / Z 90 / - / 84 mm

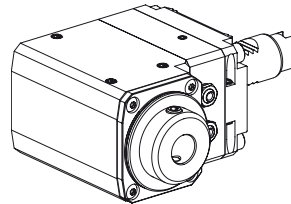

### 1x Milling unit

Part no. 10011322  
 Fixation W-serration  
 Mounting DIN 1835 B/E D20  
 Cooling external, opt. internal,  $p_{max}$  80 bar  
 Transmission ratio 2:1 (2)  
 X / Y / Z 90 / - / 93 mm

We will be happy to expand the listed basic equipment tailored to your production requirements.

Please keep in mind that machine-specific and material-specific components, such as clamping devices, spindle reductions and accessories are also needed for the bar loading magazine.

## INDEX C200, VDI30 - Basic Equipment - Machine Accessories

You will also get from INDEX presetting adapters and mounting aids for damage-free installation and measuring your tool holders.

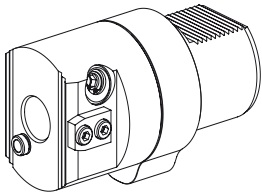

**Presetting adapter  
VDI80**

**Tool mounting VDI30**  
Part no. 10864045

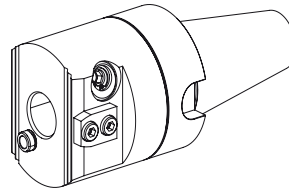

**Presetting adapter  
quick-release taper 50**

**Tool mounting VDI30**  
Part no. 10740620

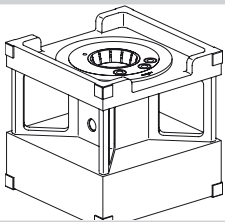

**Pre-adjustment block**

**Basic body**  
Part no. 10444808

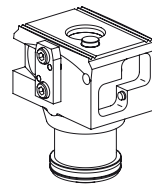

**Pre-adjustment block**

**Adapter tool mounting VDI30**  
Part no. 10300226

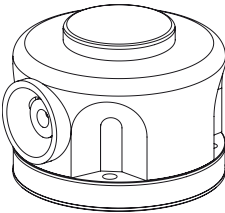

**Mounting aid TOOLFIX**

**Base body**  
Part no. 10917422

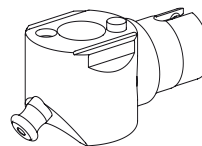

**Mounting aid TOOLFIX**

**Adapter tool mounting VDI30**  
Part no. 10127253

## INDEX C200, VDI30 - Basic Equipment - Machine Accessories

You will also get from INDEX other accessories.

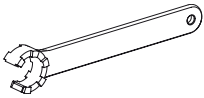

**Chuck Key**

**Type E25AX**

Part no. 10179444

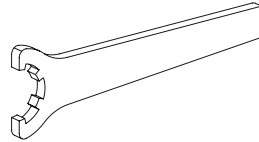

**Chuck Key**

**Type ER25**

Part no. 10802433

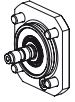

**IC-attachment**

**up to 80bar**

Part no. 10687215

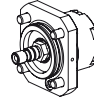

**IC-attachment**

**Internal cooling 160 bar**

Part no. 10236572

## INDEX C200, VDI30 - Basic Equipment - Machine Accessories

For best operation of your machine, INDEX offers tailor-made spindle reducers and clamping devices.

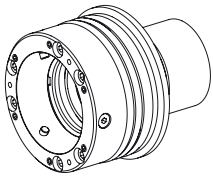

**Main spindle D65**

**HAINBUCH Spanntop nova modular - through-bore chuck**  
Part no. 10182829

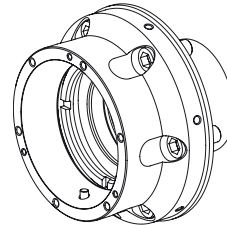

**Main-/Counter spindle D90**

**HAINBUCH Spanntop nova modular - through-bore chuck**  
Part no. 10643312

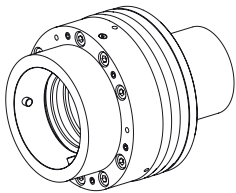

**Counter spindle D65**

**HAINBUCH Spanntop nova combi deadlength with end-stop**  
Part no. 10916697

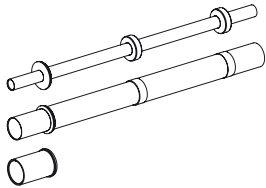

**Spindle diameter 65mm, Clamping stroke independent**  
Material diameter D5 - D66  
Please note the part no. from the Spindle Reductions section under [ixshop.ixworld.com](http://ixshop.ixworld.com)

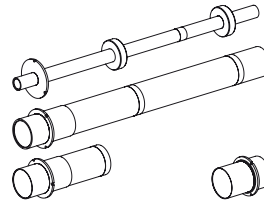

**Spindle diameter 90mm, Clamping stroke 10mm**  
Material diameter D8 - D90  
Please note the part no. from the Spindle Reductions section under [ixshop.ixworld.com](http://ixshop.ixworld.com)

# INDEX

# INDEX

**INDEX-Werke GmbH & Co. KG  
Hahn & Tessky**

Plochinger Straße 92  
D-73730 Esslingen

Fon +49 711 3191-0  
Fax +49 711 3191-587

[info@index-werke.de](mailto:info@index-werke.de)  
[www.index-werke.de](http://www.index-werke.de)