

## INDEX C100, C200, VDI25

Tool holder

Basic equipment

## INDEX C100, C200, VDI25 - Basic Equipment - Tool Holders

We recommend the following basic equipment for tool holders and accessories.

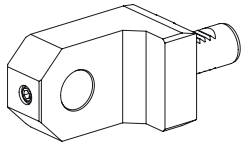

### 1x Bar stop, live

Part no. 10505133  
 Fixation none  
 Mounting D25  
 Cooling -  
 X / Y / Z 70 / - / 30 mm

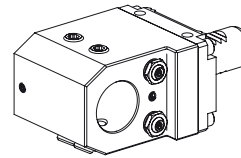

### 4x Drill holder

Part no. 10712278  
 Fixation W-serration  
 Mounting DIN 1835 B/E D32  
 Cooling external & internal,  $p_{max}$  80 bar  
 X/Y/Z 70/-/30 mm

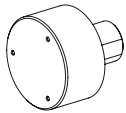

### 1x Bar stop, live

Part no. 10900227  
 Fixation none  
 Mounting D58  
 Cooling -  
 X / Y / Z - / - / 30 mm

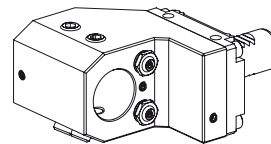

### 2x Drill holder

Part no. 10894414  
 Fixation W-serration  
 Mounting DIN 1835 B/E D32  
 Cooling external & internal,  $p_{max}$  80 bar  
 X/Y/Z 70/-/-mm

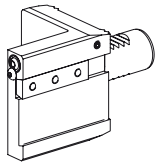

### 1x Grooving tool holder

Part no. 10222400  
 Fixation W-serration  
 Mounting Trapezoidal 32x4  
 Cooling external,  $p_{max}$  20 bar  
 X / Y / Z 68.2 / - / 30 mm

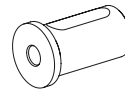

### 4x Reduction sleeve D32/06

Part no. 10735500

### 4x Reduction sleeve D32/10

Part no. 10264567

### 4x Reduction sleeve D32/12

Part no. 10865452

### 4x Reduction sleeve D32/16

Part no. 10246709

### 4x Reduction sleeve D32/20

Part no. 10787586

### 4x Reduction sleeve D32/25

Part no. 10626419

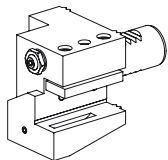

### 8x Turning tool holder, form C1/C4

Part no. 12088124  
 Fixation W-serration  
 Mounting Square 20x20  
 Cooling external & internal,  $p_{max}$  80 bar  
 X / Y / Z 56 / - / 15 mm

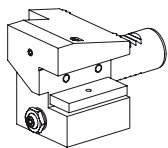

### 4x Turning tool holder, form C2/C3

Part no. 12084149  
 Fixation W-serration  
 Mounting Square 20x20  
 Cooling external & internal,  $p_{max}$  80 bar  
 X / Y / Z 56 / - / 19 mm

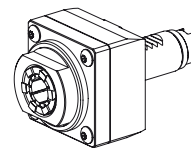

### 3x Drilling unit

Part no. 10828154  
 Fixation none  
 Mounting ER 25  
 Cooling external,  $p_{max}$  80 bar  
 Transmission ratio 1:1 (1)  
 X / Y / Z 57 / - / - mm

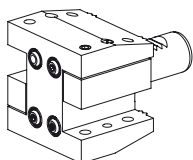

### 1x Turning tool holder, double

Part no. 10657631  
 Fixation W-serration  
 Mounting Square 20x20  
 Cooling external,  $p_{max}$  20 bar  
 X / Y / Z 57 / - / 17 mm

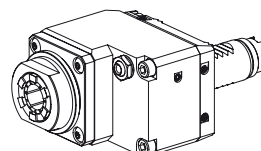

### 1x Milling unit

Part no. 10991401  
 Fixation W-serration  
 Mounting ER 25  
 Cooling external,  $p_{max}$  80 bar  
 Transmission ratio 1:1 (1)  
 X / Y / Z 89.9 / - / 31 mm

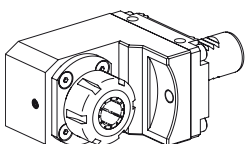

### 6x Drill holder

Part no. 10545041  
 Fixation W-serration  
 Mounting ER 25  
 Cooling external & internal,  $p_{max}$  80 bar  
 X / Y / Z 70 / - / 31 mm

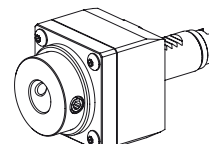

### 1x Milling unit

Part no. 10307933  
 Fixation none  
 Mounting DIN 1835 B/E D20  
 Cooling external,  $p_{max}$  80 bar  
 Transmission ratio 1:1 (1)  
 X / Y / Z 72 / - / - mm

## INDEX C100, C200, VDI25 - Basic Equipment - Tool Holders

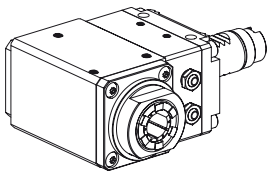

### 3x Milling unit

Part no. 10392320  
 Fixation W-serration  
 Mounting ER 25  
 Cooling external, opt. internal,  $p_{max}$  80 bar  
 Transmission ratio 1:1 (1)  
 X / Y / Z 70 / - / 64 mm

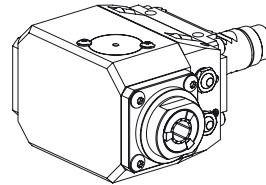

### 1x Drilling unit

Part no. 11064426  
 Fixation W-serration  
 Mounting ER 20  
 Cooling external, opt. internal,  $p_{max}$  80 bar  
 Transmission ratio 1:2 (0.5)  
 X / Y / Z 70 / - / 80 mm

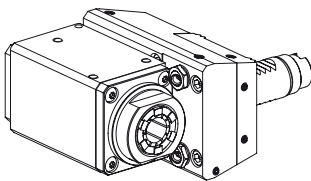

### 2x Milling unit, shifted

Part no. 10703086  
 Fixation W-serration  
 Mounting ER 25  
 Cooling external, opt. internal,  $p_{max}$  80 bar  
 Transmission ratio 1:1 (1)  
 X / Y / Z 70 / - / 22 mm

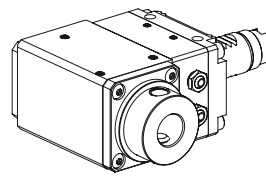

### 1x Milling unit

Part no. 10444044  
 Fixation W-serration  
 Mounting DIN 1835 B/E D20  
 Cooling external, opt. internal,  $p_{max}$  80 bar  
 Transmission ratio 2:1 (2)  
 X / Y / Z 70 / - / 71 mm

We will be happy to expand the listed basic equipment tailored to your production requirements.

Please keep in mind that machine-specific and material-specific components, such as clamping devices, spindle reductions and accessories are also needed for the bar loading magazine.

## INDEX C100, C200, VDI25 - Basic Equipment - Machine Accessories

For best operation of your machine, INDEX offers tailor-made spindle reducers and clamping devices.

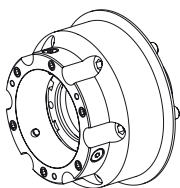

### INDEX C100 - main spindle D42

**HAINBUCH Spanntop nova modular through-bore chuck**  
 Part no. 10981573

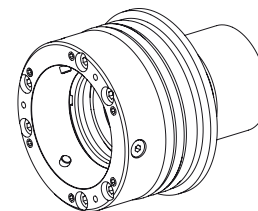

### INDEX C200 - main spindle D65

**HAINBUCH Spanntop nova modular through-bore chuck**  
 Part no. 10182829

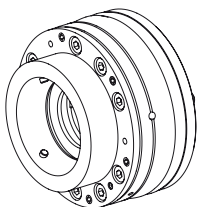

### INDEX C100 - counter spindle D42

**HAINBUCH Spanntop nova combi deadlength with end-stop**  
 Part no. 11036209

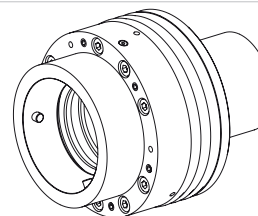

### INDEX C200 - main spindle D65

**HAINBUCH Spanntop nova combi deadlength with end-stop**  
 Part no. 10916697

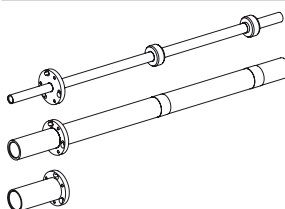

### INDEX C100 - main spindle D42 for INDEX MBL/MBF

Clamping stroke Independent  
 Material diameter D05 - D43  
 Please note the part no. from the Spindle Reductions section under [ixshop.ixworld.com](http://ixshop.ixworld.com)

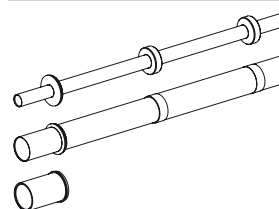

### INDEX C200 - main spindle D65 for INDEX MBL/MBF

Clamping stroke Independent  
 Material diameter D05 - D66  
 Please note the part no. from the Spindle Reductions section under [ixshop.ixworld.com](http://ixshop.ixworld.com)

We will be happy to send you an individual offer. Simply give us a call at +49 711 3191-9854 or send us an e-mail to [werkzeughalter@index-werke.de](mailto:werkzeughalter@index-werke.de)

## INDEX C100, C200, VDI25 - Basic Equipment - Machine Accessories

In addition, INDEX also provides presetting adapters, mounting aids for damage-free installation, and gauging your tool holders and other accessories.

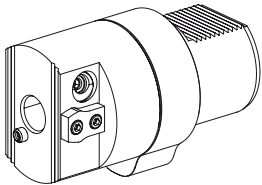

**Presetting adapter  
VDI80**

**Tool mounting VDI25**  
Part no. 10985260

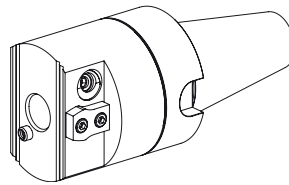

**Presetting adapter  
quick-release taper 50**

**Tool mounting VDI25**  
Part no. 10622335

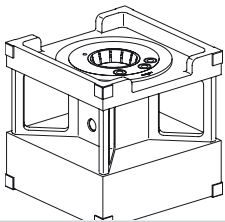

**Pre-adjustment block**

**Basic body**  
Part no. 10444808

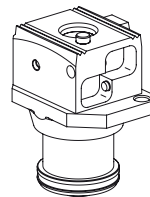

**Pre-adjustment block**

**Adapter tool mounting VDI25**  
Part no. 10491250

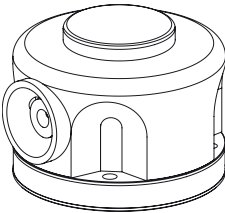

**Mounting aid TOOLFIX**

**Base body**  
Part no. 10917422

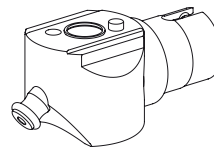

**Mounting aid TOOLFIX**

**Adapter tool mounting VDI25**  
Part no. 10192955

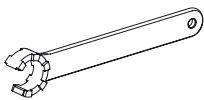

**Chuck Key**

**Type E25AX**  
Part no. 10179444

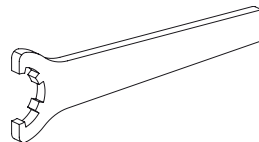

**Chuck Key**

**Type ER25**  
Part no. 10802433

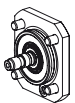

**IC-attachment**

**up to 80bar**  
Part no. 10687215

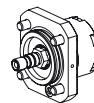

**IC-attachment**

**Internal cooling 160 bar**  
Part no. 10236572

For more information see [ixshop.ixworld.com](http://ixshop.ixworld.com)

### INDEX-Werke GmbH & Co. KG Hahn & Tessky

Plochinger Straße 92  
D-73730 Esslingen

Fon +49 711 3191-0  
Fax +49 711 3191-587

info@index-werke.de  
www.index-werke.de