

## **INDEX B500 TRAUB TNA500.2**

### **Radial turret VDI40**

Tool holder      Basic equipment

## INDEX B500, TRAUB TNA500.2 - Radial turret VDI40 Basic Equipment - Tool Holders

We recommend the following basic equipment for tool holders and accessories.

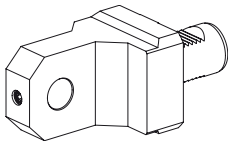

### 1x Bar stop, live

Part no. 10875475  
Fixation none  
Mounting D25  
Cooling -  
X / Y / Z 90 / - / 1 mm

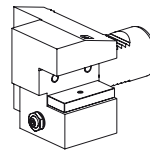

### 6x Turning tool holder, form C2/C3

Part no. 12098663  
Fixation W-serration  
Mounting Square 25x25  
Cooling external & internal,  $p_{max}$  80 bar  
X / Y / Z 60,6 / - / 47,5 mm

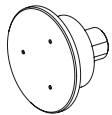

### 1x Bar stop, live

Part no. 10452051  
Fixation -  
Mounting D85  
Cooling -  
X / Y / Z - / - / 30 mm

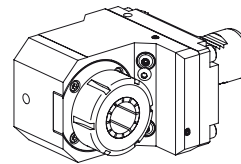

### 4x Drill holder

Part no. 10141629  
Fixation W-serration  
Mounting ER 40  
Cooling external,  $p_{max}$  40 bar  
X / Y / Z 90 / - / 49 mm

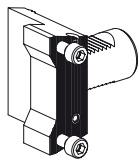

### 1x Base holder, adjustable

Part no. 10846334  
Fixation W-serration  
Mounting -  
Cooling external  
X / Y / Z 17 / - / 34,8 mm

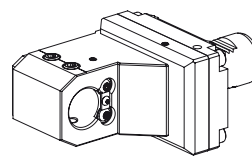

### 2x Drill holder

Part no. 10173165  
Fixation W-serration  
Mounting DIN 1835 B/E D32  
Cooling external & internal,  $p_{max}$  20 bar  
X / Y / Z 100 / - / 4 mm

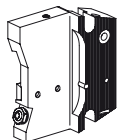

### 1x Grooving tool holder block

Part no. 10908238  
Fixation -  
Mounting Trapezoidal 32x8  
Cooling external & internal,  $p_{max}$  80 bar  
X / Y / Z 87,5 / - / 20 mm

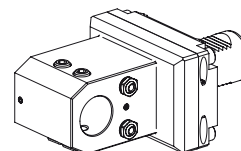

### 4x Drill holder

Part no. 10142897  
Fixation W-serration  
Mounting DIN 1835 B/E D32  
Cooling external & internal,  $p_{max}$  80 bar  
X / Y / Z 100 / - / 30 mm

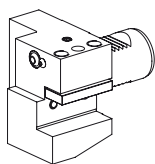

### 10x Turning tool holder, form C1/C4

Part no. 10464052  
Fixation none  
Mounting Square 25x25  
Cooling external,  $p_{max}$  20 bar  
X / Y / Z 60 / - / 47,5 mm

### 2x Reduction sleeve D32/06

Part no. 10735500

### 2x Reduction sleeve D32/10

Part no. 10264567

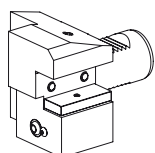

### 6x Turning tool holder, form C2/C3

Part no. 10009218  
Fixation none  
Mounting Square 25x25  
Cooling external,  $p_{max}$  20 bar  
X / Y / Z 60 / - / 47,5 mm



### 2x Reduction sleeve D32/12

Part no. 10865452

### 2x Reduction sleeve D32/16

Part no. 10246709

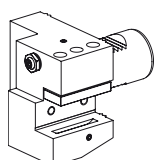

### 10x Turning tool holder, form C1/C4

Part no. 12077312  
Fixation W-serration  
Mounting Square 25x25  
Cooling external & internal,  $p_{max}$  80 bar  
X / Y / Z 60,6 / - / 47,5 mm

### 2x Reduction sleeve D32/20

Part no. 10787586

### 2x Reduction sleeve D32/25

Part no. 10626419

## INDEX B500, TRAUB TNA500.2 - Radial turret VDI40 Basic Equipment - Tool Holders

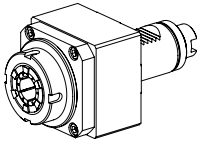

### 4x Milling unit

Part no. 12088208  
Fixation none  
Mounting ER 32  
Cooling external,  $p_{max}$  80 bar  
Transmission ratio 1:1 (1)  
X / Y / Z 82 / - / - mm

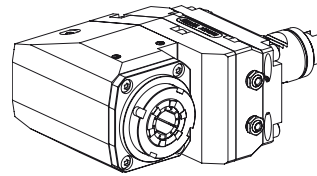

### 2x Milling unit

Part no. 12042168  
Fixation W-serration  
Mounting ER 32  
Cooling external,  $p_{max}$  80 bar  
Transmission ratio 1:1 (1)  
X / Y / Z 110 / - / 49,5 mm

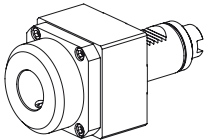

### 3x Milling unit

Part no. 12028521  
Fixation none  
Mounting D32  
Cooling external,  $p_{max}$  80 bar  
Transmission ratio 1:1 (1)  
X / Y / Z 85 / - / - mm

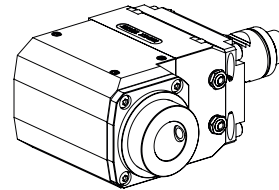

### 1x Milling unit

Part no. 12032576  
Fixation W-serration  
Mounting D32  
Cooling external, opt.internal,  $p_{max}$  80 bar  
Transmission ratio 1:1 (1)  
X / Y / Z 110 / - / 100 mm

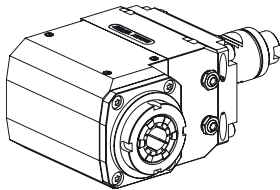

### 4x Milling unit

Part no. 12033177  
Fixation W-serration  
Mounting ER 32  
Cooling external, opt.internal,  $p_{max}$  80 bar  
Transmission ratio 1:1 (1)  
X / Y / Z 110 / - / 93,5 mm

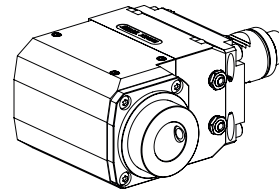

### 1x Milling unit

Part no. 12032524  
Fixation W-serration  
Mounting D32  
Cooling external, opt.internal,  $p_{max}$  80 bar  
Transmission ratio 2:1 (2)  
X / Y / Z 110 / - / 100 mm

We will be happy to expand the listed basic equipment tailored to your production requirements.

Please keep in mind that machine-specific and material-specific components, such as clamping devices, spindle reductions and accessories are also needed for the bar loading magazine.

## INDEX B500, TRAUB TNA500.2 - Radial turret VDI40 Basic Equipment - Machine Accessories

For best operation of your machine, INDEX offers tailor-made spindle reducers and clamping devices.

### Main spindle D102 KK11

#### HAINBUCH Spanntop modular 100

Part no. 12101538

#### Schunk Rota THW 315-104

Part no. 12071827

#### Schunk Rota THW 400-120

Part no. 12071829

#### Changing device pneumatic

Part no. 10965185

### Spindle diameter D102

#### Clamping stroke independent

Material diameter D40 - D102

Please note the part no. from the Spindle Reductions section under [ixshop.ixworld.com](http://ixshop.ixworld.com)

We will be happy to send you an individual offer. Simply give us a call at +49 711 3191-9854 or send us an e-mail to [werkzeughalter@index-werke.de](mailto:werkzeughalter@index-werke.de)

## INDEX B500, TRAUB TNA500.2 - Radial turret VDI40 Basic Equipment - Machine Accessories

In addition, INDEX also provides presetting adapters, mounting aids for damage-free installation, and gauging your tool holders and other accessories.

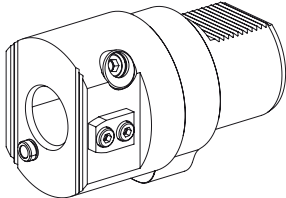

**Presetting adapter  
VDI80**

**Tool mounting VDI40**  
Part no. 10531917

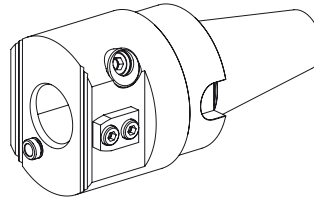

**Presetting adapter  
quick-release taper 50**

**Tool mounting VDI40**  
Part no. 10921942

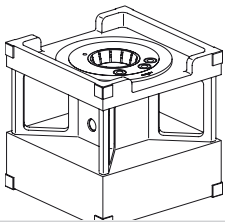

**Pre-adjustment block**

**Basic body**  
Part no. 10444808

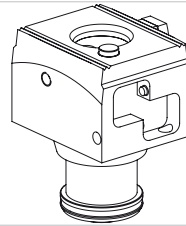

**Pre-adjustment block**

**Adapter tool mounting VDI40**  
Part no. 10946082

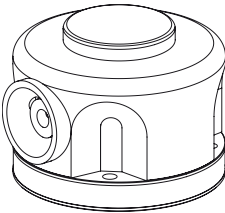

**Mounting aid TOOLFIX**

**Basic body**  
Part no. 10917422

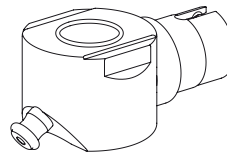

**Mounting aid TOOLFIX**

**Adapter tool mounting VDI40**  
Part no. 10416978

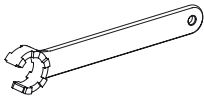

**Chuck Key**

**Type ER32**  
Part no. 10174063

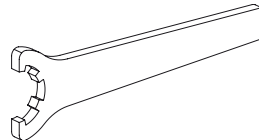

**Chuck Key**

**Type ER40**  
Part no. 10474438

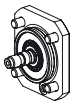

**IC-attachment**

**up to 80bar**  
Part no. 10687215

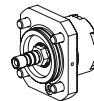

**IC-attachment**

**Internal cooling 160 bar**  
Part no. 10236572

For more information see [ixshop.ixworld.com](http://ixshop.ixworld.com)

### INDEX-Werke GmbH & Co. KG Hahn & Tessky

Plochinger Straße 92  
D-73730 Esslingen

Fon +49 711 3191-0  
Fax +49 711 3191-587

info@index-werke.de  
www.index-werke.de