

# Product note

## **Gear cutting unit, adjustable angle**

Face contact cupped

## **Note on applicability**

Illustrations in this publication may deviate from the product supplied. Errors and omissions due to technical progress expected.

## **A word on copyright**

This document is protected by copyright and was originally compiled in German.  
The duplication and distribution of this document or parts thereof is prohibited without prior consent of the copyright owner, and any violators will be prosecuted. All rights, including the right to translate, are reserved.

© Copyright by INDEX-Werke GmbH & Co. KG

## Gear cutting unit, adjustable angle

Face contact cupped

### Presetting

- Presetting is done outside the tool holder, to achieve a play-free fit in the bearings
- Assemble ring (A), taper (B) and clamping sleeves (C)
- Use cylinder head screw (D) to tighten the mounting arbor (E)
- Adjust the required outside diameter  $17\text{mm}+0.004$  by grinding the ring (A)
- Disassemble again for installation in the gear cutting unit

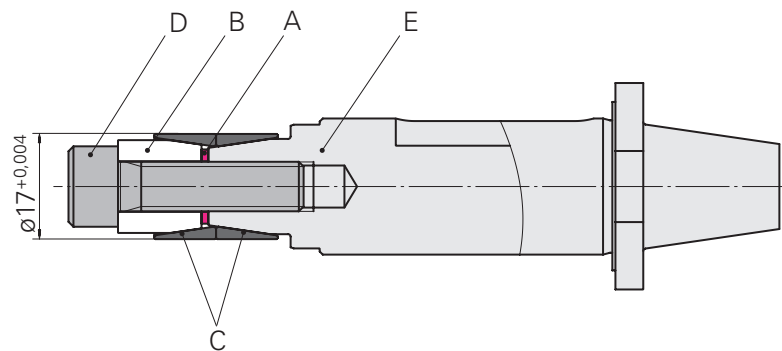

#### Product note

Gear cutting unit, adjustable angle - Face contact cupped  
W9800013EN-02.02.18

## Gear cutting unit, adjustable angle

Face contact cupped

### Installation

- Tighten mounting arbor (E) and inserted gear cutter (Y) with cylinder head screw (Z) to 14 Nm
- Assemble cover (F) and housing (G)
- Insert into gear cutting unit (H)
- Observe face contact (I) of the housing (G) during installation
- Tighten cylinder head screw (D)
- Tighten cylinder head screws (J)

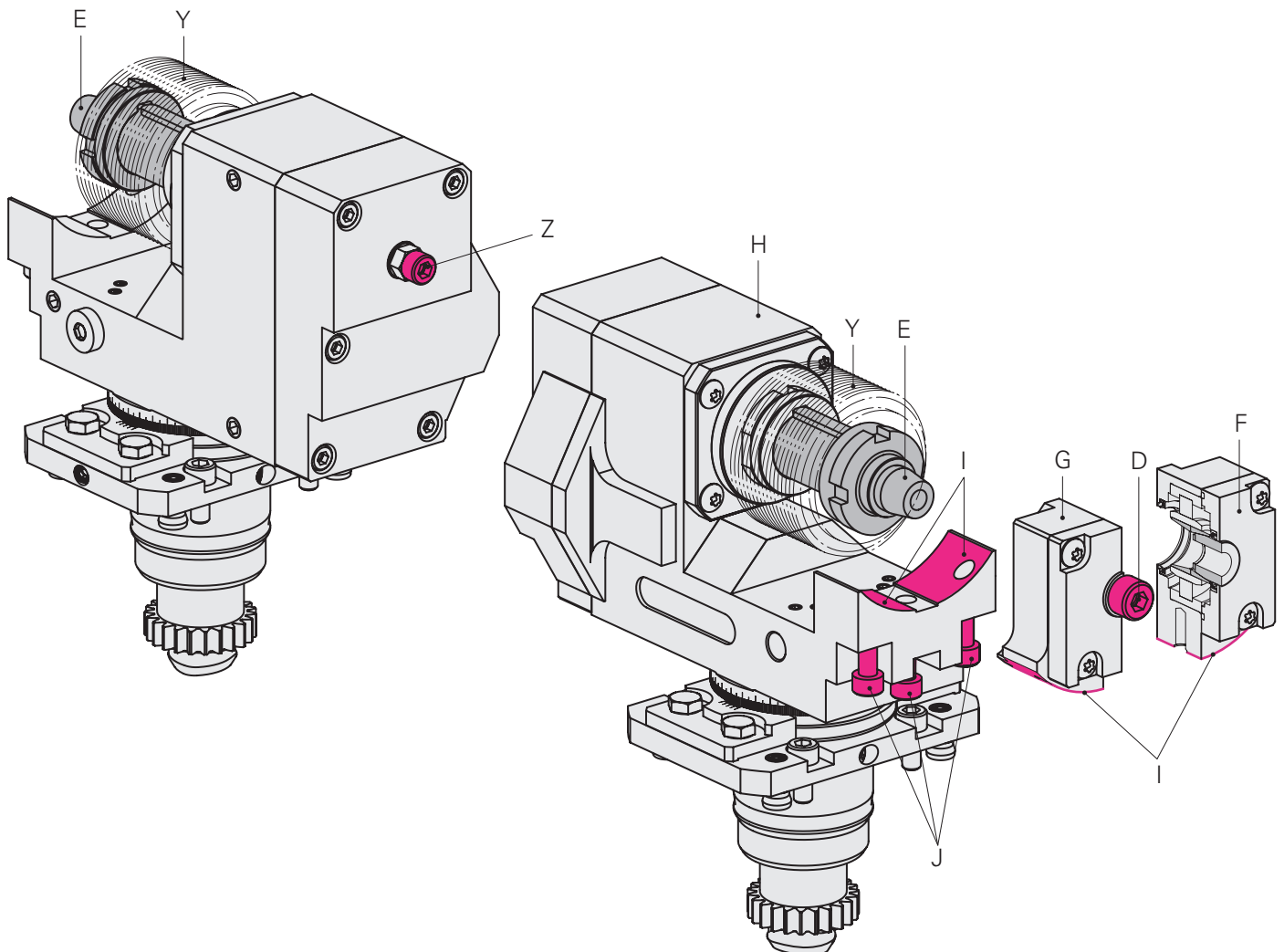

## Gear cutting unit, adjustable angle

Face contact cupped

### Angle adjustment

- Adjust the angle and speed as instructed by the manufacturer of the gear cutters
- Angular scale (W) is used for coarse adjustment
- Angle is adjusted when installed in the machine on the ground measuring surface (M)

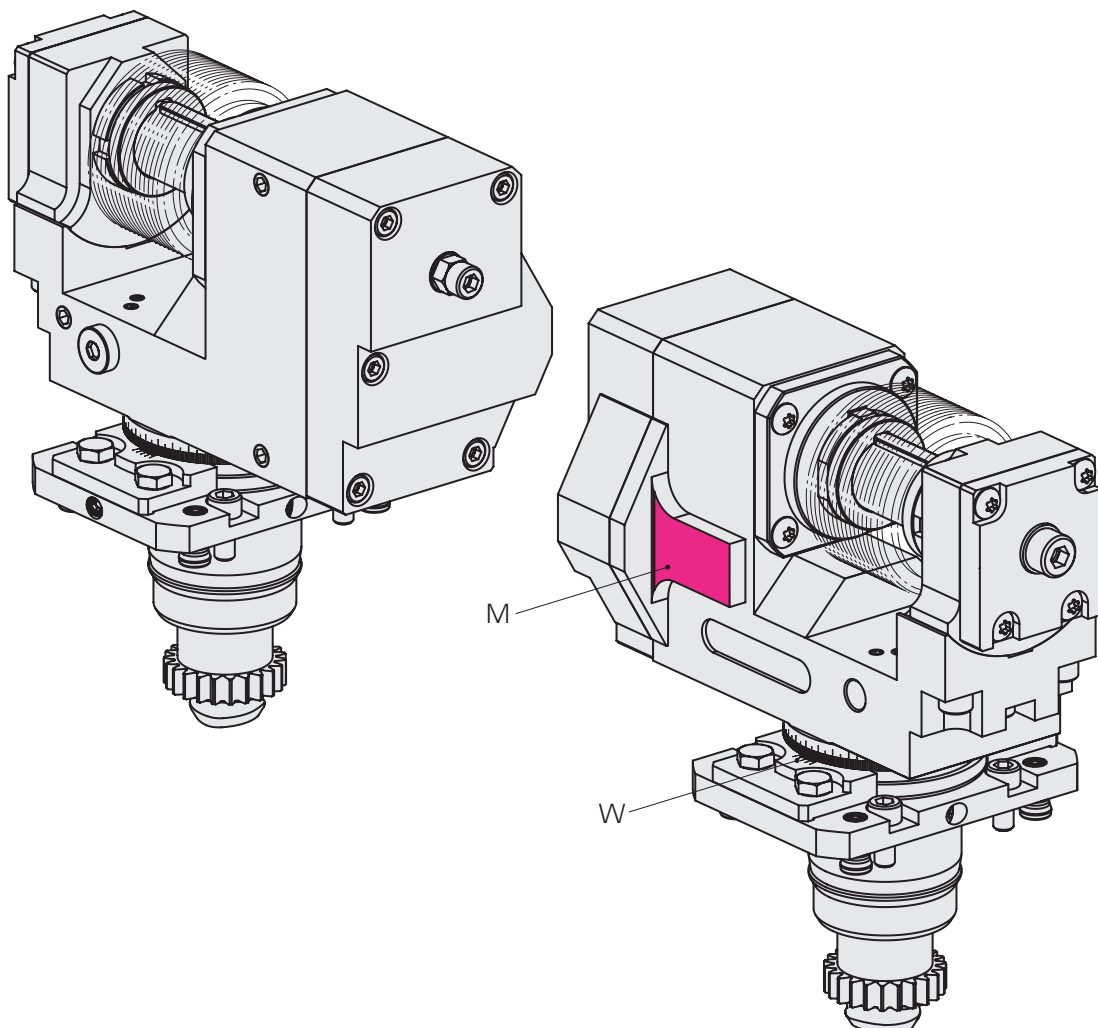

#### Product note

Gear cutting unit, adjustable angle - Face contact cupped  
W9800013EN-02.02.18



**Product note**

Gear cutting unit, adjustable angle - Face contact cupped  
W9800013EN-02.02.18



**INDEX-Werke GmbH & Co. KG  
Hahn & Tessky**

Plochinger Straße 92  
D-73730 Esslingen

Fon +49 711 3191-0  
Fax +49 711 3191-587

[info@index-werke.de](mailto:info@index-werke.de)  
[www.index-werke.de](http://www.index-werke.de)