

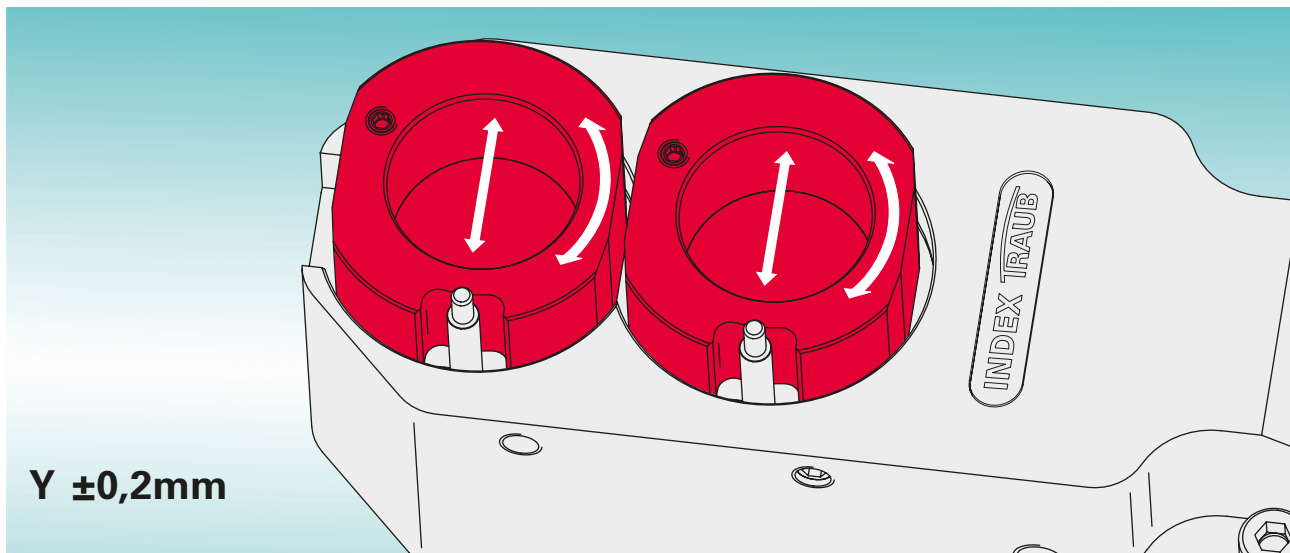

**Base holder with hydraulic expansion tool holder
Y-adjustable for multi-spindle lathes**

Base holder with hydraulic expansion tool holder Y-adjustable for multi-spindle lathes



The high productivity and efficiency of multi-spindle lathes, combined with the precision and flexibility of CNC single-spindle lathes, is the reason for the success of our MS series.

This successful concept has of course been retained in the development of our powerful tool holder for the MS series. The results are particularly easy-to-set tool holders, which combine mature basic concepts with the proven hydraulic expansion technology.

All the benefits of the new tool holder at a glance:

- extremely short setup times
thanks to easy and quick adjustment of the tool's Y-orientation by means of the eccentric sleeve (+/- 0.2 mm)
- very high change accuracy
- excellent damping properties
- Drill holder for a variety of tool mountings

Please feel free to contact us if you have any further questions +49 711 3191-9854
or visit us online: ixshop.ixworld.com

Selections

Use with drilling slides

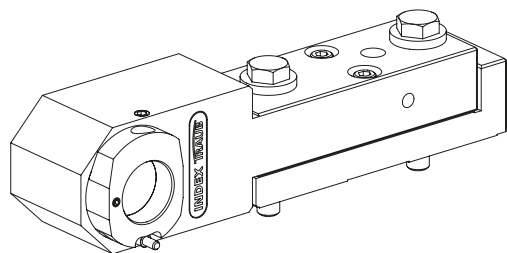

Use with cross slides

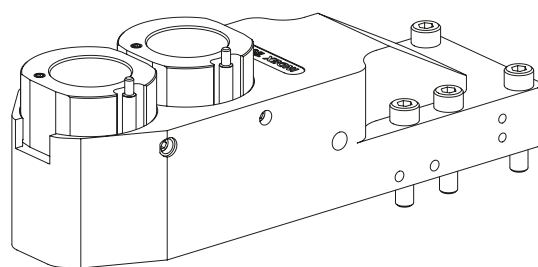
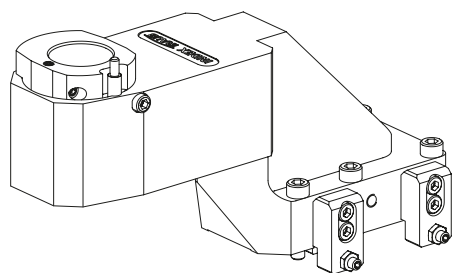

Use with cross slides with W serration

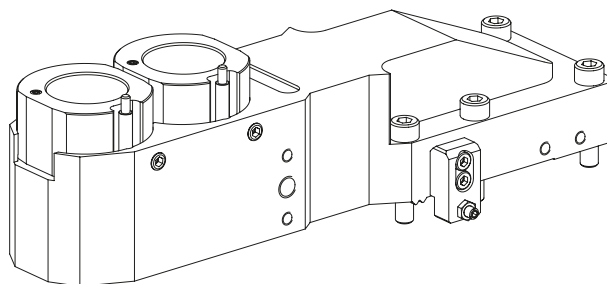
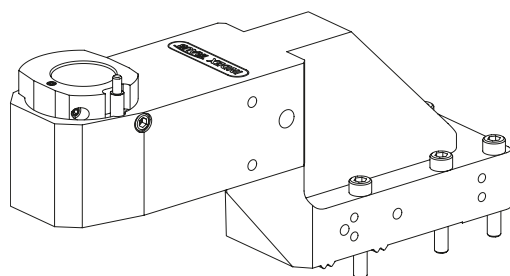

INDEX

INDEX-Werke GmbH & Co. KG
Hahn & Tessky

Plochinger Straße 92
D-73730 Esslingen

Fon +49 711 3191-0
Fax +49 711 3191-587

info@index-werke.de
www.index-werke.de