

## **Retrofitting for internal cooling of live tools**

## Retrofitting for internal cooling of live tools

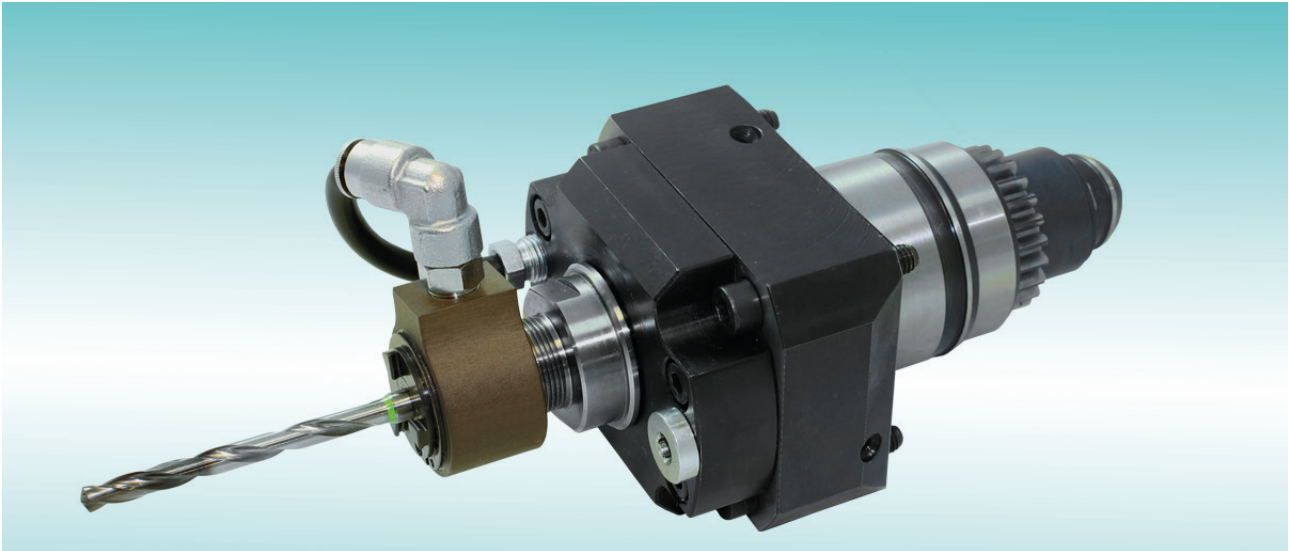

Convert live INDEX TRAUB tool holders from external cooling to internal cooling in just two minutes.

- cost-effective conversion from external to internal coolant supply
- suitable for ER and ERM clamping nuts on live tool holders and ER collets according to DIN 6499/ISO 15488
- Spindle speed up to 12000 rpm
- Coolant pressures up to 58 bar for RCR/ER, up to 100 bar or 150 bar for RCR/ERM
- Maintenance-free plain bearings
- For internal cooling (with sealing washers DS) and cooling along the tool (with cooling discs KS)
- RCR/ER for emulsion-based coolants and RCR/ERM for oil and emulsion-based coolant
- With the RC-ADP adapter, retrofitting is also suitable for live tool holders with internal thread

Please feel free to contact us if you have any further questions +49 711 3191-9854  
or visit us online: [ixshop.ixworld.com](http://ixshop.ixworld.com)

## Bring the correct amount of coolant to where it is needed

### Advantages with internal cooling

- Optimum cooling of the cutting edge
- Improved tool life
- Reduction of cycle time
- Excellent chip removal
- No stray and spray losses

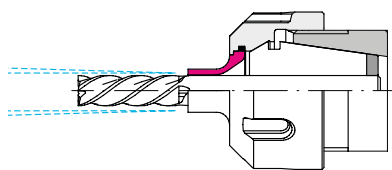
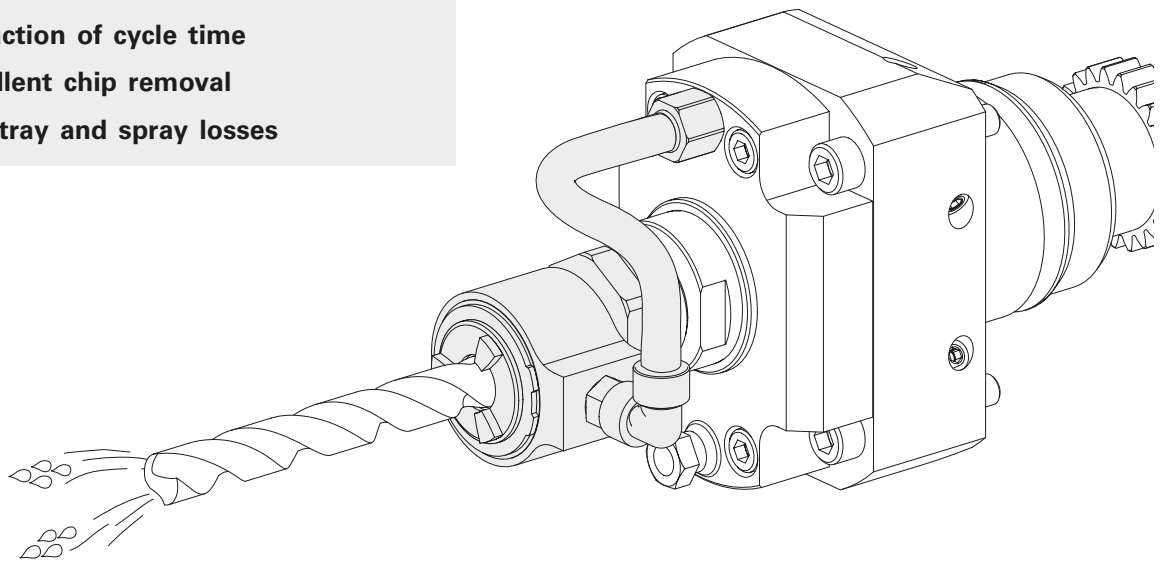

### Main features of cooling along the tool

Successful changeover with KS/ER cooling disc  
 The coolant is fed along the tool to the cutting edge  
 Suitable for cutting tools without internal cooling

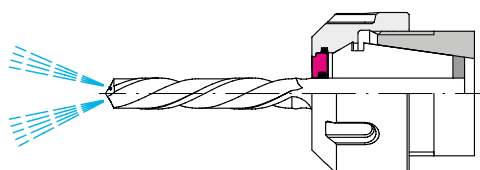

### Main features of internal cooling

Successful changeover with DS/ER sealing washer  
 Precise cooling at the cutting edge and improved chip removal  
 Lubrication and cooling through the cutting tool  
 Excellent surface finish

## Maximum cooling capabilities!

### For tool holders with external thread

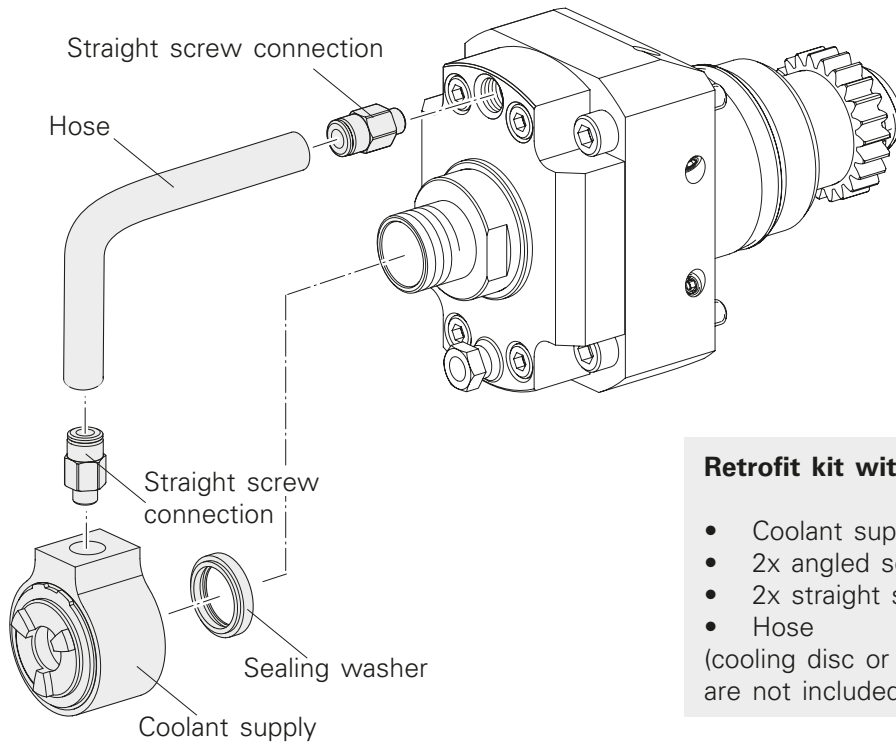

#### Retrofit kit with internal thread

- Coolant supply
  - 2x angled screw connection
  - 2x straight screw connection
  - Hose
- (cooling disc or sealing washer are not included)

### For tool holders with internal thread

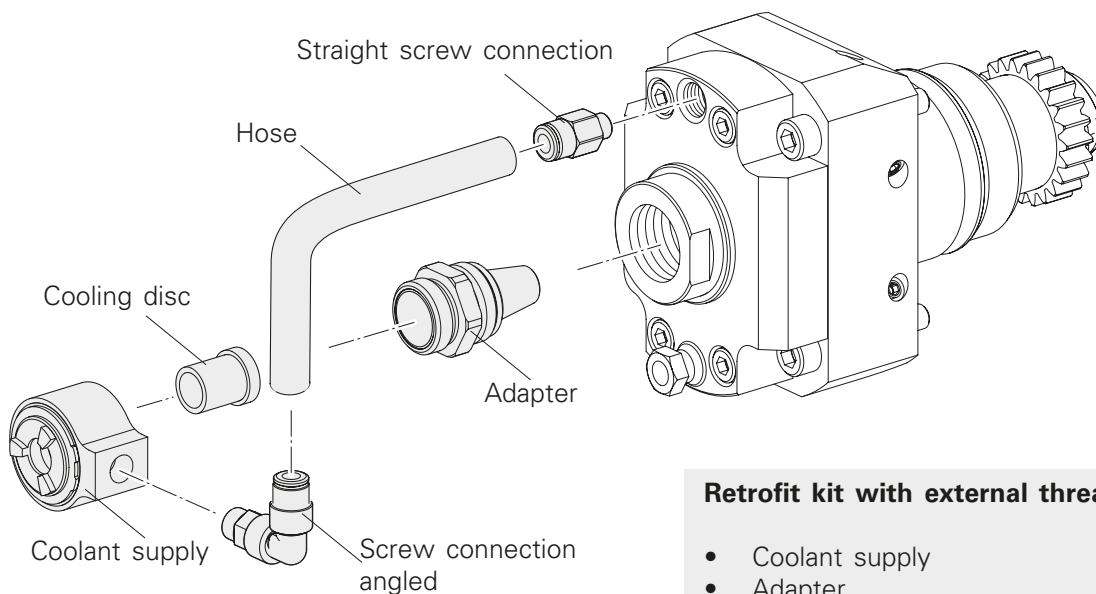

#### Retrofit kit with external thread

- Coolant supply
  - Adapter
  - 2x angled screw connection
  - 2x straight screw connection
  - Hose
- (cooling disc or sealing washer are not included)

## Retrofit kit with internal thread (for tool holders with external thread)

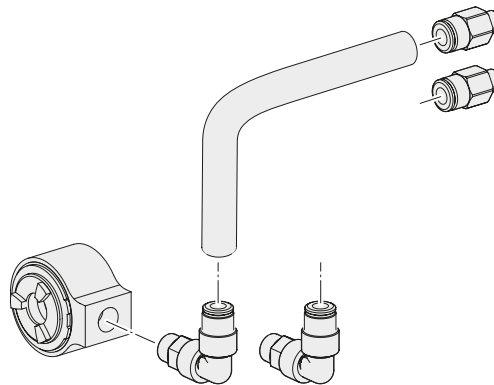

	Part No.		Part No.
<b>Internal thread ER16</b>	<b>12083154</b>	<b>Internal thread ER20</b>	<b>12083155</b>
consisting of:		consisting of:	
Coolant supply	12082909	Coolant supply	12082910
Hose	12061660	Hose	12061660
Screw connection, straight 1/8"	12083105	Screw connection, straight 1/8"	12083105
Screw connection, angled 1/8"	12061675	Screw connection, angled 1/8"	12061675
Screw connection, straight M6"	10028518	Screw connection, straight M6"	10028518
Screw connection, angled M6"	12083068	Screw connection, angled M6"	12083068
<b>Internal thread ER25</b>	<b>12083156</b>		
consisting of:			
Coolant supply	12082931		
Hose	12061660		
Screw connection, straight 1/8"	12083105		
Screw connection, angled 1/8"	12061675		
Screw connection, straight M6"	10028518		
Screw connection, angled M6"	12083068		
<b>Internal thread ER11 with reduced diameter Mini</b>	<b>12083107</b>	<b>Internal thread ER16 with reduced diameter Mini</b>	<b>12083108</b>
consisting of:		consisting of:	
Coolant supply	12072845	Coolant supply	12061390
Hose	12061660	Hose	12061660
Screw connection, straight 1/8"	12083105	Screw connection, straight 1/8"	12083105
Screw connection, angled 1/8"	12061675	Screw connection, angled 1/8"	12061675
Screw connection, straight M6"	10028518	Screw connection, straight M6"	10028518
Screw connection, angled M6"	12083068	Screw connection, angled M6"	12083068
<b>Internal thread ER20 with reduced diameter Mini</b>	<b>12083109</b>	<b>Internal thread ER25 with reduced diameter Mini</b>	<b>12083110</b>
consisting of:		consisting of:	
Coolant supply	12072846	Coolant supply	12072847
Hose	12061660	Hose	12061660
Screw connection, straight 1/8"	12083105	Screw connection, straight 1/8"	12083105
Screw connection, angled 1/8"	12061675	Screw connection, angled 1/8"	12061675
Screw connection, straight M6"	10028518	Screw connection, straight M6"	10028518
Screw connection, angled M6"	12083068	Screw connection, angled M6"	12083068

## Retrofit kit with external thread (for tool holders with internal thread)

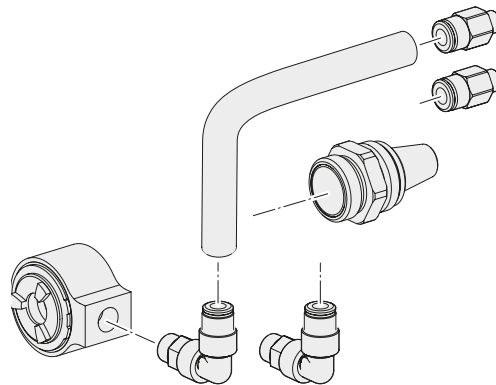

	Part No.		Part No.
<b>External thread ER16</b>	<b>12083215</b>	<b>External thread ER20</b>	<b>12083216</b>
consisting of:		consisting of:	
Coolant supply	12082909	Coolant supply	12082910
Adapter	12061394	Adapter	12082871
Hose	12061660	Hose	12061660
Screw connection, straight 1/8"	12083105	Screw connection, straight 1/8"	12083105
Screw connection, angled 1/8"	12061675	Screw connection, angled 1/8"	12061675
Screw connection, straight M6"	10028518	Screw connection, straight M6"	10028518
Screw connection, angled M6"	12083068	Screw connection, angled M6"	12083068
<b>External thread ER25</b>	<b>12083217</b>	<b>External thread ER32</b>	<b>12083218</b>
consisting of:		consisting of:	
Coolant supply	12082931	Coolant supply	12082932
Adapter	12082872	Adapter	12082873
Hose	12061660	Hose	12061660
Screw connection, straight 1/8"	12083105	Screw connection, straight 1/8"	12083105
Screw connection, angled 1/8"	12061675	Screw connection, angled 1/8"	12061675
Screw connection, straight M6"	10028518	Screw connection, straight M6"	10028518
Screw connection, angled M6"	12083068	Screw connection, angled M6"	12083068

## Everything also available separately!

			Part No.
	<b>Coolant supply</b>	ERM11 ERM16 ERM20 ERM25	12072845 12061390 12072846 12072847
	<b>Coolant supply</b>	ER16 ER20 ER25 ER32	12082909 12082910 12082931 12082932
	<b>Adapter</b>	ER16 ER20 ER25 ER32	12061394 12082871 12082872 12082873
	<b>Straight screw connection</b>	1/8" M6	12083105 10028518
	<b>Screw connection, angled</b>	1/8" M6	12061675 12083068
	<b>Hose</b>		12061660
	<b>Cooling disc</b> You will find the right <b>cooling disc</b> in our <b>iXshop</b>		
	<b>Sealing washer</b> You will find the right <b>sealing washer</b> in our <b>iXshop</b>		
	<b>Chuck key</b> You will find the right <b>chuck key</b> in our <b>iXshop</b>		

# INDEX

## **INDEX-Werke GmbH & Co. KG Hahn & Tessky**

Plochinger Straße 92  
D-73730 Esslingen

Fon +49 711 3191-0  
Fax +49 711 3191-587

[info@index-werke.de](mailto:info@index-werke.de)  
[www.index-werke.de](http://www.index-werke.de)