

Plug

Technical data

Electrical assemblies	Connector
Length	53.6 Millimeter
Width	8.6 Millimeter
Height	31.6 Millimeter
Number of wires/poles (ST)	25 Piece
Plug connection/type	SUB-D / DMP

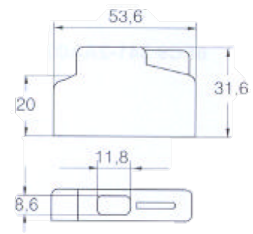

No 3-side view is currently available for this product

10187566
483240.0401

INDEX

Documents

No downloads available for this product