

## Grooving tool holding block Trapezoid 26

### Technical data

<b>Drive</b>	not live
<b>Direction</b>	left-handed run
<b>Mounting</b>	Trapezoid 26x4
<b>X [mm]</b>	55 (2.17")
<b>Y [mm]</b>	–
<b>Z [mm]</b>	21 (0.83)
<b>INDEX TRAUB products</b>	MS16-6 • MS16-6 Plus

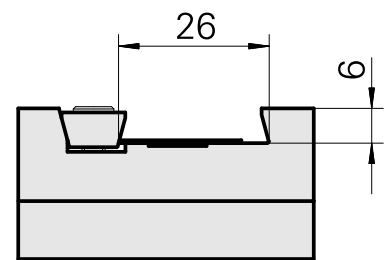
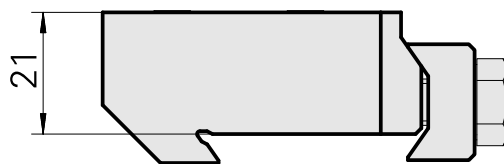
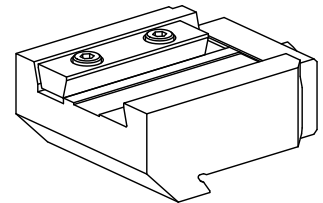

## **Documents**

No downloads available for this product