

## Probe holder KPS 45 Blum

### Technical data

|                      |  |
|----------------------|--|
| Shank KPS            | KPS 45   |
| Drive                | not live   |
| Cooling              | external   |
| Mounting             | Blum   |
| Pressure             | 80 bar   |
| reversible 180°      | yes  |
| X [mm]               | 30 (1.18")   |
| Y [mm]               | –  |
| Z [mm]               | –  |
| INDEX TRAUB products | TNL20 • TNL32 • TNL32-11 •<br>TNL32-11 compact • TNL20-11<br>• TNL32 compact • TNK40.2-10 •<br>TNL20.2 • TNK40.2 |

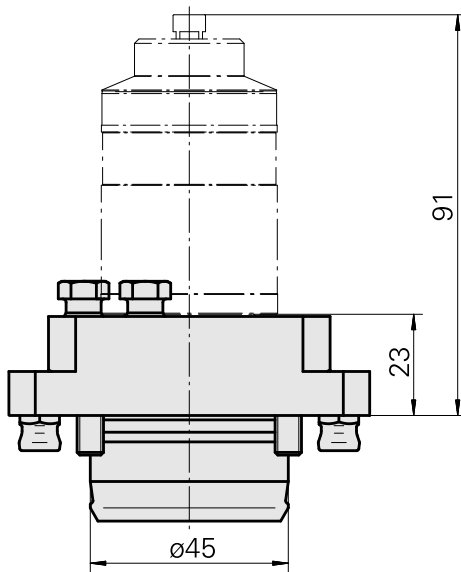

## Documents

No downloads available for this product

## Accessories

Required for operation

### Not defined

Product ID : 12133362

Previous product ID :

---

### Not defined

Product ID : 12133363

Previous product ID :

---

## Optional accessories

### Tool holder accessories

#### Coolant tube, L=100 mm (3.93")

Product ID : 10309869

Previous product ID : W9990658

TH accessories  
category  
Cooling lubricant tube

Mounting  
D6

### Other accessories

#### Not defined

Product ID : 12006155

Previous product ID :

---

#### Not defined

Product ID : 12006154

Previous product ID :

---

Chip Protection

Product ID : 12007557

Previous product ID :

---

Conical ring DIN 3862-6-St

Product ID : 10528470

Previous product ID : 471060.0601

---

THREADED BUSHING M10x1 Stahl verzinkt A3C

Product ID : 10707394

Previous product ID : 471112.06

---