

Basic holder Dovetail (ABC), vertically adjustable

Technical data

| | |
|----------------------|----------------|
| Shank VDI | Dovetail (ABC) |
| Drive | not live |
| Fixation VDI | none |
| Pressure | 20 bar |
| reversible 180° | no |
| X [mm] | 62 (2.44") |
| Y [mm] | - |
| Z [mm] | -30 (-1.18) |
| INDEX TRAUB products | ABC • ABC.2 |

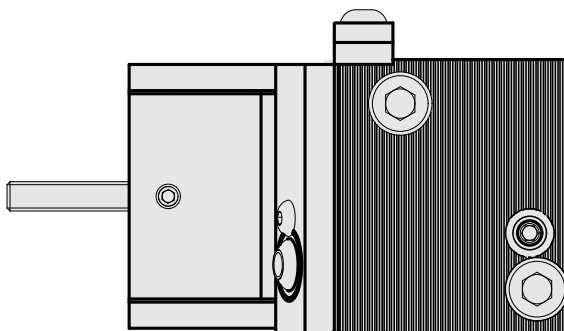
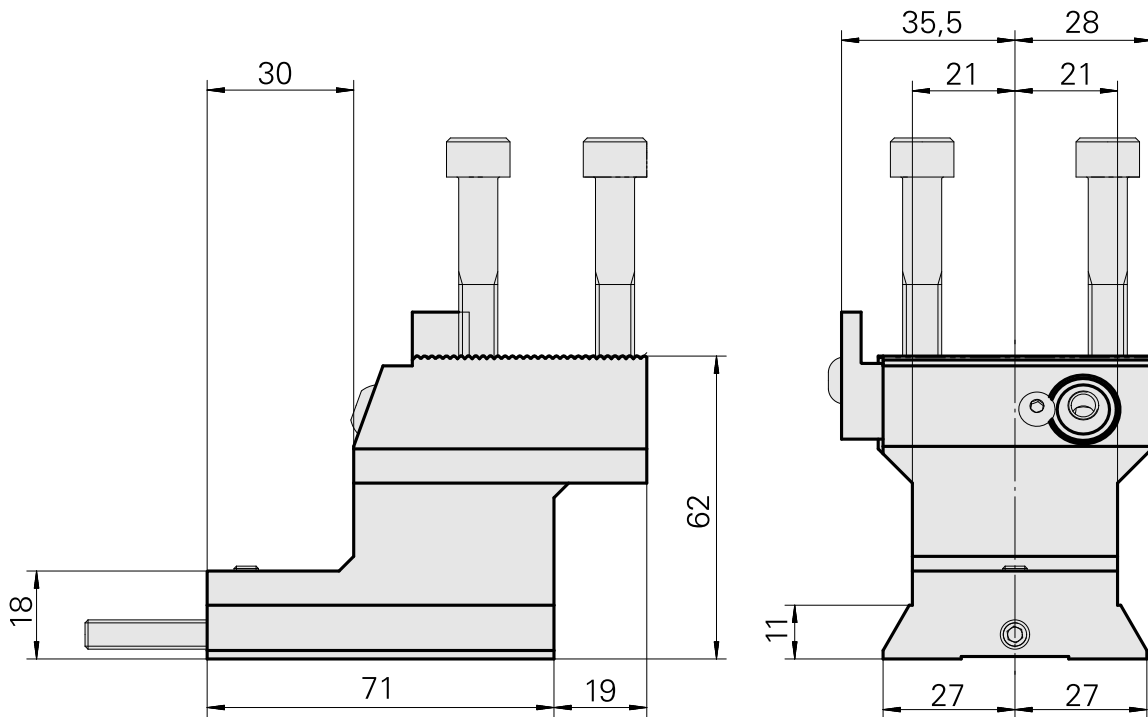
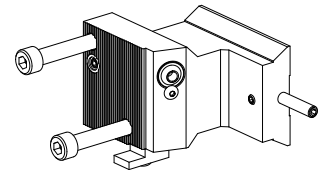

Documents

No downloads available for this product

Accessories

Optional accessories

Tool holders with VDI shank

[Drill holding block D1", horizontally adjustable](#)

Product ID : 10935806

Previous product ID : W9990242

| | | | |
|-------------------------------------|-------------------------|--------------------|---------------------|
| Drive not live | Cooling internal | Pressure 20 bar | Mounting D1" |
| reversible 180° no | X [mm] 23.55 (0.93") | Y [mm] – | Z [mm] 50 (1.97) |
| INDEX TRAUB products ABC • ABC.2 | | | |

[Drill holding block D25 \(0.98 "\)](#)

Product ID : 10159310

Previous product ID : W9990045

| | | | |
|-------------------------|---------------------|--------------------|-------------------------------------|
| Drive not live | Cooling internal | Pressure 20 bar | Mounting D25 |
| X [mm] 23.55 (0.93") | Y [mm] – | Z [mm] – | INDEX TRAUB products ABC • ABC.2 |

[Drill holding block D25 \(0.98 "\)](#)

Product ID : 10065358

Previous product ID : W9990243

| | | | |
|---------------------|-------------------------------------|-------------------------|--------------------|
| Drive not live | Fixation VDI none | Cooling internal | Pressure 20 bar |
| Mounting D25 | reversible 180° no | X [mm] 33.55 (1.32") | Y [mm] – |
| Z [mm] 50 (1.97) | INDEX TRAUB products ABC • ABC.2 | | |

Other accessories

[SPRAY NOZZLE 14D/M6](#)

Product ID : 10358770

Previous product ID : 474550.0121

[Lens head screw](#)

Product ID : 10344546

Previous product ID : 410243.0406
