

## Basic holder VDI 20, horizontally adjustable

### Technical data

|                      |             |
|----------------------|-------------|
| Shank VDI            | VDI 20      |
| Drive                | not live    |
| Fixation VDI         | W serration |
| Pressure             | 80 bar      |
| reversible 180°      | no          |
| X [mm]               | 20 (0.79")  |
| Y [mm]               | –           |
| Z [mm]               | –           |
| INDEX TRAUB products | C100        |

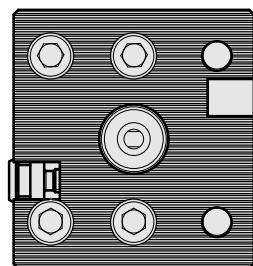
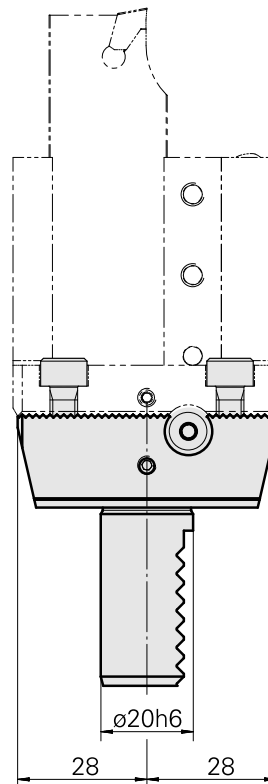
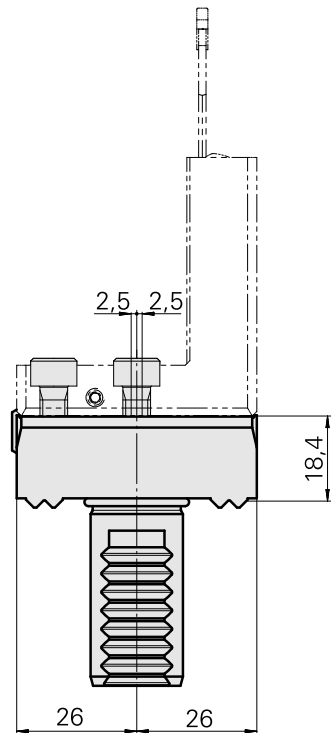
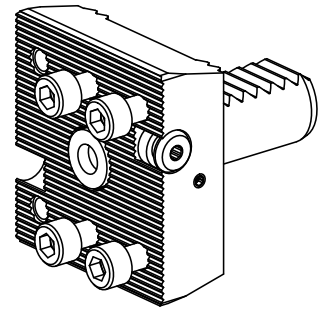

## Documents

No downloads available for this product

## Accessories

### Optional accessories

#### Tool holders with VDI shank

#### [Grooving tool holding block Trapezoid 26, horizontally adjustable](#)

Product ID : 10469292

Previous product ID : W9990001

|                      |                     |                     |                              |
|----------------------|---------------------|---------------------|------------------------------|
| Drive<br>not live    | Cooling<br>external | Pressure<br>20 bar  | Mounting<br>Trapezoid 26x5   |
| X [mm]<br>56 (2.20") | Y [mm]<br>–         | Z [mm]<br>15 (0.59) | INDEX TRAUB products<br>C100 |

#### [Grooving tool holding block Trapezoid 26, horizontally adjustable](#)

Product ID : 10303482

Previous product ID : W9990002

|                      |                     |                     |                              |
|----------------------|---------------------|---------------------|------------------------------|
| Drive<br>not live    | Cooling<br>external | Pressure<br>40 bar  | Mounting<br>Trapezoid 26x5   |
| X [mm]<br>56 (2.20") | Y [mm]<br>–         | Z [mm]<br>15 (0.59) | INDEX TRAUB products<br>C100 |