

## Change parts

### Technical data

|                             |               |
|-----------------------------|---------------|
| <b>INDEX TRAUB products</b> | TNL32 compact |
| <b>Spindle clearance</b>    | 32mm          |
| <b>Machining side</b>       | Main spindle  |
| <b>Spindle mounting</b>     | Taper 1:4     |
| <b>Clamping device size</b> | 1536E/F37     |

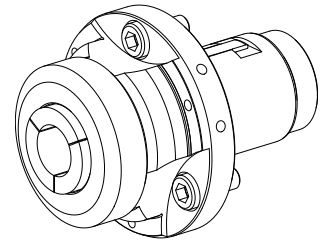

No 3-side view is currently available for this product

## **Documents**

No downloads available for this product