

---

## Steady rest VDI 30, D 8 - 65 mm (0.31 - 2.56 ")

### Technical data

Shank VDI	VDI 30
Drive	not live
Fixation VDI	TRAUB bar
Cooling	external
Pressure	20 bar
reversible 180°	yes
Data carrier	check tool station bore
X [mm]	125.68 (4.95")
Y [mm]	–
Z [mm]	15 (0.59)
INDEX TRAUB products	TNX65/42

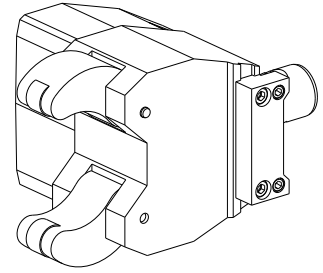

### Note

The machine must undergo preparation for a steady rest (hydraulic connection)!

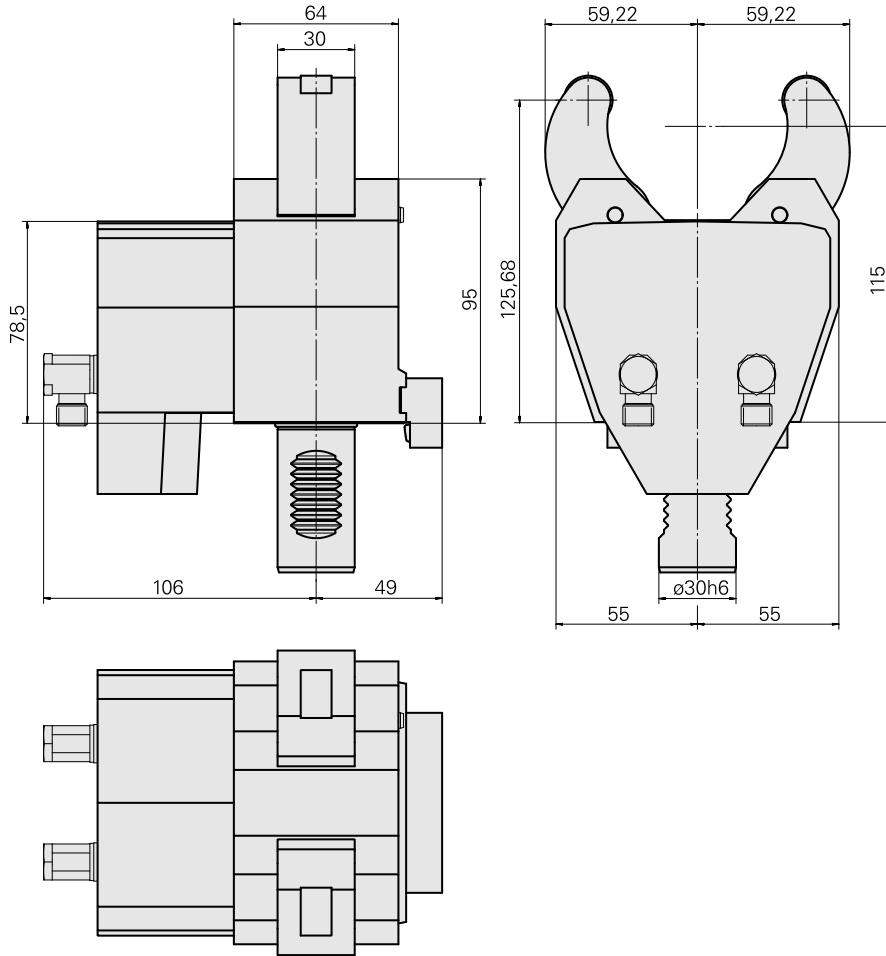

10496836  
W1340010

**INDEX**

---

## **Documents**

No downloads available for this product