

## Leaf spring, 60 mm

### Technical data

<b>INDEX TRAUB products</b>	ABC • C100 • G200 • G220 • ABC.2
<b>Function (Component)</b>	Leaf spring
<b>Spindle clearance</b>	60mm
<b>Bar loading magazine</b>	INDEX MBL • INDEX MBF
<b>Clamping stroke</b>	7mm (0.28") • 12.5mm (0.49") • 20mm (0.79")
<b>Machining side</b>	Main spindle
<b>Machine number range</b>	6-digit machine number • 8-digit machine number
<b>Material diameter</b>	15mm (0.59") • 16mm (0.63") • 17mm (0.67") • 18mm (0.71") • 19mm (0.75") • 20mm (0.79") • 21mm (0.83") • 22mm (0.87")

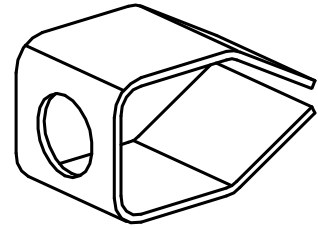

No 3-side view is currently available for this product

## **Documents**

No downloads available for this product