

## Back end unit A200 Quick-change insert D

### Technical data

<b>Slide system MS</b>	A200
<b>Drive</b>	not live
<b>Fixation MS</b>	Splined key/pin
<b>Cooling</b>	external and internal
<b>Pressure</b>	extern. 40 bar, intern. 80 bar
<b>Mounting</b>	Quick-change insert D42, doub.
<b>X [mm]</b>	-
<b>Y [mm]</b>	-
<b>Z [mm]</b>	-
<b>INDEX TRAUB products</b>	A200-6

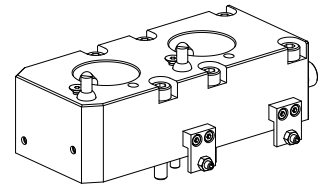

### Note

When there is rear end machining with 3 fixed tool holders, mounting occurs in position 5.1!

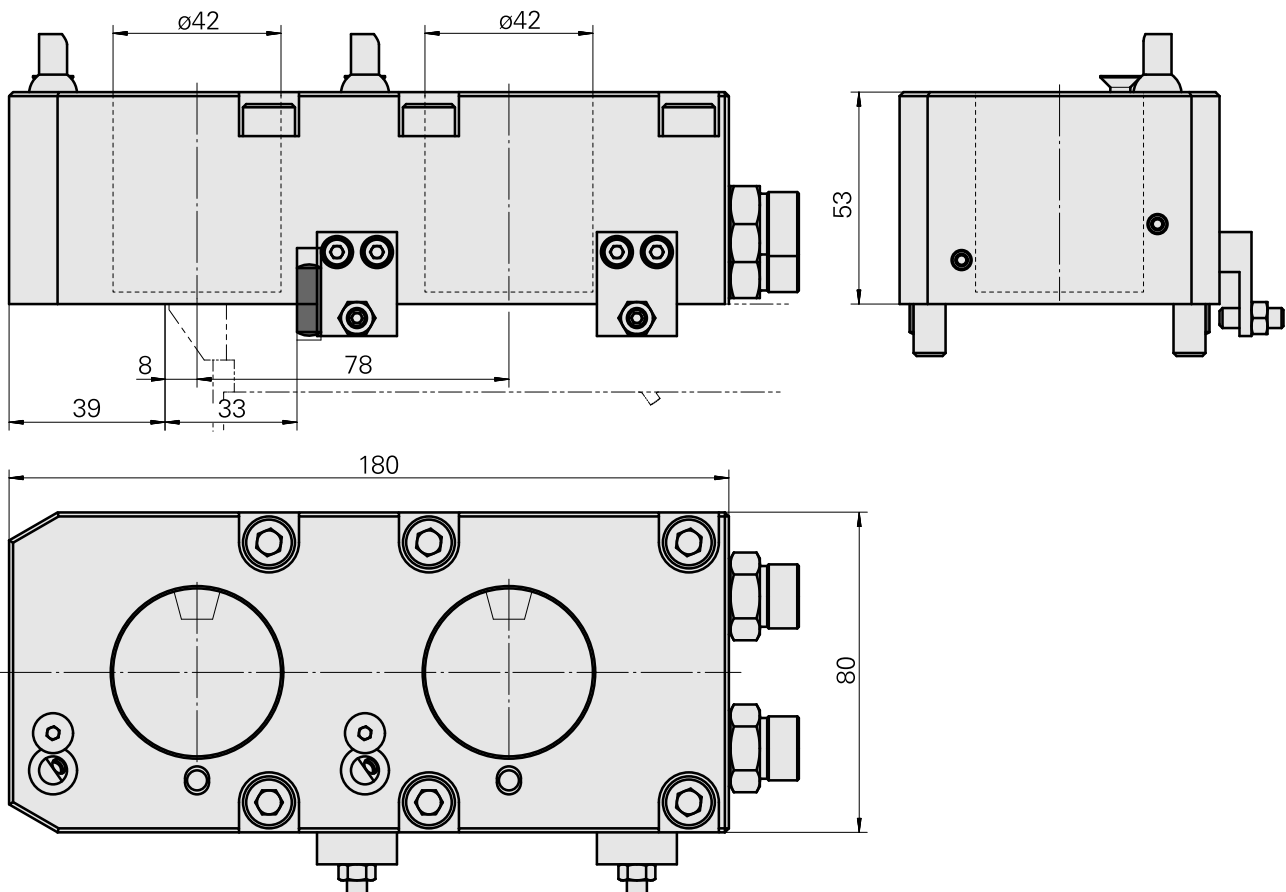

## Documents

No downloads available for this product

## Accessories

### Optional accessories

#### MS tool holders

##### [Blanking plug](#)

Product ID : 10887763

Previous product ID : W9990311

Drive not live	Fixation MS Shank D42	X [mm] 16 (0.63")	Y [mm] -
Z [mm] -	INDEX TRAUB products MS52C • A200-6 • MS52-6.3		

##### [Drill holding block D25](#)

Product ID : 10690799

Previous product ID : W9990313

Drive not live	Fixation MS Shank D42	Mounting D25	X [mm] 18 (0.71")
Y [mm] -	Z [mm] -	INDEX TRAUB products MS52C • A200-6 • MS52-6.3	

##### [Drill holding block ER32](#)

Product ID : 10197173

Previous product ID : W9990312

Drive not live	Fixation MS Shank D42	Mounting ER32	X [mm] 18 (0.71")
Y [mm] -	Z [mm] -	INDEX TRAUB products MS52C • A200-6 • MS52-6.3	

#### Other accessories

---

Lubrication pipe L=20

Product ID : 10510228  
Previous product ID : M11451.40

---

Countersunk screw M 5x10/T25 verzinkt 402315 10

Product ID : 11038225  
Previous product ID : 410362.0510

---

Grub screw

Product ID : 10749622  
Previous product ID : 410191.1210

---