

Grooving tool and stop holder MS32/MS40

Technical data

| | |
|-----------------------------|------------------|
| Slide system MS | MS32/MS40 |
| Drive | not live |
| Fixation MS | Dovetail |
| Cooling | internal |
| Pressure | 80 bar |
| Direction | right-handed run |
| Mounting | Trapezoid 32x5 |
| X [mm] | 70 (2.76") |
| Y [mm] | – |
| Z [mm] | 14.5 (0.57) |
| INDEX TRAUB products | MS40-6 |

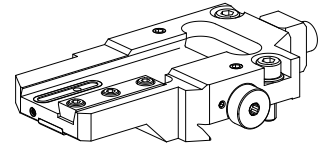

Note

When there is rear end machining with 3 fixed tool holders, mounting occurs in position 6.2!

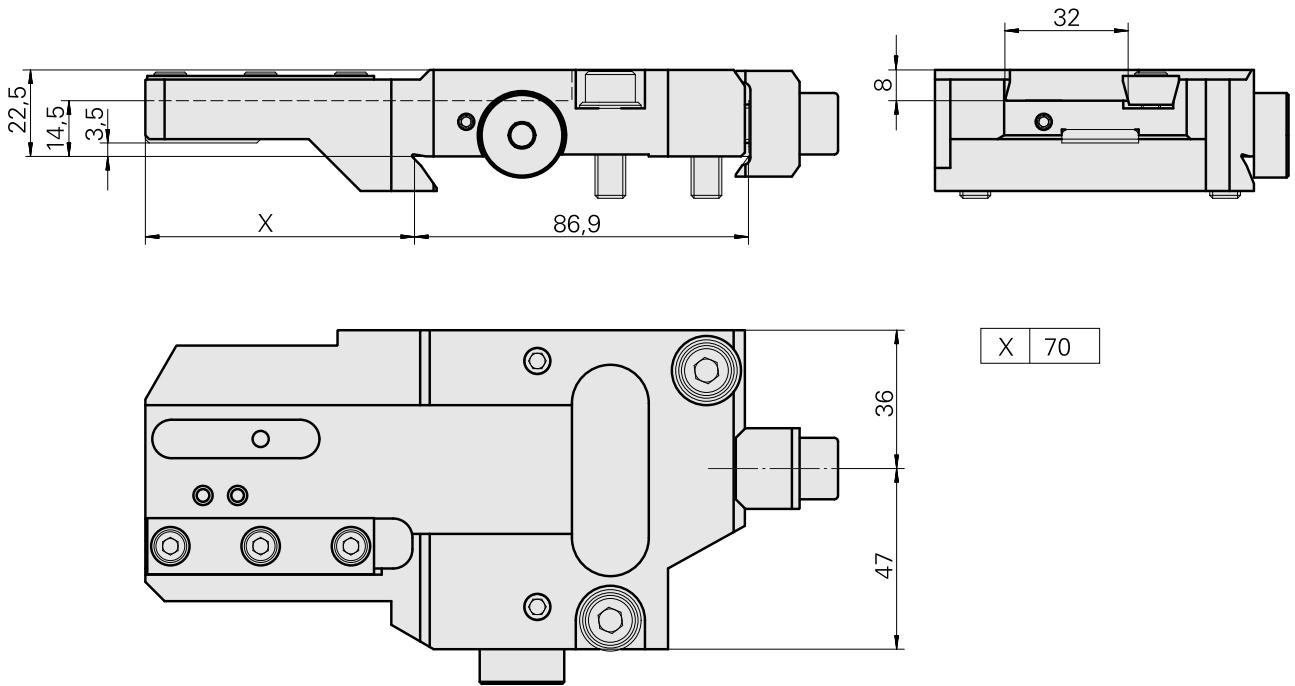

Documents

No downloads available for this product

Accessories

Optional accessories

Other accessories

[Stop plate](#)

Product ID : 10217059

Previous product ID : W00019.0064

[Countersunk screw M 4x 8/T20 verzinkt 402314 8](#)

Product ID : 10586100

Previous product ID : 410362.0408
