

Grooving tool holding block Trapezoid 32, vertically adjustable

Technical data

| | |
|-----------------------------|---|
| Drive | not live |
| Cooling | external and internal |
| Pressure | 20 bar |
| Mounting | Trapezoid 32x5 |
| X [mm] | 60 (2.36") |
| Y [mm] | – |
| Z [mm] | 32 (1.26) |
| INDEX TRAUB products | C42/65 • G160 • ABC • C100 • C200 • G200 • G200.2 • G220 • ABC.2 |

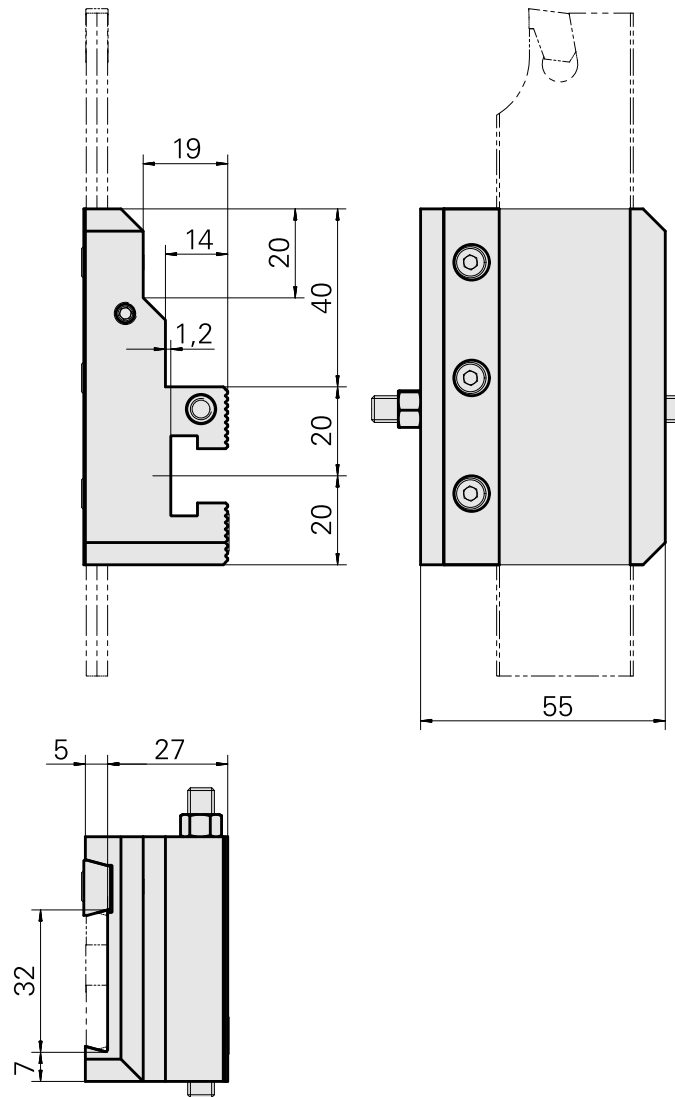
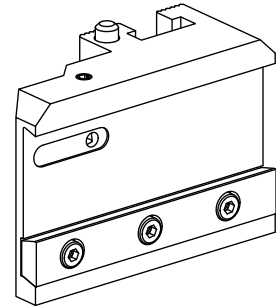

Documents

No downloads available for this product