

## Drilling tool holder VDI 30 DIN 1835 B/E, Form E1

### Technical data

|                             |                         |
|-----------------------------|-------------------------|
| <b>Shank VDI</b>            | VDI 30                  |
| <b>Drive</b>                | not live                |
| <b>Fixation VDI</b>         | none                    |
| <b>Cooling</b>              | internal                |
| <b>Pressure</b>             | 80 bar                  |
| <b>Mounting</b>             | DIN 1835 B/E D20        |
| <b>reversible 180°</b>      | no                      |
| <b>Data carrier</b>         | check tool station bore |
| <b>X [mm]</b>               | 67 (2.64")              |
| <b>Y [mm]</b>               | -                       |
| <b>Z [mm]</b>               | -                       |
| <b>INDEX TRAUB products</b> | TNA300                  |

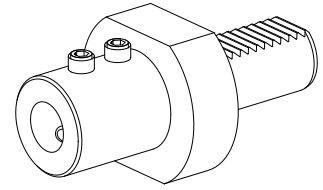

## **Documents**

No downloads available for this product