

## Basic holder MS32/MS40 Hydraulic expansi, double

### Technical data

<b>Slide system MS</b>	MS32/MS40
<b>Drive</b>	not live
<b>Fixation MS</b>	Dovetail
<b>Mounting</b>	Hydraulic expansion chuck D36
<b>X [mm]</b>	73 + 128 (2.87" + 5.04")
<b>Y [mm]</b>	–
<b>Z [mm]</b>	79.5 (3.13)
<b>INDEX TRAUB products</b>	MS32-6.3 • MS32C • MS32-6.2 • MS40-6

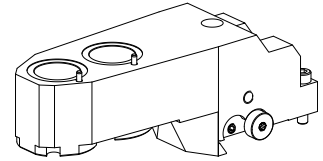

### Note

Specially for INDEX MS32-6 with 3-axis-handling in positions 1.2, 2.1 and 5.1!

No 3-side view is currently available for this product

---

## Documents

### Product notes

[DE \(pdf\)](#)

[EN \(pdf\)](#)

[FR \(pdf\)](#)

## Accessories

### Optional accessories

#### MS tool holders

##### [Blanking plug](#)

Product ID : 12013851

Previous product ID :

Drive not live	Fixation MS Clamping ring D28.5	X [mm] -	Y [mm] -
Z [mm] -			

#### Other accessories

##### [Not defined Standard MS32](#)

Product ID : 10536748

Previous product ID : WM3600.3100F

---