

Turning tool holder MS16/MS22 Square 12x

Technical data

| | |
|-----------------------------|---|
| Slide system MS | MS16/MS22 |
| Drive | not live |
| Fixation MS | Dovetail |
| Cooling | external |
| Pressure | 20 bar |
| Direction | right-handed run |
| Mounting | Square 12x12 |
| X [mm] | 55 (2.17") |
| Y [mm] | – |
| Z [mm] | 13 (0.51) |
| INDEX TRAUB products | MS16-6 • MS22-8 • MS22-6 • MS24-6 • MS24-8 • MS16-6 Plus |

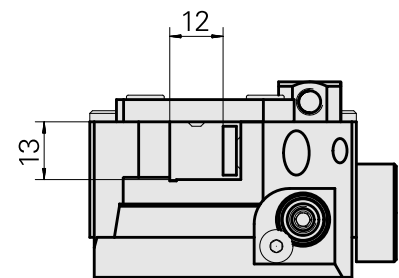
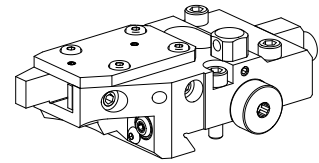

| | |
|---|----|
| X | 55 |
|---|----|

Documents

No downloads available for this product

Accessories

Optional accessories

Tool holder accessories

[tube, L = 100 mm \(3.93"\) with nut](#)

Product ID : 10938183

Previous product ID : W00019.0164

TH accessories
category
Cooling lubricant tube

Mounting
M6

Other accessories

[BALL SPRAY NOZZLE 12D/M6](#)

Product ID : 10602750

Previous product ID : 474550.0101

[Lens head screw](#)

Product ID : 10344546

Previous product ID : 410243.0406

[Coolant nozzle D10; M6](#)

Product ID : 10562562

Previous product ID : W00019.0153
