

Drilling tool holder D20

Données techniques

| | |
|----------------------|--|
| Drive | not live |
| Fixation MS | Clamping ring D28.5 |
| Cooling | internal |
| Pressure | 80 bar |
| Mounting | D20 |
| X [mm] | - |
| Y [mm] | - |
| Z [mm] | - |
| INDEX TRAUB products | MS16-6 • MS22-6 • MS22-8 • MS24-6 • MS16-6 Plus |

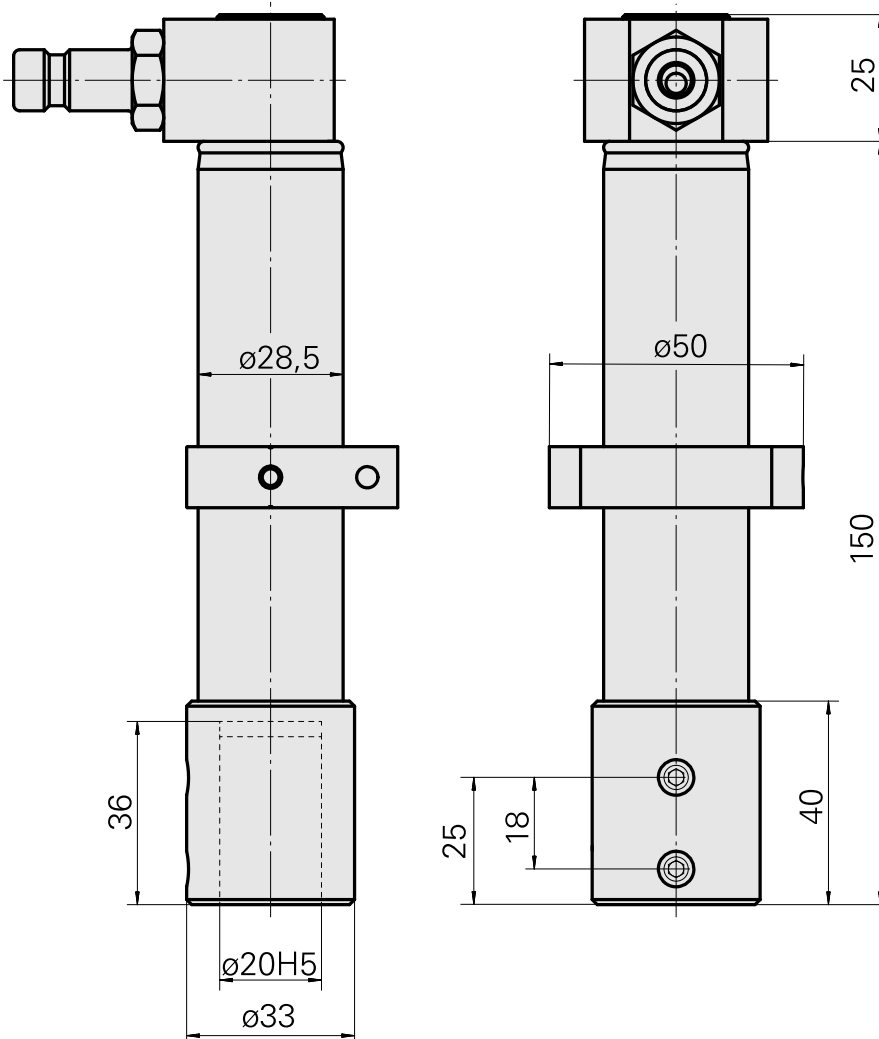

Documents

Aucun téléchargement n'est disponible pour ce produit

Accessoires

Accessoires optionnels

Tool holder accessories

[Mounting sleeve with collar D20/ 3mm](#)

ID produit : 10908982

Ancienne ID produit : W68511.0403

TH accessories
category
Mounting sleeve with
collar

Mounting
D20

Tool mounting
3mm

[Mounting sleeve with collar D20/ 4mm](#)

ID produit : 10215398

Ancienne ID produit : W68511.0404

TH accessories
category
Mounting sleeve with
collar

Mounting
D20

Tool mounting
4mm

[Mounting sleeve with collar D20/ 5mm](#)

ID produit : 10832261

Ancienne ID produit : W68510.0405

TH accessories
category
Mounting sleeve with
collar

Mounting
D20

Tool mounting
5mm

Mounting sleeve with collar D20/ 6mm

ID produit : 10048953
Ancienne ID produit : W68510.0406

| | | |
|--|--------------|-------------------|
| TH accessories category Mounting sleeve with collar | Mounting D20 | Tool mounting 6mm |
|--|--------------|-------------------|

Mounting sleeve with collar D20/ 7mm

ID produit : 10224332
Ancienne ID produit : W68510.0407

| | | |
|--|--------------|-------------------|
| TH accessories category Mounting sleeve with collar | Mounting D20 | Tool mounting 7mm |
|--|--------------|-------------------|

Mounting sleeve with collar D20/ 8mm

ID produit : 10184191
Ancienne ID produit : W68510.0408

| | | |
|--|--------------|-------------------|
| TH accessories category Mounting sleeve with collar | Mounting D20 | Tool mounting 8mm |
|--|--------------|-------------------|

Mounting sleeve with collar D20/ 10mm

ID produit : 10258187
Ancienne ID produit : W68510.0410

| | | |
|--|--------------|--------------------|
| TH accessories category Mounting sleeve with collar | Mounting D20 | Tool mounting 10mm |
|--|--------------|--------------------|

Mounting sleeve with collar D20/ 11mm

ID produit : 11010085
Ancienne ID produit : W68510.0411

| | | |
|--|--------------|--------------------|
| TH accessories category Mounting sleeve with collar | Mounting D20 | Tool mounting 11mm |
|--|--------------|--------------------|

[Mounting sleeve with collar D20/ 12mm](#)

ID produit : 10584331
Ancienne ID produit : W68510.0412

| | | |
|--|-----------------|-----------------------|
| TH accessories category Mounting sleeve with collar | Mounting D20 | Tool mounting 12mm |
|--|-----------------|-----------------------|

[Mounting sleeve with collar D20/ 14mm](#)

ID produit : 10681512
Ancienne ID produit : W68510.0414

| | | |
|--|-----------------|-----------------------|
| TH accessories category Mounting sleeve with collar | Mounting D20 | Tool mounting 14mm |
|--|-----------------|-----------------------|

[Mounting sleeve with collar D20/ 15mm](#)

ID produit : 10804219
Ancienne ID produit : W68510.0415

| | | |
|--|-----------------|-----------------------|
| TH accessories category Mounting sleeve with collar | Mounting D20 | Tool mounting 15mm |
|--|-----------------|-----------------------|

[Mounting sleeve with collar D20/ 16mm](#)

ID produit : 10324366
Ancienne ID produit : W68510.0416

| | | |
|--|-----------------|-----------------------|
| TH accessories category Mounting sleeve with collar | Mounting D20 | Tool mounting 16mm |
|--|-----------------|-----------------------|

Autres accessoires

[QUICK COUPLING SP-006-0-WR513-11-2 Serie LP](#)

ID produit : 10837142
Ancienne ID produit : 474940.0112

10617778
W5190014

INDEX

QUICK DISCONNECT FITTING SP-006-1-WR013-11 Serie LP

ID produit : 10186287

Ancienne ID produit : 474946.25
