

Ballscrew D20x4 H70 L235

Technical features

Stroke (mm)	70 Millimeter
Length (mm)	235 Millimeter
Nominal diameter (mm)	20 Millimeter
Screw pitch (mm)	4 Millimeter
Mechanical component type	Ballscrew

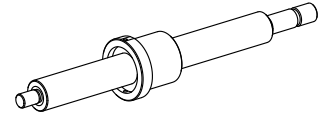

No 3-side view is currently available for this product

11034783
M91211.

INDEX

Documents

No downloads available for this product