

## Polygon turning unit Circular prism 1:3, 8,000 rpm

### Technical data

<b>Shank TNL</b>	Circular prism
<b>Drive</b>	Spur gear TRAUB TNL12
<b>Fixation TNL</b>	Central tensioning screw
<b>Speed ratio</b>	1:3
<b>Mounting</b>	D12
<b>reversible 180°</b>	no
<b>Direction</b>	opposite to drive direction
<b>X [mm]</b>	20.5 (0.81")
<b>Y [mm]</b>	—
<b>Z [mm]</b>	13.5 (0.53)
<b>INDEX TRAUB products</b>	TNL12

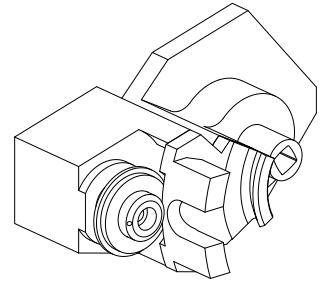

### Note

The maximum diameter of the polygon tool is 69 mm! Adjacent stations can only be used to a limited extent!

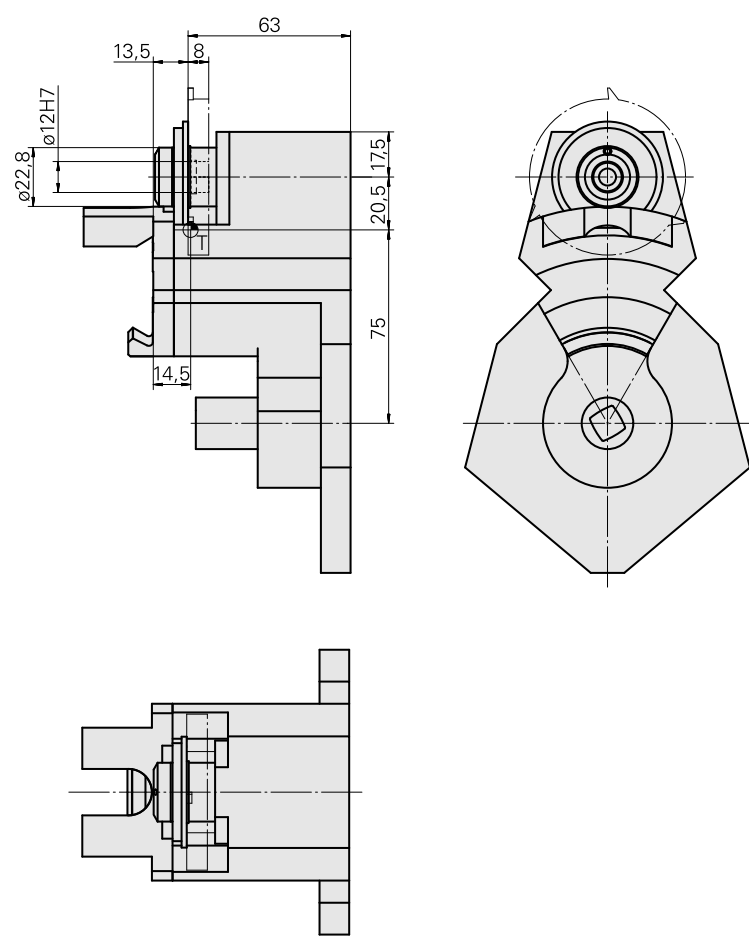

---

**Documents**

No downloads available for this product