

Grooving tool holding block square 20x20, vertically adjustable

Technical data

Drive	not live
Mounting	Square 20x20
reversible 180°	yes
X [mm]	37 (1.46")
Y [mm]	–
Z [mm]	28 (1.10)
INDEX TRAUB products	ABC • ABC.2

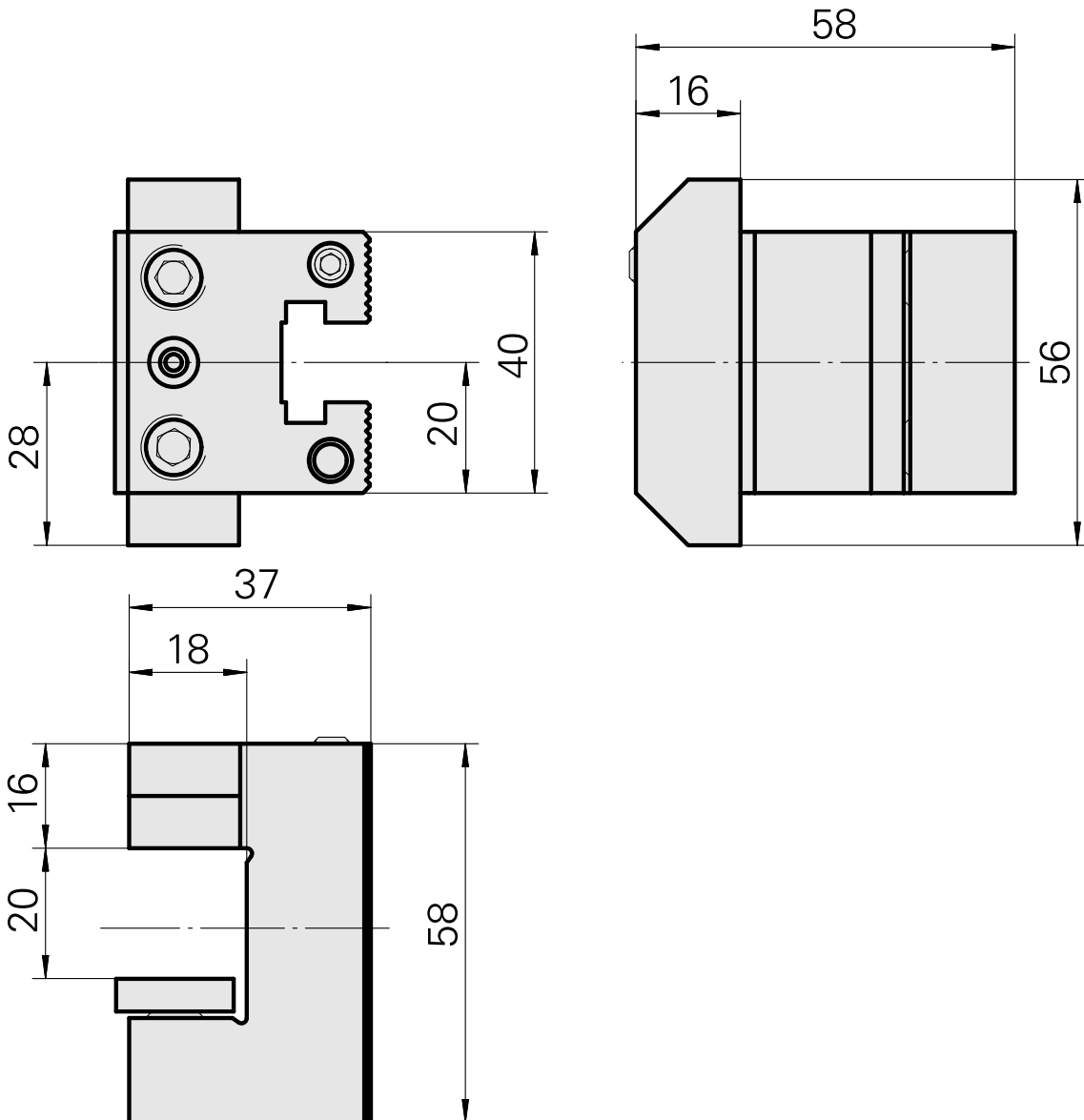
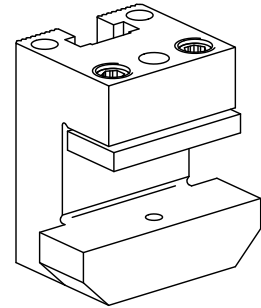

Documents

No downloads available for this product