

Messtasterhalter VDI 25 Renishaw D20

Technical data

Schaft VDI	VDI 25
Antrieb	nicht angetrieben
Fixierung VDI	keine
Aufnahme	Renishaw D20
180° wendbar	nein
X [mm]	25
Y [mm]	–
Z [mm]	–

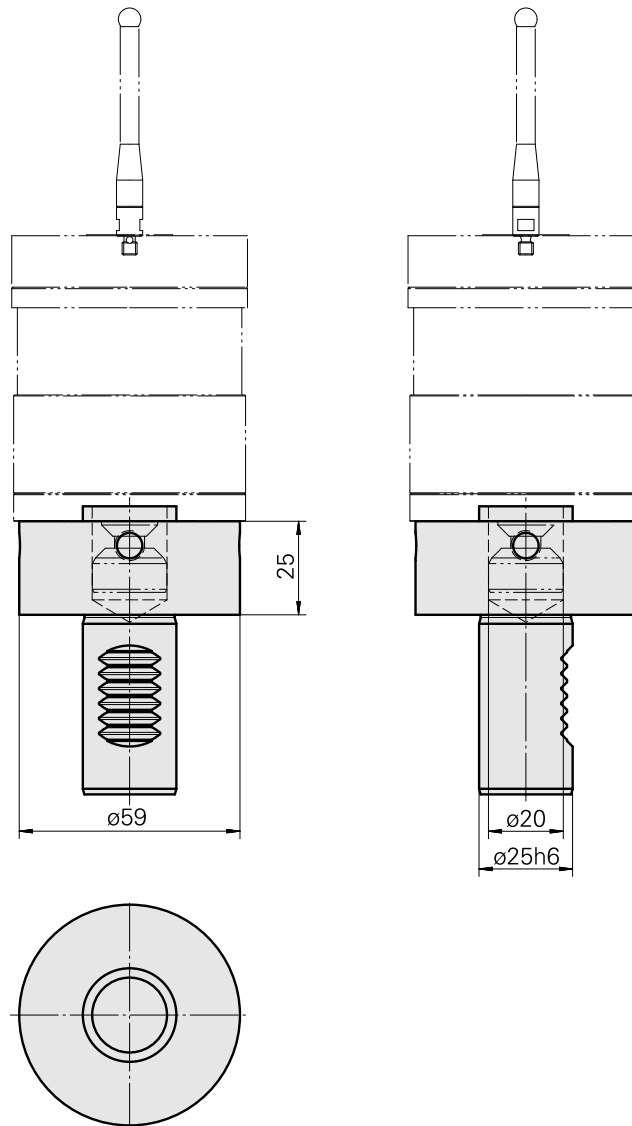
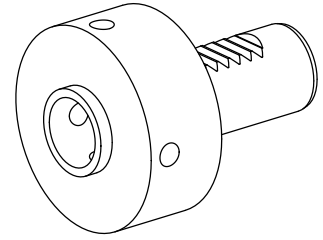

Documents

No downloads available for this product

Accessories

Required for operation

[Messtaster Fa. Renishaw](#)

Product ID : 12146926

Previous product ID :

[Tasteinsätze Fa. Renishaw.](#)

Product ID : 12133466

Previous product ID :

[Probe](#)

Product ID : 10338967

Previous product ID : 487542.1441

Optional accessories

Other accessories

[Case A-2033-7001](#)

Product ID : 10259626

Previous product ID : 487542.0911
