

---

## Change parts

### Technical data

|                             |              |
|-----------------------------|--------------|
| <b>INDEX TRAUB products</b> | TNL32        |
| <b>Spindle clearance</b>    | 32mm         |
| <b>Machining side</b>       | Main spindle |
| <b>Spindle mounting</b>     | Taper 1:4    |
| <b>Clamping device size</b> | 1536E/F37    |

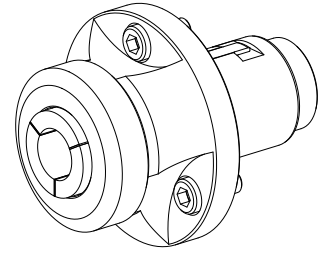

No 3-side view is currently available for this product

11031077  
912231

**INDEX**

---

## **Documents**

No downloads available for this product